

# *Special Meeting Agenda*

## PUBLIC

To be held at McKinlay Shire Council, Boardroom  
29 Burke Street, Julia Creek, Queensland 4823

Thursday April 15<sup>th</sup> 2021, 9:00am

Notice is hereby given that a Special Meeting will be held at the Council Chambers,  
Civic Centre, Julia Creek on Thursday 15<sup>th</sup> April at 9:00am.

## ORDER OF BUSINESS

- |  |   |
|--|---|
| 1. Opening                             | 3 |
| 2. Attendance                          | 3 |
| 3. Declaration of Conflict Of Interest | 3 |

### **4. ITEMS FOR DISCUSSION**

- |  |    |
|--|----|
| 4.1 Award of Sealing and Stabilising works: Truck Park, Cannington Rd, Shaw<br>St and Taldora Rd | 4  |
| 4.2 Award of Contract CN 16068 Components  | 38 |
| 4.3 Award of Tender T2021004 Design and Construct Modular Home Julia Creek                       | 99 |

### **5. CLOSE**

## **1. OPENING BUSINESS**

All Councillors having signed the Attendance Book, the Mayor declared the meeting open.

## **2. ATTENDANCE**

Mayor: Cr. P Curr

Members: Cr. J Fegan, Cr. S Royes, Cr. T Pratt, Cr. J Lynch

### Staff:

Chief Executive Officer, John Kelly

Rates Officer/Acting Executive Assistant, Mrs Katie Woods

Director of Corporate and Community Services, Ms. Tenneil Cody

Director Engineering, Environment and Regulatory Services, Mr. Cameron Scott

### Apologies:

## **3. DECLARATION OF CONFLICT OF INTEREST**

Nil



Special Meeting of Council Thursday 15 April 2021

**4.1 Subject:** Award of Sealing and Stabilising works: Truck Park, Cannington Rd, Shaw St and Taldora Rd

**Attachments:** 4.1.1 RFX Summary Report (*Infoxpert ID: 115280*)  
4.1.2 Tender Submission from RPQ (*Infoxpert ID: 115277*)  
4.1.3 Tender Submission from Stabilised Pavements of Australia (*Infoxpert ID: 115278*)  
4.1.4 Tender Submission from Stabilised Pavements of Australia (*Infoxpert ID: 115279*)  
4.1.5 Tender Submission from Austek Spray Seal (*Infoxpert ID: 115281*)

**Author:** Director Engineering and Regulatory Services

**Date:** 12<sup>th</sup> April 2021

---

### **Executive Summary:**

Council staff sought Vendor panel quotations through Local Buy approved contractors for Sealing and Stabilising works on the Julia Creek Truck Park, Cannington Rd, Shaw St and Taldora Rd. These projects have been approved by Council in the 2020/2021 financial year.

### **Recommendation:**

*That Council resolves to:*

- a. Accept the quotation from Stabilised Pavements Australia dated 24<sup>th</sup> March 2021 for \$1,116,214.36 GST Exclusive for Sealing and Stabilising works on the Julia Creek Truck Park, Cannington Rd, Shaw St and Taldora Rd. These projects have been approved by Council in the 2020/2021 financial year.*

### **Background:**

Stabilising and sealing of the Julia Ck Truck Park is funded through the LRCIP(Local Road and Community Infrastructure Program \$190,000). Cannington Road works are funded through the existing arrangement through South32. Shaw St and Taldora Rd works are funded by DRFA(Disaster Relief Funding Arrangements). Quotations via Vendor Panel were sought from the following LocalBuy prequalified suppliers(BUS-270).

- Austek Spray Seal
- Boral Resources
- Fulton Hogan
- RPQ
- Stabilised Pavements of Australia

Initially 3 quotations were received (Prices are Ex GST):

- Austek Spray Seal \$1,188,697.29 Conforming
- RPQ Non conforming (Stabilising works not lump sum)
- Stabilised Pavements of Australia Non conforming (Stabilising works not lump sum)



Special Meeting of Council Thursday 15 April 2021

RPQ and Stabilised Pavements of Australia were again asked to provide a conforming lump sum pricing of all works.

Stabilised Pavements of Australia provided a conforming price of \$1,116,214.36. RPQ provided another non conforming offer.

It is recommended that Stabilised Pavements of Australia be engaged to undertake the works.

**Consultation:** (internal/External)

Internal; Works Manager

**Legal Implications:**

Nil

**Policy Implications:**

Complies with Procurement policy

**Financial and Resource Implications:**

Works funded through LRCIP, DRFA programs and the Cannington South32 agreement.

**InfoXpert Document ID:**

115276

**Attachments:**

Stabilised Pavements Australia quotations ; RPQ quotations; Austek Spray Seal quotation; Quotation specification



## McKinlay Shire Council

### Request for :

---

#### **Stabilising and Reseal works Julia Creek various locations**

VP reference Number : VP232259

Opens 10/Mar/21 : Closes 19/Mar/21 05:00 PM E. Australia Standard Time

Cut-off date for supplier queries : Friday 19/Mar/21 05:00 PM E. Australia Standard Time

This request is not finalized.

3 Supplier responses as of the 12/Apr/21 02:52 PM

Request created by:

Michael Mcconnell (worksmanager@mckinlay.qld.gov.au)

You have attached 3 documents to this request. You can find them in this zip file under '/RFXDocs/'

[McKinlay Shire Council](#)

## Details of the request

---

### Stabilising and Reseal works Julia Creek various locations

<b>Estimated Value</b>	\$500,000 to 1M (hidden from suppliers)
<b>Budgeted Value</b>	Unknown

### Buyer Details

<b>Business:</b>	McKinlay Shire Council												
<b>Location:</b>	9 Coyne St Julia Creek 4823, Queensland, Australia												
<b>Web Site:</b>	<a href="https://www.mckinlay.qld.gov.au">https://www.mckinlay.qld.gov.au</a>												
<b>Business Overview:</b>	The Council exists to serve the interests of residents within the McKinlay Shire and is often the first point of call for those with a problem or query about local government services.  Our website provides a wealth of community information as well as information about McKinlay and details of town council activities. The site will continue to evolve as we make more information available. Please send us your comments via our contact page.												
<b>Contact:</b>	<table> <tr> <td><i>Contact Name:</i></td> <td>Michael Mcconnell</td> </tr> <tr> <td><i>Position:</i></td> <td>Works Manager</td> </tr> <tr> <td><i>Main Phone:</i></td> <td>0428464001</td> </tr> <tr> <td><i>Mobile Phone:</i></td> <td>None Provided</td> </tr> <tr> <td><i>Email:</i></td> <td>worksmanager@mckinlay.qld.gov.au</td> </tr> <tr> <td><i>Local Group:</i></td> <td>Engineering</td> </tr> </table>	<i>Contact Name:</i>	Michael Mcconnell	<i>Position:</i>	Works Manager	<i>Main Phone:</i>	0428464001	<i>Mobile Phone:</i>	None Provided	<i>Email:</i>	worksmanager@mckinlay.qld.gov.au	<i>Local Group:</i>	Engineering
<i>Contact Name:</i>	Michael Mcconnell												
<i>Position:</i>	Works Manager												
<i>Main Phone:</i>	0428464001												
<i>Mobile Phone:</i>	None Provided												
<i>Email:</i>	worksmanager@mckinlay.qld.gov.au												
<i>Local Group:</i>	Engineering												

### Dates:

<b>Can be responded between:</b>	10/Mar/21 and 19/Mar/21 05:00 PM E. Australia Standard Time
<b>Supplier query cut-off:</b>	Friday 19/Mar/21 05:00 PM (E. Australia Standard Time)
<b>Decision Date:</b>	26/Mar/21

## What's required

All Roads are to be quoted separately.

Traffic Control and TGS are to be included in quote.

Punchbowl rd to be excluded as part of Taldora Rd.

Julia Creek Truck Park – 15,000m2 stabilising ( 2% x 150mm) 15,000m2 Two coat seal ( 14,10mm stone ) Spray Rate ( AMC7 @ 1.6, C170 @ 1.2 )

Cannington Rd – Stabilising ( 2% x 150mm ) Two coat seal ( 14,10mm stone ) Spray Rate ( AMC7 @ 1.6, C170 @ 1.2 )

Cannington Rd – Reseal ( 10mm stone ) Spray Rate ( C170 @ 1.6 )

Shaw St – Stabilising ( 2% x 150mm ) Two coat seal ( 14,10mm stone ) Spray Rate( AMC7 @ 1.6, C170 @ 1.2 )

Taldora Rd – Stabilising ( 2% x 150mm ) Two coat seal ( 14,10mm stone ) Spray Rate( AMC7 @ 1.6, C170 @ 1.2 )

Council to supply gravel for Cannington Rd and Truck Park only.

Council to supply Grader, Rollers and Water trucks for all works.

Quotes to be submitted by 19/03/2021.

Works to commence 19/04/2021

### **The following supplier lists were selected**

1. Road, Water, Sewerage & Civil Works - BUS270 (Type: Pre-Qualified Suppliers, Contract Name/Number: BUS270 (Local Buy))

### **The following categories were selected**

#### **- Road, Water, Sewerage, Civil Works - BUS270**

1. Road Resurfacing

### **Suppliers notified of this request**

- 1 : AUSTEK SPRAY SEAL PTY LTD via Road, Water, Sewerage & Civil Works - BUS270 (has responded)
- 2 : Boral Resources (Qld) Pty Ltd via Road, Water, Sewerage & Civil Works - BUS270
- 3 : Fulton Hogan via Road, Water, Sewerage & Civil Works - BUS270
- 4 : RPQ Spray Seal Pty Ltd via Road, Water, Sewerage & Civil Works - BUS270 (has responded)
- 5 : Stabilised Pavements of Australia Pty Ltd via Road, Water, Sewerage & Civil Works - BUS270 (has responded)

### **Information requested by others**

None...

### **Updates made to this request**

None...



## Response from:

---

Response ID: VPR412673

Created Date: Thursday Thu/Mar/21 01:26 PM

Posted Date: Thursday Thu/Mar/21 01:27 PM

Response reference: None provided

Response via: Road, Water, Sewerage & Civil Works - BUS270

---

**Business:** **AUSTEK SPRAY SEAL PTY LTD**

**ABN** **28 629 433 978**

**Location:** 32 Grice St  
Clontarf  
4019, Queensland, Australia

**Contact:** *Contact Name:* Dean Mcleod  
*Position:* Seal Manager  
*Main Phone:* 0437 002 779  
*Mobile Phone:* None Provided  
*Email:* dean.mcleod@austekroads.com.au

**Web Site:** <https://austekasphalt.com.au/>

**Description:** Spray Seal arm of AUSTEK ASPHALT SERVICES TY LTD.  
Operation out of Clontarf, QLD and servicing many regions  
within Queensland and Northern New South Wales.

**Docs attached by the list  
admin to this supplier:** None...



**Compliance Details:**

*Type:* Product Liability Insurance  
*Policy/Doc #:* Not provided  
*Coverage Value \$:* 20000000  
*Issued by :* Zurich  
*Expiry:* 31/May/21  
*Comments:* Not provided

*Type:* Public Liability Insurance  
*Policy/Doc #:* 43 2242860 LIA  
*Coverage Value \$:* 20000000  
*Issued by :* Zurich  
*Expiry:* 31/May/21  
*Comments:* Not provided

*Type:* Workers Compensation Insurance  
*Policy/Doc #:* WAD150875464  
*Coverage Value \$:* Full  
*Issued by :* Work Cover Queensland  
*Expiry:* 30/Sep/21  
*Comments:* Not provided

*Type:* Workplace Health & Safety (OHS/HSE) Policy  
*Policy/Doc #:* IMS-05.03  
*Coverage Value \$:* Not provided  
*Issued by :* Austek  
*Expiry:* Not applicable  
*Comments:* Not provided

**Selection Status:**

Your decision Undecided

**Your personal notes:**

None added

**Your attachments to this response**

None provided

**Suppliers response:**

Austek Submission

**Supplier provided pricing**

Price EXCLUDING Tax: \$ 1,188,697.29 AUD  
Tax component: \$ 118,869.73 AUD  
TOTAL PRICE: \$ 1,307,567.02 AUD  
These prices are: Fixed  
Comments: Not provided.

## Invoicing Details

If successful, the supplier will invoice with the following details

Business Name: AUSTEK SPRAY SEAL PTY LTD  
Business Number: 28 629 433 978 (ABN)

## Additional Supplier Comments:

Queensland Family Owned Business

## Suppliers Attachments

The supplier has attached 2 documents to this response. You can find them in this zip file under  
'Responses/AUSTEK\_SPRAY\_SEAL\_PT/VPR412673/Response Docs/'

## Response from:

---

Response ID: VPR412686

Created Date: Thursday Thu/Mar/21 01:46 PM

Posted Date: Thursday Thu/Mar/21 01:47 PM

Response reference: None provided

Response via: Road, Water, Sewerage & Civil Works - BUS270

---

**Business:** **Stabilised Pavements of Australia Pty Ltd**  
**Validated Business Name:** STABILISED PAVEMENTS OF AUSTRALIA PTY. LIMITED  
**ABN** **90 002 900 736**  
**Location:** 17 Titanium Pl  
 Mount St John  
 4818, Queensland, Australia

**Contact:** *Contact Name:* Matthew Devine  
*Position:* Regional Engineer  
*Main Phone:* +61 7 4412 0100  
*Mobile Phone:* None Provided  
*Email:* mdevine@stabilis.com.au

**Web Site:** <http://www.stabilisedpavements.com.au/>  
**Description:** We specialise in in situ stabilisation, profiling, civil construction, bitumen sealing & concreting. We have internal design capabilities to help service client's needs

**Docs attached by the list admin to this supplier:** None...

---



### Selection Status:

Your decision Undecided

### Your personal notes:

None added

### Your attachments to this response

None provided

### Suppliers response:

SPA quote T4215

### Supplier provided pricing

Price EXCLUDING Tax:	\$ 729,695.20 AUD
Tax component:	\$ 72,969.52 AUD
<b>TOTAL PRICE:</b>	<b>\$ 802,664.72 AUD</b>

These prices are: Estimated  
Comments: Not provided.

## Invoicing Details

If successful, the supplier will invoice with the following details

Business Name: STABILISED PAVEMENTS OF AUSTRALIA PTY. LIMITED  
Business Number: 90 002 900 736 (ABN)

## Suppliers Attachments

The supplier has attached 1 document to this response. You can find it in this zip file under  
'Responses/Stabilised\_Pavements/VPR412686/Response Docs/'

## Response from:

---

Response ID: VPR413181

Created Date: Friday Fri/Mar/21 04:38 PM

Posted Date: Friday Fri/Mar/21 04:42 PM

Response reference: None provided

Response via: Road, Water, Sewerage & Civil Works - BUS270

---

**Business:** **RPQ Spray Seal Pty Ltd**

**Validated Business Name:** RPQ SPRAY SEAL PTY. LTD.

**ABN** **30 113 612 098**

**Location:** 181 Enterprise St  
Bohle  
4818, Queensland, Australia

**Contact:** *Contact Name:* Susan Meredith  
*Position:* Operations Coordinator  
*Main Phone:* +61 07 4774 4400  
*Mobile Phone:* 0418777152  
*Email:* susan.meredith@rpq.com.au

**Web Site:** <https://www.rpq.com.au>

**Description:** Bitumen & Asphalt Contractor

**Docs attached by the list admin to this supplier:** None...

**Compliance Details:**

<i>Type:</i>	Product Liability Insurance
<i>Policy/Doc #:</i>	1811089-14569
<i>Coverage Value \$:</i>	20,000,000
<i>Issued by :</i>	HDI Global SE, Australia & QBE UK Limited
<i>Expiry:</i>	31/Oct/21
<i>Comments:</i>	Not provided
<i>Type:</i>	Public Liability Insurance
<i>Policy/Doc #:</i>	1811089-14569
<i>Coverage Value \$:</i>	20,000,000
<i>Issued by :</i>	HDI Global SE, Australia & QBE UK Limited
<i>Expiry:</i>	31/Oct/21
<i>Comments:</i>	Not provided
<i>Type:</i>	Workers Compensation Insurance
<i>Policy/Doc #:</i>	WAD080294798
<i>Coverage Value \$:</i>	Not provided
<i>Issued by :</i>	WorkCover Queensland
<i>Expiry:</i>	30/Sep/21
<i>Comments:</i>	Not provided
<i>Type:</i>	Workplace Health & Safety (OHS/HSE) Policy
<i>Policy/Doc #:</i>	Not provided
<i>Coverage Value \$:</i>	Not provided
<i>Issued by :</i>	General Manager
<i>Expiry:</i>	Not applicable
<i>Comments:</i>	Not provided

---

**Selection Status:**

Your decision                      Undecided

**Your personal notes:**

None added

**Your attachments to this response**

None provided

**Suppliers response:**

RPQ Response attached.

Stabiliser etc rates are provided on day rates as council supplying other equipment and operators therefore no program can be provided.

**Supplier provided pricing**

Price EXCLUDING Tax:	\$ 459,393.71 AUD
Tax component:	\$ 45,939.37 AUD
TOTAL PRICE:	\$ 505,333.08 AUD
These prices are:	Estimated
Comments:	Not provided.

**Invoicing Details**

If successful, the supplier will invoice with the following details

Business Name:	RPQ SPRAY SEAL PTY. LTD.
Business Number:	30 113 612 098 (ABN)

**Suppliers Attachments**

The supplier has attached 1 document to this response. You can find it in this zip file under  
'Responses/RPQ\_Spray\_Seal\_Pty\_L/VPR413181/Response Docs/'



# Quotation

Project 21048, Stabilisation and Seal Works - Mckinlay Shire  
McKinlay SC

Project Date: 19 March 2021  
Project Price: \$459,393.71  
GST: \$45,939.37  
Total Price: \$505,333.08

McKinlay Shire Council  
29 Burke Street  
McKinlay 4823

Phone :  
Fax No :  
Client Code : COUNCIL6

**Section: 150, Seal**

Code	Description	Quantity Unit	Rate	Amount	GST	Rate Inc. GST	Amount Inc. GST
<u>Seal Works - 2 Coat 14mm/10mm Seal</u>							
1	Mobilisation seal crew - per visit	1.00 EACH	8,000.00	8,000.00	800.00	8,800.00	8,800.00
<u>Julia Creek Truck Park - 15000m2</u>							
1	14mm AMC7 Seal at 1.6l/m2 and 1m3:90m2	15,000.00 M2	3.99	59,850.00	5,985.00	4.39	65,835.00
2	10mm C170 Seal at 1.2l/m2 and 1m3:135m2	15,000.00 M2	3.14	47,100.00	4,710.00	3.45	51,810.00
<u>Cannington Rd - 10652m2 - 2coat 19157m2 Reseal</u>							
1	14mm AMC7 Seal at 1.6l/m2 and 1m3:90m2	10,652.00 M2	5.22	55,603.44	5,560.34	5.74	61,163.78
2	10mm C170 Seal at 1.2l/m2 and 1m3:135m2	29,809.00 M2	3.13	93,302.17	9,330.22	3.44	102,632.39
<u>Shaw St - 1780m2</u>							
1	14mm AMC7 Seal at 1.6l/m2 and 1m3:90m2	1,780.00 M2	12.74	22,677.20	2,267.72	14.01	24,944.92
2	10mm C170 Seal at 1.2l/m2 and 1m3:135m2	1,780.00 M2	12.38	22,036.40	2,203.64	13.62	24,240.04
<u>Taldora Rd Julia Creek - 14398m2</u>							
1	14mm AMC7 Seal at 1.6l/m2 and 1m3:90m2	14,398.00 M2	4.18	60,183.64	6,018.36	4.60	66,202.00
2	10mm C170 Seal at 1.2l/m2 and 1m3:135m2	14,398.00 M2	3.32	47,801.36	4,780.14	3.65	52,581.50
<u>Stabilisation Works</u>							
	Mobilisation and Demobilisation - Cat RM500 insitu satbilizer, Struemastr 20t spreader truck, Supervisor	1.00 Lump Sum	29,865.00	29,865.00	2,986.50	32,851.50	32,851.50



# Quotation

Infoxpert ID: 115277

Project 21048, Stabilisation and Seal Works - Mckinlay Shire  
McKinlay SC

Project Date: 19 March 2021

Project Price: \$459,393.71

GST: \$45,939.37

Total Price: \$505,333.08

	Supply of Cat RM500 insitu satbilizer, Struemaster 20t spreader truck, Supervisor - day rate	1.00 DAY	8,525.00	8,525.00	852.50	9,377.50	9,377.50
	Supply GB Cement for Julia Creek works	1.00 TONNE	434.50	434.50	43.45	477.95	477.95
	Supply GB Cement for Cannington Rd works	1.00 TONNE	495.00	495.00	49.50	544.50	544.50
	Supply GB Cement for Shaw Rd works	1.00 TONNE	495.00	495.00	49.50	544.50	544.50
	Supply GB Cement for Taldora Rd works	1.00 TONNE	495.00	495.00	49.50	544.50	544.50
1	Provision for traffic per day	1.00 DAY	2,530.00	2,530.00	253.00	2,783.00	2,783.00
<b>Section: 150 Total</b>				<b>459,393.71</b>	<b>45,939.37</b>		<b>505,333.08</b>

**Standard Condition:**

RPQ Group Standard Terms and Conditions

RPQ Group, including but not limited to RPQ Asphalt Pty Ltd, RPQ Spray Seal Pty Ltd, RPQ Services Pty Ltd, Trico Asphalt Pty Ltd, RPQ North Coast Pty Ltd and Rock 'n' Road Bitumen Pty Ltd.

These terms and conditions form part of and are to be read in conjunction with the particulars contained in the Quotation. The Quotation is given by RPQ Group (herein after referred to as RPQ) to the Customer to perform works as specified in the quote and the Customer accepts the quote on the following terms. Where there is a Subcontract Agreement in place between the Customer and RPQ these standard terms and conditions shall form part of the Subcontract Agreement. This RPQ Quotation will also be referenced and listed in the order of precedence of the Subcontract Agreement conditions with the highest level of precedence. If omitted, these RPQ standard terms and conditions will take precedence whether or not it is stated in the Subcontract Agreement.

**1. GENERAL**

1.1 RPQ reserves the right to vary the rates in the Quotation until such time as a site inspection by an RPQ representative or plans are received and the scope of the works are confirmed.

1.2 RPQ shall not be responsible for any maintenance during or after the completion of work, or after the warranty period.

1.3 RPQ shall not be responsible for any property damage caused by carrying out the work unless such damage was caused solely by the negligence of RPQ employees or its agents. RPQ is to be notified within 24 hours of occurrence and confirmed in writing within 7 days of occurrence.

1.4 In the event of any materials supplied or work performed by RPQ being defective, the liability of RPQ, if any, shall be limited to the replacement of such defective material and/or the remediation of such work. All other guarantees, warranties, undertakings, consequential loss or damage or representation expressed or implied whether arising from statute or otherwise are hereby expressly excluded (except to the extent prohibited by law).

1.5 Clerical and Technical errors are subject to correction at any time by RPQ. Without prejudice and reserving RPQ's rights to claim for a variation to the Subcontract Agreement.

1.6 The Customer shall indemnify RPQ against all claims, damages, demands, penalties, costs, charges and expenses, or consequential loss or damage to which RPQ may become partially or wholly liable through any work required to be done by RPQ, or goods and materials to be supplied by RPQ in accordance with the Customer's specifications.

**2. PRICE AND PAYMENT**

2.1 The price stated includes:

2.1.1 Current costs for transport (where specified), labour and materials, including Bitumen, and shall remain valid for 30 days, unless otherwise specified in the quote. Items containing Bitumen are subject to the rise and fall of the RPQ registered suppliers agreed price of Bitumen from the Quotation date to the commencement of the work, based on Department of Main Roads Minor Works Contracts clause B19 Adjustment For The Cost Of Bitumen. RPQ reserves the right to pass on changes in the RPQ registered suppliers agreed price of Bitumen at their own discretion;

2.1.2 The work being carried out during normal working hours Monday to Friday, 7.00am to 5.00pm, unless otherwise specified by RPQ. Work completed outside these hours at the request of the Customer will attract additional charges;

2.1.3 An assumption that all measured areas and project particulars that are supplied by the Customer, are accurate; and the price is subject to variation if any of the above measured areas or project particulars are inaccurate, insufficient or have varied from the date of the Quotation. An agreed quantity for the variations is required to be signed off prior to the commencement of works and a negotiated rate for the variations will be determined between the client and RPQ. RPQ reserves the right not to proceed until a rate for the variation is agreed upon by the Customer.

2.1.4 The quoted rates being subject to change if the scheduled quantity, or the constructed quantity varies by more than 10% of the stated scheduled quantity in the Quotation. Either RPQ or the Customer can request a requote of the relevant items quoted rate.

2.2 The price does not include:

2.2.1 Any additional services not detailed in the Quotation, and the price is subject to variation to take account of changes in any exclusions or additional services requested or deemed necessary by RPQ to undertake the work.

2.2.2 Provision for site specific conditions or allowances, unless otherwise specified.

2.2.3 The cost of inductions for crews, including online inductions, police checks, medicals or ASIC searches with the exception of an onsite induction prior to the commencement of the works of up to twenty (20) minutes. Time in excess of 20 minutes will be charged at \$100.00 per hour per man or part thereof.

2.2.4 Unless otherwise stated, the Customer will be responsible for the cost of all site testing.

2.3 This Quotation is based on the full range of services stated in the Quotation and is not open to acceptance in part, except for any provisional items and rate only items as specified in the quote.

2.4 The Quotation may be in the form of a Lump Sum, a Lump Sum with Unit Rates, or a Schedule of Unit Rates. Unit rates are quoted in accordance with the following:

2.4.1 When a price per unit of weight is stated, the quantity shall be based on weight shown on the delivery docket.

# Quotation

Infoxpert ID: 115277

Project 21048, Stabilisation and Seal Works - Mckinlay Shire  
McKinlay SC

**Project Date:** 19 March 2021

**Project Price:** \$459,393.71

**GST:** \$45,939.37

**Total Price:** \$505,333.08

2.4.2 When a price per cubic metre is stated, the quantity, in the case of bitumen sealing, will be based on the area of work completed divided by the spread rate, in the case of excavation of material, the quantity will be work area completed multiplied by the depth of the cut.

2.4.3 When price per unit of area is stated, the quantity shall be based on the measurement of actual surface area, measured to include grade changes of the completed work.

2.4.4 When a price per unit of length is stated, the quantity shall be based on the measurement of the total length of the work completed, measured to include curves and changes in grade.

2.4.5 For items quoted on number basis, the quantity will be based on the number of items installed or supplied.

2.5 Terms of payment – Unless otherwise stated in the Quotation, electronic payment is required 24 hours prior to commencement of the works, and a credit application is to be completed and accepted by RPQ. All approved account Customers will be invoiced either as a progress claim or at completion of work. All accounts must be paid within thirty (30) days of end of month from date of our official invoice, unless otherwise stated.

2.6 No deductions or retentions whatsoever shall be made by the Customer unless stated in Quotation or Subcontract Agreement and agreed by RPQ.

2.7 RPQ reserve the right to charge interest on any overdue amounts, at a market rate for ANZ Business Loans as listed for the relevant period.

2.8 If required by RPQ, the Customer shall provide a bank guarantee for the Total Price, or in a form acceptable to RPQ

### 3. SPECIFICATIONS

3.1 Unless otherwise stated by RPQ in the project specific conditions, materials and works will comply with Main Roads Specifications MRTS30 or Brisbane City Council S310 - Supply of Dense Grade Asphalt. Materials and Works outside the scope of Main Roads Specifications will be in accordance with the relevant Australian Standard if one is available. Consideration of the Customer Specifications supplied during and subsequent to the Request for Quotation may incur additional costs and unless specifically stated in the Quotation, the additional costs will be charged to the Customer. At the discretion of RPQ it may elect to supply and carry out the works as detailed in the Customer documentation provided to RPQ at, during and subsequent to the tender stage. The final specification to be agreed by the Customer prior to commencement of the works on site.

3.2 Asphalt pavements with falls of 1% or less cannot be considered to have adequate fall to stop water ponding. Where the cross-fall from crown to gully (including invert pavements) is less than or equal to 1%, RPQ will not warrant any work damaged by water ingress or be held responsible for ponding of water on the pavement.

3.3 Site Testing will not be automatically carried out but will only be done if requested by the Customer prior to delivery, or if it is a requirement under the specifications.

3.4 It is agreed by the Customer that RPQ is not responsible for the following:

3.4.1 additional work required to strengthen the subgrade or pavement base unless specifically priced as an item in the Quotation or otherwise specified in the conditions of the quote.

3.4.2 excavation of rock, milling of concrete or other similar hard materials unless otherwise specified in the Quotation.

3.5 Any specific specification required by the Customer in respect of the materials supplied shall be stated in the Quotation and confirmed by RPQ. In respect of Asphalt, unless specified otherwise, the asphalt shall be based on a Class 320 Binder. The Customer shall be liable for any charge arising from a specification requirement or request from the Customer to change the Binder type. Unless specified otherwise, and agreed to in writing, RPQ does not make any claims to a pavements fitness for purpose, including, but not limited to its adequacy to support the intended loads imposed on it, the adequacy of the surface water drainage of the finished works, or the specifications are correct or appropriate for the intended purpose.

3.6 Where survey is required, a model will be provided to RPQ to substantiate the substrate surface. Where survey is not provided, the Customer will be required to sign off on works as completed and accepted as per actual works carried out. RPQ will be paid according to the actual works carried out. Where the Customer elects to provide survey, adequate survey, which may include a design model, level control, as constructed survey to each subsequent layer of asphalt as deemed necessary by RPQ to comply with the relevant Specifications, must be provided. The condition of the subgrade / substrate / base condition will be tested with a water cart and proof rolled. Should the subgrade / substrate / base fail testing and the Customer decide to proceed, a hold point will be signed on the ITP and the warranty will be voided. Unless the site where the works are carried out is a state-controlled road, DTMR warranties, deductions and specifications will not be applicable to the works. Under this circumstance, a limited suite of specification requirements, such as manufacturing specification will be applicable.

3.7 Surface preparation involving cleaning and sweeping (light brooming up to 2 passes only).

### 4. SITE AND ACCESS

4.1 The site conditions at the time of execution of work shall not vary from conditions prevailing at the time of inspection or from conditions agreed to be provided by the Customer.

4.2 Where site access is restricted, site access must be via an all-weather track, of sufficient size for machinery access, unless otherwise stated in the Quotation. No allowance has been made in the quote for construction of access tracks, unless otherwise stated. RPQ shall not be liable for any damage or loss arising as a result of the access failing to support the necessary machinery.

### 5. CANCELLATION, DELIVERY, PROPERTY AND RISK

5.1 RPQ requires adequate notice from the Customer prior to the commencement of the work. The time for required for adequate notice varies though out the year. No guarantee is given by RPQ that work will commence on the date requested or that work will be completed by any particular date. RPQ will not be liable for any loss or damage in any way arising whatsoever as a consequence of RPQ failing to commence work by any particular date, or by failing to complete the work by any particular date.

5.2 If the Customer cancels an order through no fault of RPQ and without giving adequate notice, usually twenty four (24) hours, but not limited to 24 hours when giving consideration to procurement of materials specific to the work, or dispatch times that are adequate to start the work at the programmed start time, we reserve the right to charge the Customer for any expenses incurred.

5.3 Works will only be programmed the day after all regulatory inspections are completed. Should the client request programming of works on the day of inspection, a cancellation fee will apply if unable to proceed with the programmed works

5.4 RPQ reserves the right to withdraw from the quote prior to the commencement of work, with no liability to RPQ of costs incurred by the Customer for any reason.

5.5 Until payment in full, RPQ shall retain legal and equitable title to all materials and other items into which the materials may be incorporated and the Customer hereby authorises RPQ to re-enter onto the site for the purpose of retaking delivery if payment is not made when due.

5.6 Tender of the materials to the work site constitutes delivery of the materials.

5.7 Any risk related to the material, whether in the form of degradation of the material for its intended use, damage to the surrounding environment, or loss, passes to the Customer at the time of delivery of the materials.

5.8 Where unloading of materials is not completed within 20 minutes of arrival at no fault of RPQ, RPQ may, at its own discretion, charge the Customer for waiting time or vehicle hire, in respect of the delay for the additional time to unload the vehicle at a rate determined by RPQ.

### 6. SHORTAGE OF MATERIALS

6.1 RPQ shall not be liable in any manner whatsoever for the delay in delivery or non-delivery (or any costs associated herewith incurred by the Customer) which are attributable to transport delays, unavailability or shortage of materials, plant or equipment breakdown, industrial stoppages or any other cause

Project 21048, Stabilisation and Seal Works - Mckinlay Shire  
McKinlay SC

**Project Date:** 19 March 2021  
**Project Price:** \$459,393.71  
**GST:** \$45,939.37  
**Total Price:** \$505,333.08

whatsoever which is beyond the direct control of RPQ.

7. ASPHALT OPERATIONS (Supplementary terms and conditions but not limited to the following)

7.1 Pavements not constructed by RPQ, which are shaped outside the adjustable limits of the paver, or undulate, or are deeper than the design depth with respect to expected finished levels, cannot be laid to a consistent design depth. This necessitates the use of extra asphalt. The Customer will be liable for this extra asphalt at the quoted rate. Should the quantity used fall outside the quoted quantity by an amount greater than 10% of the quoted quantity, then RPQ or the Customer is entitled to a requote of the item if either party requests a requote.

7.2 Where a rate is provided in the Quotation for typical density of the asphalt, the Customer is to be aware that RPQ will charge the Customer based on the actual compacted density obtained from the laboratory asphalt summary report and agreed quantity sheet.

8. MILLING OPERATIONS (Supplementary terms and conditions but not limited to the following)

8.1 RPQ shall not be liable in any manner whatsoever for damage caused to any services that are not clearly identified on the work site.

8.2 RPQ is not responsible for employing service locating contractors on any work site, and the Customer, in agreeing to these terms and conditions, understands that it is the responsibility of the Customer to locate and mark out any services, or other objects that they could have been reasonably expected to have knowledge of their existence.

8.3 RPQ reserve the right to charge for any damage to machinery or personal injury, or losses incurred if a collision with an object, or service occurs, that is not located by the Customer.

8.4 Unless specified otherwise, milling rates does not include cutting concrete.

8.5 The Customer shall be responsible for the cost of any requirements of the Red Imported Fire Ant (RIFA) legislation. If RPQ have allowed for the removal of spoil off site, then it has been assumed that the material has been inspected and a movement certificate obtained to allow the material to be transported to a site outside of a restricted area.

8.6 RPQ reserves the right to withdraw from works where milling of materials are clogging the drum of the milling machine repeatedly. RPQ will invoice the portion of the work carried out on a pro-rata basis. RPQ will not be held responsible for any consequential loss by the Customer or excavation of the material by any other method.

9. SEALING OPERATIONS (Supplementary terms and conditions but not limited to the following)

9.1 Where the work requires RPQ to supply and stockpile aggregate on site, the Customer is to nominate a suitable, clean and hard stockpile site at no cost to RPQ.

9.2 Where the work requires RPQ to cart aggregate to the work site from a stockpile site, the site must be located within three kilometres of the work site, and RPQ reserve the right to apply additional charges outside cartage outside of three kilometres, unless otherwise specified in the quote

9.3 Where the work requires RPQ to load aggregate from a stockpile site, a site suitable for safe mechanical loading is to be supplied, and RPQ will not be responsible for remediation of the site, or any costs incurred to remediate the site.

9.4 Unless specified otherwise, the Customer is responsible for removing any loose aggregate from the site. Any potential insurance claim due to non-compliance with this clause will be rejected by RPQ and forwarded to the Customer.

9.5 Unless specified otherwise, the Customer is responsible for the erection and maintenance of all warning signs at the work site, including "Windscreen Damage" signs. Any potential insurance claim due to non-compliance with this clause will be rejected by RPQ and forwarded to the Customer.

9.6 The Quotation is based on the seal spray rates as detailed in the relevant schedule of rate item. Any variance to this rate required during the seal design verification process due to site conditions and/or other reasons outside the control of RPQ will be deemed to be a variation to the Subcontract Agreement. For the period ending 30 June 2019, the additional charge for every 0.10L increase per square metre is \$0.10 i.e. tender schedule of rate item nominates 1.2L/m<sup>2</sup> spray rate; design verification process nominates 1.3L/m<sup>2</sup> spray rate; RPQ will claim original tender schedule rate for 1.2L/m<sup>2</sup> spray rate plus an additional \$0.10 due to 0.1L/m<sup>2</sup> increase as per design verification process.

10. WARRANTIES

10.1 All work shall be warranted against defective materials and workmanship for three (3) months from the date of completion, unless specified otherwise in the Quotation.

10.2 Any claim or dispute in relation to the quality of workmanship or materials delivered must be made in writing to RPQ within seven (7) days of identifying the defect.

10.3 Warranty will be voided with respect to reflective cracking occurring in asphalt pavements when the cracking is caused by the underlying pavement courses. Where Bitac Strips are placed over underlying cracked pavements prior to the asphalt overlay, warranty will be voided should reflective cracking occur. Bitac Strip is an industry accepted practice for minimising the occurrence of reflective cracking caused by the underlying pavement cracks.

10.4 Warranty will be voided with respect to damage being caused by overloading of the pavement, spillages or damage, regardless of cause.

10.5 Warranty will be voided with respect to damage being caused by excessive moisture ingress in underlying pavement, regardless of cause.

11. DEFINITIONS

11.1 "Customer" means the entity who has agreed to accept the Quotation, and for the purpose of executing the works, includes the Customer's employees, agents, sub-contractors.

11.2 "Quotation" means a proposal by RPQ to the Customer to carry out "works" for an agreed sum of money with terms and conditions attached.

11.3 "works" or "work" means the whole of the work, including provision of materials, to be carried out and completed in accordance with the Quotation, including variations.

11.4 "work site" or "site" means the lands and other places to be made available, and any other lands and places made available to RPQ by the Customer for the purpose of completing the works in the Quotation.

11.5 "project specific conditions" means conditions by which "works" are to be carried out, as set out in RPQ "Quotation".

11.6 "charge" means a monetary sum applied to the Customer's account or bill.

11.7 "Total Price" means the monetary figure shown in the RPQ Quotation.

11.8 "Request for Quotation" means a request for a proposal by the Customer for RPQ to provide pricing and quantities to carry out "works" for an agreed sum of money with terms and conditions attached.

11.9 "Maintenance" means any works after completion of the quoted Works. The Customer acknowledges that the completed quoted Works will be paid in full and that the RPQ Group have made no allowances for any further costs or retention of funds from the Customer.

11.10 "Rate or Rates" means to the cost per unit stated of an item.

11.11 "Main Roads Specification" or "DTMR" means the current Department of Main Roads Specifications at the time of the Request for Quotation or as specifically stated in the documents supplied in the Request for Quotation.

11.12 "Brisbane City Council Specifications" or "BCCS" means the current Brisbane City Council Specifications at the time of the Request for Quotation or as specifically stated in the documents supplied in the Request for Quotation.

11.13 "Site Testing" means any requirements under the Asphalt or Bitumen Sealing Specification requirements only.

# Quotation

Infoxpert ID: 115277

Project 21048, Stabilisation and Seal Works - Mckinlay Shire  
McKinlay SC

**Project Date:** 19 March 2021  
**Project Price:** \$459,393.71  
**GST:** \$45,939.37  
**Total Price:** \$505,333.08

---

11.14 "Survey" means a general requirement under the relevant specification which is not limited to any design requirements, survey pick-up, computations, survey control (Pavesmart or Pavaset) and set-out, as constructed data as necessary and ride testing.

## QUOTATION ACCEPTANCE FORM

Client Details (Client To Complete)

Entity  
Registered Address  
ABN

I acknowledge that I have read and understand the attached Quote and RPQ's terms and conditions.

(Client To Complete)

Order Number

Expected Commencement of Works

Clients Onsite Manager/Foreman Name

Clients Onsite Manager/Foreman Number

Client Representative Name  
(Quote Approver)

Client Representative Position

Client Representative Contact Number

Client Representative Email

Date

Signature

For programming and acceptance of your quoted works, please contact:

RPQ Representative	Phone	Mobile	Email
Sue Meredith	07 4774 4400	0418 777 152	susan.meredith@rpq.com.au

Thank you for the opportunity to quote on your project.

### Project Specific Condition:

Seal Conditions: Our rates exclude any site based awards or allowances.

Water Cart is not included in this quotation. Rates are based on application of both coats in same visit, with 1 seal visit per road.

Prices subject to rise and fall of bitumen.

Client to provide stock pile locations.

Stabilising :

Rates allow for fair wear and tear of 20 teeth and 2 blocks per shift,

additional teeth will be charges at \$10/tooth and \$68/block.

Cement deliveries based on min 25ton loads. Short loads will incur additional charges. No gravel allowed for in rates.

Standown rate of \$1800/shift applies should works be cancelled - eg inclement weather.

McKinlay Shire Council responsible for intermediate float moves between job sites, however this can be provided on request.

Rates are based on working 7am to 5pm Monday to Saturday.

Cement Prices valid for 90 days from date of quotation. We can provide pricing on 70/30 cement fly ash blend if required.



**STABILISED  
PAVEMENTS  
OF AUSTRALIA**  
PTY LTD  
STRENGTH • FLEXIBILITY

## QUOTATION SUBMISSION

▶ **McKinlay Shire Council**

---

**Cement Stabilisation – Part Service  
Bituminous sealing – Full Service  
Julia Creek various locations**

---

SPA Ref: T4215.1

Date: 24/03/21



Email: worksmanager@mckinlay.qld.gov.au  
 Phone: 0428 464 001  
 Attention: Michael McConnell

RE: Stabilising and Reseal works Julia Creek various locations (VP232259)

We are pleased to quote for the proposed stabilising & sealing works. Unless specified otherwise, this quote and any subsequent work arising from it is subject to our attached terms, conditions and general notes. This quote is valid for 90 days.

#### Stabilising (part service)

Item	Unit	Quantity	Rate	Amount
Julia Creek Truck Park	M2	15,000.0	5.25	78,750.00
Shaw Street, Julia Creek	M2	2,129.5	16.34	34,796.03
Cannington Road	M2	10,651.9	9.14	97,358.37
Taldora Road	M2	14,297.5	23.75	339,565.63
Total (excl GST)				550,470.03
GST (10%)				55,047.00
Total (incl GST)				605,517.03

All quoted rates exclude GST

This stabilising component is provided under the following considerations

- Client to supply: supervision, preparation works (site setout, clearing shoulders for gravel deliveries on applicable roads); service locations; trimming & compaction, water cart(s) & construction water and compliance testing.
- Included in rates: Accommodation & meals, fuel, traffic control (3 person crew), floating of stabiliser between sites, supply of gravel corrector course (nominal 50mm type 2.1) for Shaw St & Taldora Road only, supply of GB cement to suit 150mm, 2% application with a nominal MDD of 2.0t/m<sup>3</sup> to all sites
- Quoted rates based on the above inclusions and assumption that works will progress in line with advise timeframe of Truck Park – 5 days, Shaw Street – 2 days, Cannington Road – 5 days, Taldora Road – 20 days.
  - Additional days to suit client driven production rates to be charged at \$5,700.00 / day (stabiliser & spreader crew) \$2,800.00 / day (3 person traffic control crew), \$550.00 / week for hire of cement site storage
- Binder waiting time (if applicable) will be charged after 1.5 hours at \$195 per hour for delays out of the control of Stabilised Pavements of Australia or due to the works method process.
- Pricing of Binder is subject to rise and fall of both material and transport costs.
- SPA request 2 weeks notification of works commencing but will look to work with client timeframes.
- SPA will not be held liable for customer's costs if additive supply is not available. If binder is supplied by the Client with coordination of deliveries by SPA personnel, there is a charge of \$5.00 / tonne coordination
- Programming of stabilisation plant for during the contract period at the discretion of SPA.
- SPA General Terms and Conditions apply.

### Bitumen Sealing

Description	Unit of Measure	Quantity	Unit Rate (\$)	Amount (\$)
<b>Julia Creek Truck Park</b> S&S AMC7 @ 1.6 L/m <sup>2</sup> , SS&R 14mm @ 100 m <sup>2</sup> /m <sup>3</sup> S&S C170 @ 1.2 L/m <sup>2</sup> , SS&R 10mm @ 140 m <sup>2</sup> /m <sup>3</sup>	M2	15,000	6.48	97,200.00
<b>Shaw Street, Julia Creek</b> S&S AMC7 @ 1.6 L/m <sup>2</sup> , SS&R 14mm @ 100 m <sup>2</sup> /m <sup>3</sup> S&S C170 @ 1.2 L/m <sup>2</sup> , SS&R 10mm @ 140 m <sup>2</sup> /m <sup>3</sup>	M2	2,130	11.49	24,473.70
<b>Cannington Road – stabilised patches</b> S&S AMC7 @ 1.6 L/m <sup>2</sup> , SS&R 14mm @ 100 m <sup>2</sup> /m <sup>3</sup> S&S C170 @ 1.2 L/m <sup>2</sup> , SS&R 10mm @ 140 m <sup>2</sup> /m <sup>3</sup>	M2	10,650	8.38	89,247.00
<b>Cannington Road - reseals</b> S&S C170 @ 1.6 L/m <sup>2</sup> , SS&R 10mm @ 140 m <sup>2</sup> /m <sup>3</sup>	M2	19,160	4.02	77,023.20
<b>Taldora Road – stabilised Patches</b> S&S AMC7 @ 1.6 L/m <sup>2</sup> , SS&R 14mm @ 100 m <sup>2</sup> /m <sup>3</sup> S&S C170 @ 1.2 L/m <sup>2</sup> , SS&R 10mm @ 140 m <sup>2</sup> /m <sup>3</sup>	M2	14,297.5	19.43	277,800.43
Total (excl GST)				565,744.33
GST (10%)				56,574.43
Total (incl GST)				622,318.76

This sealing component is provided under the following considerations

- Client to provide: suitable flat, aggregate on stockpile within 5km of works; prepared pavement; water cart including water for bottom coat;
- Quoted rates based on six (6) visits (1 x Truck Park & Shaw St, 1 x Cannington Road, 4 x Taldora Road). Additional visits to suit client program to be charged at \$8,800.00 / visit (excl GST)
- A single sweep with truck mounted road broom has been allowed. No allowance made for removing swept material from gutters/shoulders/verge areas
- Rates are based on provided patch areas and application rates with allowance for minimal overlapping as required. Should actual quantities vary by greater than 10%; SPA reserve the right to recalculate the quoted rate.
- Supply rates for binder current at time of quoting and subject to rise & fall in line with market fluctuations from 5pm of the date of quote.

Thank you for the opportunity of quoting for this work and we look forward to being of service to you.

Yours faithfully,



**Matt Devine**  
 Engineering Manager, North Queensland  
 Stabilised Pavements of Australia

Accepted by client/contractor:

Name: \_\_\_\_\_

Position: \_\_\_\_\_

Signature: \_\_\_\_\_

Date: \_\_\_\_\_

**Contract**

The documents comprising this contract, in order of precedence, are:

1. SPA Quotation (including any Special Conditions);
2. SPA General Terms and Conditions;
3. Drawings (if applicable);
4. Technical Specifications;
5. Notice of Acceptance
6. Other documents expressly referred to in the Quotation.

**Extent of the Works and Pricing**

This quote is based upon information supplied to Stabilised Pavements of Australia Pty. Limited (SPA) by the Customer prior to submission of quotation. If any details change from the information supplied, SPA reserves the right to review our quotation or rates and invoice accordingly. Where work is to be paid for by a schedule of rates, the following limits of accuracy shall apply to the rates:

- (a) where indicated in the Schedule of Rates as either a  $\pm$  percentage of, or a  $\pm$  number of, the quantity, that percentage or number shall apply; or
- (b) where not indicated on the Schedule of Rates, the limit of accuracy shall be  $\pm$  10% of the quantity stated.
- (c) The limit of accuracy for provisional quantities and provisional sums is  $\pm$  20% of the quantity or sum stated.

Where limits of accuracy are exceeded, SPA reserves the right to ascertain if submission of revised rates and/or sums will apply.

**Validity**

This quotation is valid from a period of 90 days from the date of quotation and is subject to rise and fall of labour, materials and transport costs after this period. This quotation does not allow for any site allowances or job specific conditions outside the relevant SPA enterprise agreement. Any such allowances or conditions would be subject to additional charge under the variations clause of these terms and conditions. The Customers written order to commence work or otherwise the commencement of work by SPA constitutes acceptance of this offer in full.

**Hours of Work**

Unless specified otherwise, this quotation is based on the completion of works being undertaken during normal hours as defined under this clause. In the case whereby works are undertaken outside normal working hours, additional charges may apply under the terms of the variations clause of these terms and conditions. Normal working hours as defined by SPA and these conditions are from 7:00am until 4:30pm Monday to Friday and are exclusive of public holidays. In circumstances where project or site specific rosters are in place, these must be clearly communicated to SPA and agreed upon to ensure inclusion within our quotation.

**Variations**

SPA is not obliged to carry out any variations that are outside the scope of works as defined by the information provided by the Customer to SPA prior to the submission of this quotation. All variations should be issued in writing to SPA prior to commencement of works. Any variation carried out by SPA shall be in accordance with these conditions and at a rate agreed to between SPA and the Customer prior to commencement. In the absence of an agreed rate, any works carried out under the terms of variation shall be charged at a rate as determined by SPA.

**Specifications**

The works are to be carried out in accordance standard industry best practice unless otherwise advised in writing prior to submission of this quotation. In the case where any specifications, drawings or information otherwise is provided after submission of quotation, SPA reserves the right to review our quotation accordingly.

SPA takes no responsibility for the accuracy or suitability of any specifications, drawings or other documents provided by the Customer in relation to the works.

**Underground Services and Obstacles**

All underground services shall be clearly marked on the surface showing locations and depth and advised to the SPA representative before commencement of works. SPA shall not be liable to the Customer for any damage caused to underground services not marked in the above manner. **Damage to plant and equipment due to unmarked obstacles or latent conditions is to be repaired at the cost of the Customer.**

**Postponement, Delays or Cancellation**

SPA reserves the right to charge a fee for costs incurred due to late changes or cancellations including (but not limited to) labour, machinery and materials costs. If not otherwise stated, a stand down charge may be levied for planned but non-production days during programs. Where re-

establishment of labour or some machinery is required in these cases or in cases for holiday periods or extended delays, some or the full establishment fee may still apply. In the event that a non-productive day or days is required for SPA to attend inductions or assist with machinery inspections, daily stand down charges will apply.

**Notices**

All notices must be given to the address shown on our quotation, or to such other address as may be designated in writing by either party to the other. This would be inclusive of electric means such as email.

**Quantity and Acceptance**

Customer acceptance of work to be agreed and signed for on a daily basis. In the event that there is no Customer representative on site then our recorded quantities shall be deemed to be correct whether signed by an authorised Customer representative or otherwise. Further progress of works without written direction otherwise prior to receipt of verification for final acceptance of the stabilised layer is at the Customer's risk.

**Payment Terms**

For existing account holders this quotation is based on full payment within 30 days from the date of the invoice. **Our invoice shall not be subject to any retention monies being held.** Where no account is held, payment terms will be negotiated prior to the commencement of works after credit references are received. Interest of 15% p.a. accruing daily will be charged on overdue accounts.

**Tax**

10% GST will be levied in addition to all quoted rates.

If there is a change in law or a new law relating to the imposition of a tax, duty, impost, levy or other charge (including any carbon type tax or similar) imposed by a government or government agency on, or incurred by, SPA which is attributable in any way to the Goods & services, SPA shall be entitled to increase the price of the Goods by an amount sufficient to offset such imposition.

**Warranty**

A warranty of defects liability period is not applicable unless otherwise written or agreed to in writing prior to acceptance of works. SPA shall not be liable for any failures that are as a result of any portion of the pavement or works that have not been completed by SPA. These may include subgrade, sub base, base course or wearing course dependent on the scope of the works.

**Liability and Indemnity**

Under the conditions of this offer, SPA shall not be liable in any circumstances including:

- i. For any damage to any property located in, or adjacent to the works site as a result of works carried out by SPA in accordance with conditions of this quotation
- ii. For any loss arising from delay during execution of the works including any stand down time incurred by the Customer due to SPA's plant/machinery breakdown or delay in delivery of materials
- iii. For any loss arising from non-conforming product that contains workmanship or materials being installed or placed by others
- iv. For any consequential loss

SPA's liability in all circumstances is limited to the value of the works that any claim may relate to.

**Extension of Time**

SPA may claim an extension of time to the Completion Date (where one is provided in writing) where:

- (a) the Works are delayed by any Excusable Delay and it will prevent SPA from achieving Completion by the Completion Date;
- (b) the Works are not concurrently delayed by a cause that is not an Excusable Delay; and
- (c) the delay was not contributed to by an act or omission of SPA or its Personnel.

**Governing Law and Jurisdiction**

- i. The law of the State or Territory of the Site governs this Contract (Governing Law).
- ii. Each party irrevocably submits to the exclusive jurisdiction of the courts of the Governing Law and courts competent to hear appeals from those courts.
- iii. Neither the Sale of Goods (Vienna Convention) Act 1986 (NSW) (or similar legislation in other Australian jurisdictions) nor any international conventions or recognised customs in relation to rules that may otherwise apply for or in respect to the international sale of goods, have any application to any matter in connection with the Contract.

**Non Legislated WHS Requirements**



Our offer includes provisions for compliance with legislated WHS requirements and associated controls however no allowance has been made for any site, project or contract specific WHS requirements other than those specified during the respective RFQ or Tender Documentation. Any such request beyond a legislated requirement and not communicated through an RFQ or tender documentation will be considered a variation in accordance with the 'Variations' clause of these terms and conditions.

#### Force Majeure

SPA shall not be deemed liable under any circumstance that results in loss or damage, consequential or otherwise, arising from any delay or failure by SPA in meeting its obligation in respect to the works that are outside the control of SPA. Without limiting the generality thereof including restrictions of government or other statutory authorities, wars, riots, civil unrest, fires, storm, flood, earthquake, failure of electrical power supply, road or rail closures, epidemics, accident, labour dispute or materials or labour shortage.

#### Other

- i. Unless otherwise expressly stated, the Customer must at its own expense apply and/or obtain all permits, approvals and licences as required for the works.
- ii. Where applicable, the copyright in all plans, designs, drawings, engineering information, data, reports, accounts and any other material given to the Customer by SPA remains the property of SPA and may only be used by the Customer for the purposes of this contract.
- iii. Where any provision of this contract is void, illegal or unenforceable, it may be severed without affecting the enforceability of the other provisions in this contract.

#### Exclusions

Unless expressly stated in the Special Conditions, work activities excluded from this Quotation are:

- i. Preparation of pavement prior to the execution of agreed scope of works;
- ii. Identification, location and marking/recording of underground services;
- iii. Supply of water and/or water carts;
- iv. Provision of level control and/or survey;
- v. Traffic control;
- vi. Internal float moves;
- vii. Any form of design;
- viii. Any form of testing;
- ix. Provision of wearing course;
- x. Third party VOC for operators;
- xi. Trials;
- xii. Trucks or any other equipment deemed necessary for loading and disposal of spoil;

#### Specific Services

Unless expressly stated in the quotation and /or Special Conditions, the following conditions are applicable for each of our core business activities:

##### Part Service Stabilisation

Compaction, trimming, curing and other item/s not expressly noted in the scope description provided in our quotation has not be allowed for.

Every effort is made to achieve the production rates expected by the Customer. However traffic/site conditions &/or Customer work schedule may be the controlling factors for production output per day. The invoiced amount for operations per day will be based on the higher value of either production achieved or minimum daily operation rate.

Unless otherwise stated, the price of additive (supply and/or transport) is based on the following minimum load sizes. Higher prices apply for smaller loads to account for dead freight costs. It is the responsibility of the Customer to inform SPA of any short loads required prior to quotation otherwise any short loads required will be charged as a variation.

- Cement or cementitious blends 25 tonnes
- Quicklime 24 tonnes
- Hydrated Lime 22 tonnes
- C170 Bitumen 22 tonnes

Delivery is subject to product availability. If applicable, waiting time for supply tankers will be charged at \$195.00 per hour (ex GST) after the first 1.5hrs. **Waiting time or cartage charges for additive deliveries will be applicable due to inclement weather or any other delays caused outside the control of SPA.**

Spreader trucks are custom designed and fitted with load cells to accurately measure the quantity of additive on board. Additive will be spread to achieve the required spread rate with +/- 10% tolerance for

cement and/or lime blends.

Australian Standards, NSW WorkCover and other organisations have advised ROPS may not be required for Reclaimer/Stabiliser mixing plant if a Risk Assessment is conducted. While many SPA stabilisers are fitted with ROPS, some are not. It is the responsibility of the Customer to advise SPA if a stabiliser fitted with ROPS is required for their site conditions. It may be necessary for SPA to charge higher establishment for a ROPS fitted stabiliser.

The material to be stabilised should be such that none has a dimension greater than 75mm and 95% would pass a 50mm sieve. Material outside this requirement may result in damage to the reclaimer/stabiliser with such costs to be incurred by the Customer.

SPA are to be informed if the bitumen seal or asphalt layer thickness to be incorporated exceeds 60 mm, if pavement has been previously cement treated or is a bound pavement of any nature. SPA recommends such pavements be pulverised with a milling machine prior to stabilisation works.

**Excessive teeth and block wear i.e. more than 30 teeth and 2 blocks per day will be charged to the customer at a rate of \$9 per tooth and \$75 per block (ex GST).** Excessive wear can be a result of oversize material, bound layers/asphalt, abrasive materials (e.g. sand) or other latent causes.

SPA provides pavement and mix design proposals for costing purposes. Where testing for mix designs is carried out it is done by NATA Registered Laboratories. The Customer should satisfy themselves that the final design is suitable for their requirements. Certified pavement designs by external engineers can be arranged at cost.

##### Profiling

Unless expressly stated in the quotation and /or Special Conditions, provision of clean up (bobcat and broom), provision of stockpile site/s for profiled materials and profiling of rock/concrete or any other similar hard material/s has not been allowed for.

There will be no charge for wet weather if notified with a minimum of 2 hours before commencement of work, otherwise the stand-down rate will apply.

##### Spray Sealing

Unless expressly stated in the quotation and /or Special Conditions, cleaning of fixed structures such as kerb and guttering, removal of loose aggregate from site and erection/maintenance of warning signs has not been allowed for.

##### Storage of Materials

- i. Where the works require SPA to supply aggregate, the Customer is to supply a suitable, clean, hard stockpile site at no cost to SPA.
- ii. Where the Works involve SPA loading, hauling or spreading aggregate, the Customer is to provide an aggregate stockpile site suitable for mechanical loading within 3 kilometres of the Site. If the aggregate stockpile site is more than 3 kilometres from the Site, the Customer is to pay any excess haulage costs incurred by SPA at SPA's ruling rate.

##### Excess Materials

- iii. Where the Works comprise the supply and delivery of materials only, the Customer is to pay for any returned materials at SPA's ruling rate. The Customer is to pay the costs of transporting any excess materials from the Site to SPA's depot at SPA's ruling rate.

##### Demurrage and Cancellation

Based on transportation distances for binder and aggregate transport, customers should be aware of the lead times required for orders and the potential impacts of cancellations or postponed works. Any costs associated with the cancellation or postponement of works that result in demurrage or delay costs will be managed in accordance with SPA Quotation Terms and Conditions with reference to clause 'Postponement and Cancellation'.



**STABILISED  
PAVEMENTS  
OF AUSTRALIA**  
PTY LTD  
STRENGTH • FLEXIBILITY

## QUOTATION SUBMISSION

▶ **McKinlay Shire Council**

---

**Cement Stabilisation – Part Service  
Bituminous sealing – Full Service  
Julia Creek various locations**

---

SPA Ref: T4215

Date: 18/03/21



Email: worksmanager@mckinlay.qld.gov.au  
 Phone: 0428 464 001  
 Attention: Michael McConnell

RE: Stabilising and Reseal works Julia Creek various locations (VP232259)

We are pleased to quote for the proposed stabilising & sealing works. Unless specified otherwise, this quote and any subsequent work arising from it is subject to our attached terms, conditions and general notes. This quote is valid for 90 days.

### Stabilising (part service)

#### **Mobilisation**

Establish/Disestablish a stabiliser/reclaimer with 2.4m wide mixing drum and a spreader including 2 x operators to Julia Creek

Establishment **\$6,000.00 / each**

Disestablishment **\$5,600.00 / each**

#### **Stabilisation**

Spread cement (nominal 2% by mass for a compacted layer of 150mm) and mix at depths of up to 200mm per pass in a minimum two pass mixing process while incorporating moisture as directed on the final pass

Stabiliser & Spreader incl 2 operators **\$4,700.00 / day**

#### **Binder Supply**

Supply of stabilising agents in bulk tankers to pump directly into spreader truck and site storage. Site storage to be based within 10km of works

GB Cement – Cannington Road (min 34 tonne loads) **\$369.50 / tonne**

GB Cement – Julia Creek (min 33 tonne loads) **\$330.00 / tonne**

GB Cement – Taldora Road (min 30 tonne loads) **\$344.50 / tonne**

ISO & Blower on trailer **\$545.00 / week**

ISO relocation between sites **\$190.00 / hour**

#### **Miscellaneous**

Stand down (2 person crew) **\$1,500.00 / day**

Foreman to manage stabilisation process (if requested) **\$1,000.00 / day**

Stabilisation GET

GET – Teeth (after 20 free per day) **\$9.00 / each**

GET – Blocks (after 2 free per day) **\$75.00 / each**

All quoted rates exclude GST

This stabilising component is provided under the following considerations

- Client to supply: all preparation works (earthworks, etc); traffic management; service locations; trimming & compaction, water cart(s) & construction water and compliance testing.
- Included in rates: Accommodation & meals, fuel
- Stand down rate to apply on non-working weekdays (M-F) when crew in McKinlay Shire, for days when works planned but cancelled and for travel days for shift breaks around council RDO etc
- Binder waiting time (if applicable) will be charged after 1.5 hours at \$195 per hour for delays out of the control of Stabilised Pavements of Australia or due to the works method process.
- Pricing of Binder is subject to rise and fall of both material and transport costs.
- SPA request 2 weeks notification of works commencing but will look to work with client timeframes.
- SPA will not be held liable for customer's costs if additive supply is not available. If binder is supplied by the Client with coordination of deliveries by SPA personnel, there is a charge of \$5.00 / tonne coordination
- Programming of stabilisation plant for during the contract period at the discretion of SPA.
- SPA General Terms and Conditions apply.

**Bitumen Sealing**

Description	Unit of Measure	Quantity	Unit Rate (\$)	Amount (\$)
<b>Julia Creek Truck Park</b> S&S AMC7 @ 1.6 L/m <sup>2</sup> , SS&R 14mm @ 100 m <sup>2</sup> /m <sup>3</sup> S&S C170 @ 1.2 L/m <sup>2</sup> , SS&R 10mm @ 140 m <sup>2</sup> /m <sup>3</sup>	M2	15,000	6.41	96,150.00
<b>Shaw Street, Julia Creek</b> S&S AMC7 @ 1.6 L/m <sup>2</sup> , SS&R 14mm @ 100 m <sup>2</sup> /m <sup>3</sup> S&S C170 @ 1.2 L/m <sup>2</sup> , SS&R 10mm @ 140 m <sup>2</sup> /m <sup>3</sup>	M2	2,130	11.42	24,324.60
<b>Cannington Road – stabilised patches</b> S&S AMC7 @ 1.6 L/m <sup>2</sup> , SS&R 14mm @ 100 m <sup>2</sup> /m <sup>3</sup> S&S C170 @ 1.2 L/m <sup>2</sup> , SS&R 10mm @ 140 m <sup>2</sup> /m <sup>3</sup>	M2	10,650	7.76	82,644.00
<b>Cannington Road - reseals</b> S&S C170 @ 1.6 L/m <sup>2</sup> , SS&R 10mm @ 140 m <sup>2</sup> /m <sup>3</sup>	M2	19,160	4.01	76,831.60
<b>Taldora Road – stabilised Patches</b> S&S AMC7 @ 1.6 L/m <sup>2</sup> , SS&R 14mm @ 100 m <sup>2</sup> /m <sup>3</sup> S&S C170 @ 1.2 L/m <sup>2</sup> , SS&R 10mm @ 140 m <sup>2</sup> /m <sup>3</sup>	M2	14,400	14.50	208,800.00
Total (excl GST)				488,750.20
GST (10%)				48,875.02
Total (incl GST)				537,625.22

This sealing component is provided under the following considerations

- Client to provide: suitable flat, aggregate on stockpile within 5km of works; prepared pavement; water cart including water for bottom coat;
- Quoted rates based on one (3) visits (1 x Truck Park & Shaw St, 1 x Cannington Road, 1 x Taldora Road). Additional visits to suit client program to be charged at \$8,800.00 / visit (excl GST)
- A single sweep with truck mounted road broom has been allowed. No allowance made for removing swept material from gutters/shoulders/verge areas
- Rates are based on provided areas and application rates. Should actual quantities vary by greater than 10%; SPA reserve the right to recalculate the quoted rate.
- Supply rates for binder current at time of quoting and subject to rise & fall in line with market fluctuations from 5pm of the date of quote.

Thank you for the opportunity of quoting for this work and we look forward to being of service to you.

Yours faithfully,



**Matt Devine**  
Engineering Manager, North Queensland  
Stabilised Pavements of Australia

Accepted by client/contractor:

Name: \_\_\_\_\_

Position: \_\_\_\_\_

Signature: \_\_\_\_\_

Date: \_\_\_\_\_

**Contract**

The documents comprising this contract, in order of precedence, are:

1. SPA Quotation (including any Special Conditions);
2. SPA General Terms and Conditions;
3. Drawings (if applicable);
4. Technical Specifications;
5. Notice of Acceptance
6. Other documents expressly referred to in the Quotation.

**Extent of the Works and Pricing**

This quote is based upon information supplied to Stabilised Pavements of Australia Pty. Limited (SPA) by the Customer prior to submission of quotation. If any details change from the information supplied, SPA reserves the right to review our quotation or rates and invoice accordingly. Where work is to be paid for by a schedule of rates, the following limits of accuracy shall apply to the rates:

- (a) where indicated in the Schedule of Rates as either a  $\pm$  percentage of, or a  $\pm$  number of, the quantity, that percentage or number shall apply; or
- (b) where not indicated on the Schedule of Rates, the limit of accuracy shall be  $\pm$  10% of the quantity stated.
- (c) The limit of accuracy for provisional quantities and provisional sums is  $\pm$  20% of the quantity or sum stated.

Where limits of accuracy are exceeded, SPA reserves the right to ascertain if submission of revised rates and/or sums will apply.

**Validity**

This quotation is valid from a period of 90 days from the date of quotation and is subject to rise and fall of labour, materials and transport costs after this period. This quotation does not allow for any site allowances or job specific conditions outside the relevant SPA enterprise agreement. Any such allowances or conditions would be subject to additional charge under the variations clause of these terms and conditions. The Customers written order to commence work or otherwise the commencement of work by SPA constitutes acceptance of this offer in full.

**Hours of Work**

Unless specified otherwise, this quotation is based on the completion of works being undertaken during normal hours as defined under this clause. In the case whereby works are undertaken outside normal working hours, additional charges may apply under the terms of the variations clause of these terms and conditions. Normal working hours as defined by SPA and these conditions are from 7:00am until 4:30pm Monday to Friday and are exclusive of public holidays. In circumstances where project or site specific rosters are in place, these must be clearly communicated to SPA and agreed upon to ensure inclusion within our quotation.

**Variations**

SPA is not obliged to carry out any variations that are outside the scope of works as defined by the information provided by the Customer to SPA prior to the submission of this quotation. All variations should be issued in writing to SPA prior to commencement of works. Any variation carried out by SPA shall be in accordance with these conditions and at a rate agreed to between SPA and the Customer prior to commencement. In the absence of an agreed rate, any works carried out under the terms of variation shall be charged at a rate as determined by SPA.

**Specifications**

The works are to be carried out in accordance standard industry best practice unless otherwise advised in writing prior to submission of this quotation. In the case where any specifications, drawings or information otherwise is provided after submission of quotation, SPA reserves the right to review our quotation accordingly.

SPA takes no responsibility for the accuracy or suitability of any specifications, drawings or other documents provided by the Customer in relation to the works.

**Underground Services and Obstacles**

All underground services shall be clearly marked on the surface showing locations and depth and advised to the SPA representative before commencement of works. SPA shall not be liable to the Customer for any damage caused to underground services not marked in the above manner. **Damage to plant and equipment due to unmarked obstacles or latent conditions is to be repaired at the cost of the Customer.**

**Postponement, Delays or Cancellation**

SPA reserves the right to charge a fee for costs incurred due to late changes or cancellations including (but not limited to) labour, machinery and materials costs. If not otherwise stated, a stand down charge may be levied for planned but non-production days during programs. Where re-

establishment of labour or some machinery is required in these cases or in cases for holiday periods or extended delays, some or the full establishment fee may still apply. In the event that a non-productive day or days is required for SPA to attend inductions or assist with machinery inspections, daily stand down charges will apply.

**Notices**

All notices must be given to the address shown on our quotation, or to such other address as may be designated in writing by either party to the other. This would be inclusive of electric means such as email.

**Quantity and Acceptance**

Customer acceptance of work to be agreed and signed for on a daily basis. In the event that there is no Customer representative on site then our recorded quantities shall be deemed to be correct whether signed by an authorised Customer representative or otherwise. Further progress of works without written direction otherwise prior to receipt of verification for final acceptance of the stabilised layer is at the Customer's risk.

**Payment Terms**

For existing account holders this quotation is based on full payment within 30 days from the date of the invoice. **Our invoice shall not be subject to any retention monies being held.** Where no account is held, payment terms will be negotiated prior to the commencement of works after credit references are received. Interest of 15% p.a. accruing daily will be charged on overdue accounts.

**Tax**

10% GST will be levied in addition to all quoted rates.

If there is a change in law or a new law relating to the imposition of a tax, duty, impost, levy or other charge (including any carbon type tax or similar) imposed by a government or government agency on, or incurred by, SPA which is attributable in any way to the Goods & services, SPA shall be entitled to increase the price of the Goods by an amount sufficient to offset such imposition.

**Warranty**

A warranty of defects liability period is not applicable unless otherwise written or agreed to in writing prior to acceptance of works. SPA shall not be liable for any failures that are as a result of any portion of the pavement or works that have not been completed by SPA. These may include subgrade, sub base, base course or wearing course dependent on the scope of the works.

**Liability and Indemnity**

Under the conditions of this offer, SPA shall not be liable in any circumstances including:

- i. For any damage to any property located in, or adjacent to the works site as a result of works carried out by SPA in accordance with conditions of this quotation
- ii. For any loss arising from delay during execution of the works including any stand down time incurred by the Customer due to SPA's plant/machinery breakdown or delay in delivery of materials
- iii. For any loss arising from non-conforming product that contains workmanship or materials being installed or placed by others
- iv. For any consequential loss

SPA's liability in all circumstances is limited to the value of the works that any claim may relate to.

**Extension of Time**

SPA may claim an extension of time to the Completion Date (where one is provided in writing) where:

- (a) the Works are delayed by any Excusable Delay and it will prevent SPA from achieving Completion by the Completion Date;
- (b) the Works are not concurrently delayed by a cause that is not an Excusable Delay; and
- (c) the delay was not contributed to by an act or omission of SPA or its Personnel.

**Governing Law and Jurisdiction**

- i. The law of the State or Territory of the Site governs this Contract (Governing Law).
- ii. Each party irrevocably submits to the exclusive jurisdiction of the courts of the Governing Law and courts competent to hear appeals from those courts.
- iii. Neither the Sale of Goods (Vienna Convention) Act 1986 (NSW) (or similar legislation in other Australian jurisdictions) nor any international conventions or recognised customs in relation to rules that may otherwise apply for or in respect to the international sale of goods, have any application to any matter in connection with the Contract.

**Non Legislated WHS Requirements**

Our offer includes provisions for compliance with legislated WHS requirements and associated controls however no allowance has been made for any site, project or contract specific WHS requirements other than those specified during the respective RFQ or Tender Documentation. Any such request beyond a legislated requirement and not communicated through an RFQ or tender documentation will be considered a variation in accordance with the 'Variations' clause of these terms and conditions.

#### Force Majeure

SPA shall not be deemed liable under any circumstance that results in loss or damage, consequential or otherwise, arising from any delay or failure by SPA in meeting its obligation in respect to the works that are outside the control of SPA. Without limiting the generality thereof including restrictions of government or other statutory authorities, wars, riots, civil unrest, fires, storm, flood, earthquake, failure of electrical power supply, road or rail closures, epidemics, accident, labour dispute or materials or labour shortage.

#### Other

- i. Unless otherwise expressly stated, the Customer must at its own expense apply and/or obtain all permits, approvals and licences as required for the works.
- ii. Where applicable, the copyright in all plans, designs, drawings, engineering information, data, reports, accounts and any other material given to the Customer by SPA remains the property of SPA and may only be used by the Customer for the purposes of this contract.
- iii. Where any provision of this contract is void, illegal or unenforceable, it may be severed without affecting the enforceability of the other provisions in this contract.

#### Exclusions

Unless expressly stated in the Special Conditions, work activities excluded from this Quotation are:

- i. Preparation of pavement prior to the execution of agreed scope of works;
- ii. Identification, location and marking/recording of underground services;
- iii. Supply of water and/or water carts;
- iv. Provision of level control and/or survey;
- v. Traffic control;
- vi. Internal float moves;
- vii. Any form of design;
- viii. Any form of testing;
- ix. Provision of wearing course;
- x. Third party VOC for operators;
- xi. Trials;
- xii. Trucks or any other equipment deemed necessary for loading and disposal of spoil;

#### Specific Services

Unless expressly stated in the quotation and /or Special Conditions, the following conditions are applicable for each of our core business activities:

##### Part Service Stabilisation

Compaction, trimming, curing and other item/s not expressly noted in the scope description provided in our quotation has not be allowed for.

Every effort is made to achieve the production rates expected by the Customer. However traffic/site conditions &/or Customer work schedule may be the controlling factors for production output per day. The invoiced amount for operations per day will be based on the higher value of either production achieved or minimum daily operation rate.

Unless otherwise stated, the price of additive (supply and/or transport) is based on the following minimum load sizes. Higher prices apply for smaller loads to account for dead freight costs. It is the responsibility of the Customer to inform SPA of any short loads required prior to quotation otherwise any short loads required will be charged as a variation.

- Cement or cementitious blends 25 tonnes
- Quicklime 24 tonnes
- Hydrated Lime 22 tonnes
- C1.70 Bitumen 22 tonnes

Delivery is subject to product availability. If applicable, waiting time for supply tankers will be charged at \$195.00 per hour (ex GST) after the first 1.5hrs. **Waiting time or cartage charges for additive deliveries will be applicable due to inclement weather or any other delays caused outside the control of SPA.**

Spreader trucks are custom designed and fitted with load cells to accurately measure the quantity of additive on board. Additive will be spread to achieve the required spread rate with +/- 10% tolerance for

cement and/or lime blends.

Australian Standards, NSW WorkCover and other organisations have advised ROPS may not be required for Reclaimer/Stabiliser mixing plant if a Risk Assessment is conducted. While many SPA stabilisers are fitted with ROPS, some are not. It is the responsibility of the Customer to advise SPA if a stabiliser fitted with ROPS is required for their site conditions. It may be necessary for SPA to charge higher establishment for a ROPS fitted stabiliser.

The material to be stabilised should be such that none has a dimension greater than 75mm and 95% would pass a 50mm sieve. Material outside this requirement may result in damage to the reclaimer/stabiliser with such costs to be incurred by the Customer.

SPA are to be informed if the bitumen seal or asphalt layer thickness to be incorporated exceeds 60 mm, if pavement has been previously cement treated or is a bound pavement of any nature. SPA recommends such pavements be pulverised with a milling machine prior to stabilisation works.

**Excessive teeth and block wear i.e. more than 30 teeth and 2 blocks per day will be charged to the customer at a rate of \$9 per tooth and \$75 per block (ex GST).** Excessive wear can be a result of oversize material, bound layers/asphalt, abrasive materials (e.g. sand) or other latent causes.

SPA provides pavement and mix design proposals for costing purposes. Where testing for mix designs is carried out it is done by NATA Registered Laboratories. The Customer should satisfy themselves that the final design is suitable for their requirements. Certified pavement designs by external engineers can be arranged at cost.

##### Profiling

Unless expressly stated in the quotation and /or Special Conditions, provision of clean up (bobcat and broom), provision of stockpile site/s for profiled materials and profiling of rock/concrete or any other similar hard material/s has not been allowed for.

There will be no charge for wet weather if notified with a minimum of 2 hours before commencement of work, otherwise the stand-down rate will apply.

##### Spray Sealing

Unless expressly stated in the quotation and /or Special Conditions, cleaning of fixed structures such as kerb and guttering, removal of loose aggregate from site and erection/maintenance of warning signs has not been allowed for.

##### Storage of Materials

- i. Where the works require SPA to supply aggregate, the Customer is to supply a suitable, clean, hard stockpile site at no cost to SPA.
- ii. Where the Works involve SPA loading, hauling or spreading aggregate, the Customer is to provide an aggregate stockpile site suitable for mechanical loading within 3 kilometres of the Site. If the aggregate stockpile site is more than 3 kilometres from the Site, the Customer is to pay any excess haulage costs incurred by SPA at SPA's ruling rate.

##### Excess Materials

- iii. Where the Works comprise the supply and delivery of materials only, the Customer is to pay for any returned materials at SPA's ruling rate. The Customer is to pay the costs of transporting any excess materials from the Site to SPA's depot at SPA's ruling rate.

##### Demurrage and Cancellation

Based on transportation distances for binder and aggregate transport, customers should be aware of the lead times required for orders and the potential impacts of cancellations or postponed works. Any costs associated with the cancellation or postponement of works that result in demurrage or delay costs will be managed in accordance with SPA Quotation Terms and Conditions with reference to clause 'Postponement and Cancellation'.



McKinlay Shire Council

18<sup>th</sup> March 2021

**Re: Various stabilising and Sealing works, McKinlay Shire Council**

Dear Michael,

Please find our attached Tender submission for **Various stabilising and Sealing works, McKinlay Shire Council** as per your request. Please note the following:

**We believe we have allowed for all contingencies within our quote, please note the allotted days allowed for each Stabilising location, Days in excess of the allotted days will incur the cost rate for the Stabilising crew including Traffic Control.**

**The Austek Group is a growing Privately-Owned Queensland Pavement Surfacing business with a highly trained and diversified workforce that employs locally based employees. All products and services are sourced from within Queensland, all profits stay in Queensland.**

We are proposing to source product and services in the McKinlay Shire Council region to supply associated services such as Traffic Control, Accommodation, Mechanical services and Fuel.

We have the capability to establish and undertake this work as required and have an excellent record supplying this council with the products and services outlined in this request.

The Austek Group of companies has been established for over 10 years and has been involved in Civil, Asphalt and Bitumen sealing works for this period.

Should you require any further clarification of the attached please contact me on 0437 002 779

Regards

A handwritten signature in black ink, appearing to read "Dean McLeod", with a long horizontal flourish extending to the right.

Dean McLeod  
Regional Manager – Spray Seal & Asphalt

18<sup>th</sup> March 2021

SS-2021-049

McKinlay Shire Council

Attention: **Michael McConnell**

### Quotation – Various Stabilising & Sealing – McKinlay Shire

Thank you for the opportunity to quote on the abovementioned works. Please see below the schedule of rates for each location and item. All item quantities are estimates only and may vary slightly if there are any unforeseen issues surrounding some of the removal items.

**Scope of works: Sealing works**

**Drawings: As per quote request**

ID	Description	UOM	QUANT.	Rate	Value (gst exc)
01 Julia Creek Truck Park	Stabilising (2% * 150mm) allowing for 4 days	LS	1	\$85,305.77	\$85,305.77
01 Julia Creek Truck Park	2 Coat Seal 14/10	M2	15000	\$9.37	\$140,550.00
02 Shaw Street	Stabilising (2% * 150mm) allowing for 2 days - includes supply of 2.1 Gravel	LS	1	\$47,468.76	\$47,468.76
02 Shaw Street	2 Coat Seal 14/10	M2	2070	\$18.10	\$37,467.00
03 Cannington Road	Stabilising (2% * 150mm) allowing for 5 days	LS	1	\$94,078.68	\$94,078.68

Austek Spray Seal PTY LTD  
 ABN 28 629 433 978  
 Phone (07) 3496 2549



03 Cannington Road	2 Coat Seal 14/10	M2	10652	\$11.67	\$124,308.84
04 Taldora Road	Stabilising (2% * 150mm) allowing for 17 days- includes supply of 2.1 Gravel	LS	1	\$380,551.06	\$380,551.06
04 Taldora Road	2 Coat Seal 14/10	M2	14397	\$11.02	\$158,654.94
05 Cannington Road Reseal	1 Coat Seal 10	M2	19158	\$6.28	\$120,312.24
Total					\$1,188,697.29

**Project Specific Conditions: Spray Sealing**

Water Cart have not been allowed for in quotation.

1 Seal establishment has been allowed for in Quote

**Project Specific Conditions: Stabilising**

Prices include Machinery Day Rates, Cement FAB Powder delivery and storage,

Operators, Fuel, Accommodation and Food.

Stabiliser GET are at an additional charge of per pick \$ 9.00+GST and Adaptor

\$85.00+GST.

Stand Down Rate for machines will be at 50% of Day Rate charge.

Allowance in pricing for inter patch mobilisations for the proposed sequence of works.

Any changes or extra Mobilisations will incur extra cost.

Allowance for 28 Days of Stabilisation. Any extra days will incur a Day Rate charge of

\$11,255.00 + GST per day – This covers all Stabilising and Traffic Control activities.

Operator Travel charges will be at \$65.00+GST per hour travelled.

No allowance within quote for site preparation, forming or compaction of road before or

after the Stabilisation process or locating of services

Austek Spray Seal PTY LTD

ABN 28 629 433 978

Phone (07) 3496 2549

**No allowance for the laying out of the corrector gravel layer.**

**Allowance for Gravel to be supplied to the patches on Shaw Street and Taldora Road**

**only.**

**Client to supply Moisture Controller behind Stabiliser.**

1. Our quotation is based on the information supplied by the client at the time of this submission. It is the client's responsibility that the information supplied is correct and reflective of actual conditions and requirements on site. 2. Traffic control and/or police attendance is not included in the above rates unless specifically noted otherwise. 3. Rates assume the use of our normal suite of spray seal & asphalt placement equipment, including tip trucks, in any work areas. Should the works preclude the use of our normal equipment, we reserve the right to re-price those sections of work. 4. Our submitted rates are based on standard Day Shift 6am to 5pm Monday to Friday. 5. Should the quantities vary by more than 10% from those stated in the schedule, Austek Asphalt Services reserves the right to revisit and / or reprice the scheduled rates supplied. 6. The quoted rates are based on our nominated Asphalt Design for this project. Should the actual Design differ from those stated for any reason; our submitted rates will require revision.

#### **VISITS**

9. Item has been removed. 10. Item has been removed. 11. Item has been removed. 12. Rates do allow for inductions. 13. Our rates assume that the client provides safe access and egress from the work site. (i.e. if TC is required for a safe access the site the PC will provide this and not cost to Austek Asphalt Services). 14. Item has been removed. 15. Item has been removed. 16. All materials supplied and Works performed by Austek Asphalt Services will comply with the Customer's specifications and if no specifications relative to the materials or Works are in place, Austek Asphalt Services will supply materials or perform the Works in accordance with Austek Asphalt Services current specification applicable to the type of materials or Works. Austek Asphalt Services does not take responsibility for pavement design and the client is required to notify Austek Asphalt Services in writing if they do not wish to proceed with the specifications quoted prior to commencement of works. 17. Item has been removed. 18. Item has been removed. 19. If the client cancels a programmed shift within 5 hours of the shift commencing then Austek Asphalt Services reserves the right to pass on any external (subcontractor) costs Austek Asphalt Services has incurred due to (subcontractor) minimum cancellation notification requirements. 20. Rates do not allow for the provision of as-constructed drawings. 21. Rates allow for task lighting for night shift works. 22. Item has been removed. 23. Item has been removed. 24. Quotation assumes area will be clear of any obstacles allowing for the unimpeded operations of Austek Asphalt Services crews. Should this not be the case, Austek Asphalt Services reserves the right to revisit quotation.

#### **Standard Conditions:**

- Where the signing of a Subcontract Agreement is required for these works, then all submitted prices will be subject to review and final adjustment for any additional costs involved. - Quotation prices are offered in accordance with the attached Company terms & conditions. Should this quotation be successful, please sign & return the Acceptance of Quotation. - This quotation remains open for acceptance for 30 days from the date of issue, prices subject to review after this period. - This quote is subject to Rise and Fall of Bitumen from the date of the quote until the date the works are carried out - Seal Designs are not included in this rate - Quotation is based on works being carried out within normal working hours 700am - 400pm Monday to Friday - The quantities listed are approximate only and our invoice will be based on actual quantities completed. - Austek Asphalt Services reserves the right to adjust its prices relating to the provision of goods and services under agreement to accommodate cost increases relating to the commencement of the Clean Energy act 2011. - No deductions, retentions, back charges or set - offs are to be made by the customer against payment for these works. - Inductions/Medicals will be charged at \$120/man/hour after the 1<sup>st</sup> half hour

#### **QUOTATION STANDARD TERMS AND CONDITIONS**

These terms and conditions (Terms) will apply to any works (Works) (including the supply of materials) described in Austek Asphalt service's quotation (Quotation) and undertaken by Austek Asphalt Services at the Customer's request. Expressions used in the Quotation have the same meaning in these Terms.

#### **1. PRICE AND PAYMENT**

1.1 Subject to these Terms, Austek Asphalt Services will complete the Works for the Price. 1.2 Unless the Customer has entered into written terms of credit with Austek Asphalt Services, the Price must be paid in full by the Customer to Austek Asphalt Services before Austek Asphalt Services is required to deliver any materials or commence the Works. 1.3 Austek Asphalt Services may by notice to the Customer adjust the Price if: 1.4 during the period between the date of the Quotation and the commencement of the Works, the cost of labour or materials have changed; 1.5 the Works described in the Quotation are different from the work actually performed by Austek Asphalt Services pursuant to the Quotation or as required by the Customer; 1.6 Austek Asphalt Services may charge for any materials ordered by the Customer where the Customer, without reasonable prior notice to Austek Asphalt Services, refuses or is unable to accept delivery of the materials. 1.7 Any claim for alleged short delivery of material must be made by the Customer in writing within 7 days of delivery, failing which the quantity stated on the delivery docket will be deemed to be the actual quantity supplied, for which the Customer will be liable. 1.8 No deductions, retentions, back charges or set-offs are to be made by the Customer.

**Austek Spray Seal PTY LTD**  
**ABN 28 629 433 978**  
**Phone (07) 3496 2549**

## 2 SITE AND ACCESS

2.1 The Customer must: 2.1.1 provide Austek Asphalt Services with sufficient and safe access to and egress from the Site at all reasonable times, such that Austek Asphalt Services can undertake the Works in a safe and uninterrupted manner; 2.1.2 procure all consents, approvals, licences, permissions and permits required for Works, except those specified in the Quotation or entirely within the control of Austek Asphalt Services; 2.1.3 provide Austek Asphalt Services with all information relevant to the Works including the location of utilities; 2.1.4 mark the position of all services including pipes, drains, manholes, wiring and any obstacles in, under or about the Site; and 2.1.5 inform Austek Asphalt Services of any conditions affecting the Site or the Works which may impact upon the Works. 2.2 The Customer must ensure that the Site is: 2.2.1 prepared and maintained as specified in the Quotation and in a manner, that is in all respects fit for the purpose and suitable for Austek Asphalt Services performance of the Works; and 2.2.2 a safe workplace, such that Austek Asphalt Services can undertake the Works without risk of injury. 2.3 Should Austek Asphalt Services discover any: 2.3.1 material inconsistency between the existing position of the services, Site conditions and obstacles; and the information provided or marked by the Customer; or 2.3.2 any services, conditions and obstacles affecting the Site or the Works so as to render it reasonably impracticable for Austek Asphalt Services to continue with the Works, 2.3.3 Austek Asphalt Services may suspend the Works and immediately notify the Customer of such suspension. If, after 7 days of the suspension, the parties have not agreed in writing to recommence the Works, Austek Asphalt Services may terminate this contract, in which case Austek Asphalt Services will have no liability to the Customer for any loss or damage of any nature in no way connected with the Works, the contract or as a result of the suspension or termination. The Customer will be liable to Austek Asphalt Services for payment for the Works carried out prior to suspension or termination and for costs, losses and damages associated with the suspension and termination, including indirect and consequential losses. 2.4 Where Austek Asphalt Services equipment or labour stands idle because Site conditions do not permit the use of equipment or labour, Austek Asphalt Services may charge the Customer at the applicable standby rate for that equipment or labour. 2.5 If the Customer requires that any employee, sub-contractor or representative of Austek Asphalt Services undertake any form of induction or screening in addition to the procedures normally required by, Austek Asphalt Services may charge the Customer at the applicable standby rate for the period that individuals and equipment are not available to progress the Works, plus any extra over costs.

## 3 DELIVERY, PROPERTY AND RISK

3.1 Property in any materials supplied by Austek Asphalt Services to the Customer does not pass, and the Customer is prohibited from registering any security interest in any materials delivered by Austek Asphalt Services, until the Customer has made full payment for the Works. Risk in materials passes to the Customer at the time they are tendered to the Site for delivery. 3.2 At the time of delivery the Customer or its agent will sign Austek Asphalt Services delivery docket to acknowledge receipt of the materials delivered. If the Customer does not make itself or its agent available to sign Austek Asphalt Services delivery docket, the Customer appoints Austek Asphalt Services as the Customer's agent with authority to sign the delivery docket. 3.3 Where unloading of materials is not completed within 20 minutes of tender, Austek Asphalt Services may charge the Customer at Austek Asphalt Services standard rates in respect of any unloading time exceeding of 20 minutes. 3.4 Until payment of all monies owed by the Customer to Austek Asphalt Services, the Customer holds the materials as fiduciary Bailee and agent for Austek Asphalt Services and must keep the materials physically separate from all other goods of the Customer, and clearly identified as owned by Austek Asphalt Services. If the Customer breaches this contract in a material way (including non-payment) or Austek Asphalt Services determines (acting reasonably) that there is a material risk that the Customer may not be able to discharge its obligations under this contract, then without prejudice to Austek Asphalt Services other rights (including any rights Austek Asphalt Services may have pursuant to any applicable security of payments legislation), Austek Asphalt Services may without notice to the Customer enter any place where the materials are located (including the Site and premises occupied by the Customer) and recover possession of them. If the Customer sells any of the materials while money is owed to Austek Asphalt Services, or goods incorporating the materials are manufactured and / or resold by the Customer, the Customer must keep the proceeds of the manufacturing process and / or sale in a separate account and all book debts owed in respect, and proceeds, of such sales will be held in trust by the Customer for Austek Asphalt Services. 3.5 Unless specified in the Quotation, the Customer is responsible for any incidental damage caused to existing pavements, footpath crossings and other structures, surfaces and utilities associated with the Works. Austek Asphalt Services will not be responsible for maintenance and repair costs related to damage or contamination to applied surface treatments caused by others. 3.6 Unless specified in the Quotation, the Customer will be responsible for the: 3.6.1 establishment of appropriate traffic control signage prior to the commencement of the Works; 3.6.2 erection of aftercare signage at the completion of the Works; 3.6.3 provision of suitable facilities, including toilet and messing facilities; 3.6.4 removal of surplus and loose aggregate; and 3.6.5 application of temporary and final line-marking.

## 4 MATERIALS

4.1 Where the Works require Austek Asphalt Services to supply materials, the Customer is to provide at its cost a clean, hard stockpile site, which is suitable for mechanical loading and within 5 kilometres of the Site. If the stockpile site is more than 5 kilometres from the Site, the Customer is to pay any excess haulage costs incurred by Austek Asphalt Services at Austek Asphalt Services applicable rate. 4.2 If Austek Asphalt Services is unable to supply sufficient materials both to complete the Works and fulfil its obligations to other customers, Austek Asphalt Services may, in its absolute discretion, apportion the available materials between customers (including the Customer) and in doing so Austek Asphalt Services will not incur any liability, including for any loss or damage (consequential or otherwise) to the Customer as a result of being unable to obtain sufficient materials. 4.3 If, at the Customer's direction or request excess materials have been delivered to Site and must be removed, the Customer will be liable (and may be required to pay in advance) for the costs of Austek Asphalt Services transporting the excess materials from the Site, at Austek Asphalt Services applicable rate.

**Austek Spray Seal PTY LTD**

**ABN 28 629 433 978**

**Phone (07) 3496 2549**

## 5 SPECIFICATIONS AND TESTS

5.1 All Works performed by Austek Asphalt Services will comply with the Customer's specifications, as notified to and accepted by Austek Asphalt Services. If no Customer specifications are supplied, Austek Asphalt Services will perform the Works in accordance with Austek Asphalt Services current specification applicable to the type of Works, the relevant Australian Standard or general industry practice, as determined by Austek Asphalt Services. 5.2 Austek Asphalt Services will not undertake any tests unless specified and priced in the Quotation.

## 7 INDEMNITY

7.1 The Customer indemnifies Austek Asphalt Services, its related entities, sub-contractors and suppliers and each of their officers, employees, contractors and agents from and against all loss, cost, expense, demand, damage, claim or liability (collectively loss or claim) whatever and howsoever arising (whether in contract, tort, breach of statutory duty or otherwise) under or in connection with these Terms, the Works or the supply of materials, and including a breach of these Terms or the negligent act or omission of any person in connection with these Terms. 7.2 Without limiting the application of any of the foregoing, this indemnity includes an indemnity for any loss or claim by any person including the public, the Customer or its personnel, any person located on the Site or other third parties for injury, death, property damage or otherwise.

## 8 AUSTEK ASPHALT SERVICES LIABILITY

8.1 To the fullest extent permitted by law and notwithstanding any other clause of this contract, the liability of Austek Asphalt Services is limited, at Austek Asphalt Services option, to the replacement of defective materials or the repair of the Works or to providing the Works again or to the payment of the costs of having the Works provided again, provided that defects in the materials or the Works occur within 3 months of completion of the Works and is notified to Austek Asphalt Services within 10 days of the occurrence of the defect. 8.2 Austek Asphalt Services not be responsible for any loss of profit, penalties, expenditure, damages or losses (including, without limitation, any consequential, special, incidental or indirect loss or damages) incurred by the Customer arising out of any delay in delivery of the materials or performance of the Works, caused by or arising out of any use or dealing with the materials whether arising from any defect in the materials, unsuitability for the Customer's purposes, negligence by Austek Asphalt Services or its employees, representatives, officers, agents, contractors or suppliers or in any other way or caused by any act, omission, failure, fault or negligence by them in performing the Works. 8.3 The parties agree and acknowledge that Austek Asphalt Services lays materials and undertakes Works on supporting structures that are prepared by others and that, unless specified in the Quotation, Austek Asphalt Services is not liable for defects in the Works attributable to the constitution, integrity and performance of the supporting structures.

## 9 GENERAL

9.1 The Quotation and these Terms constitute the entire basis upon which Austek Asphalt Services will undertake the Works and any representations, warranties, explanations or commitments or other terms or conditions, express or implied, affecting the subject matter is superseded by this document and have no effect. If there is an inconsistency between these the Quotation and these Terms, the Quotation shall prevail. 9.2 The parties submit to the non-exclusive jurisdiction of the courts of the State or Territory in which the Works are to be performed and the laws applying in that State or Territory is the proper law governing these Terms. 9.3 If any part of these Terms is unenforceable such part shall be severed and any unenforceability shall not affect any other part. 9.4 Where a dispute arises between the Customer and Austek Asphalt Services as to the performance by either the Customer or Austek Asphalt Services, as a result of which the Customer threatens or fails to make any payment claimed by Austek Asphalt Services, Austek Asphalt Services may immediately cease performance of the Works without incurring any liability of any nature whatsoever to the Customer pending settlement of the dispute. 9.5 After the Quotation is provided to the Customer, any order for Works or materials placed by the Customer is deemed to be an order incorporating these Terms notwithstanding inconsistencies which may be introduced in the Customer's order or acceptance unless expressly agreed to by Austek Asphalt Services in writing. At all times, these Terms are to take precedence over any terms and conditions of the Customer. 9.6 The Quotation and these Terms may only be varied by agreement in writing signed by both Austek Asphalt Services and the Customer.

## 10 ACCEPTANCE OF TERMS & CONDITIONS

By signing the Quotation acceptance below, the Customer accepts these Terms and the Project Specific Terms and Conditions are part of the Quotation and that no other terms apply to the contract between the parties.

Signature: \_\_\_\_\_

Austek Spray Seal PTY LTD  
 ABN 28 629 433 978  
 Phone (07) 3496 2549

Name: \_\_\_\_\_

Title: \_\_\_\_\_

Date: / /

Austek Spray Seal PTY LTD  
ABN 28 629 433 978  
Phone (07) 3496 2549



Special Meeting of Council Thursday 15<sup>th</sup> April 2021

- 4.2 Subject:** Award of Contract CN 16068 Components
- Attachments:** 4.2.1 Sat Civil Submission (Infoxpert ID: 115298)  
4.2.2 Stabilised Pavements of Australia Submission (Infoxpert ID: 115299)  
4.2.3 Milray Contracting Submission (Infoxpert ID: 115300)  
4.2.4 Robinson Civil Group Submission (Infoxpert ID: 115301)  
4.2.5 Evolution Traffic Management Submission (Infoxpert ID: 115302)  
4.2.6 A20 Traffic Solutions Submission (Infoxpert ID: 115297)  
4.2.7 RFX Summary Report Base (Infoxpert ID: 115303)  
4.2.8 RFX Summary Report Traffic (Infoxpert ID: 115304)  
4.2.9 RFX Summary Report Seal (Infoxpert ID: 115305)  
4.2.10 RFX Summary Report Stabilise (Infoxpert ID: 115306)
- Author:** Director Engineering and Regulatory Services
- Date:** 13<sup>th</sup> April 2021
- 

**Executive Summary:**

Vendor Panel quotations from the relevant LocalBuy provider contracts were sought for:

- Traffic Management Services (BUS-270)
- Sealing Services (BUS-270)
- Stabilising and Additive supply Services (BUS-270)
- Supply of Base Aggregate (BUS-290)

To allow Council to undertake Contract Number CN 16068 Wills Developmental Rd Widening project for the Department of Transport and Main Roads(DTMR).

**Recommendation:**

*That Council resolves to:*

- Accept the quotation from A20 Traffic Solutions dated 9<sup>th</sup> April 2021 for Traffic Management Services for CN 16068 and;*
- Accept the quotation from RPQ dated 9<sup>th</sup> April 2021 for Sealing Services for CN 16068 and;*
- Accept the quotation from SAT Civil dated 9<sup>th</sup> April 2021 for Stabilising and Additive Supply Services for CN 16068 and;*
- Accept the quotation from Wagner's dated 9<sup>th</sup> April 2021 for Gravel Supply for CN 16068*

**Background:**

To allow Council to undertake Contract Number CN 16068 Wills Developmental Rd Widening project for the Department of Transport and Main Roads(DTMR). Vendor Panel quotations from the relevant LocalBuy provider contracts were sought for:

- Traffic Management Services



Special Meeting of Council Thursday 15<sup>th</sup> April 2021

- Sealing Services
- Stabilising and Additive supply Services
- Supply of Base Aggregate.

Some quotations are lump sum and some are daily or weekly rates, these are extrapolated over the expected program to allow fair comparison. Prices are GST Exclusive.

Traffic Management Services

Quotations requested from; A2O Traffic Solutions, Central West Traffic Control and Evolution Traffic Management Pty Ltd. Responses below:

- A2O Traffic Solutions \$384,560.00
- EvolutionTraffic Management \$617,907.84

A2O quotation was interpreted for comparison.

Recommended that A2O Traffic Solutions be engaged.

Sealing Services

Quotations requested from; Boral, Fulton Hogan, Pioneer, RPQ and Stabilised Pavements Australia. Responses below:

- RPQ \$334,779.62
- Stabilised Pavements Australia \$356,195.87

Recommended that RPQ be engaged.

Stabilising and Additive Supply Services

Quotations requested from; Downer Road Services, Milray Contracting, Robinson Civil Group, SAT Civil and Stabilised Pavements Australia. Some interpretation was required. Hydrated Lime was chosen to base pricing on.

	Plant and Accommodation	GB Cement	Hydrated lime	Quick Lime	Total
Robinson	250,850.00	67,221.00	88,920.56		406,991.56
SAT Civil	188,400.00	74,888.00	107,733.92		371,021.92
	188,400.00	74,888.00		53,810.77	317,098.77



Special Meeting of Council Thursday 15<sup>th</sup> April 2021

SPA	288,600.00	81,290.00	104,920.00		474,810.00
	288,600.00	81,290.00		52,746.67	422,636.67
Milray	203,100.00	75,900.00		56,186.67	335,186.67

Responses below:

- Milray Contracting \$335,186.67(Quick Lime)
- Robinson Civil Group \$406,991.56
- SAT Civil \$371,098.77
- Stabilised Pavements Australia \$474,810.00

Recommended that SAT Civil be engaged.

Supply of Base Aggregate

Quotations requested from; Wongbel Quarries, Boral, Camm Quarries, LD & LJ Hillery, Qcrush and Wagners. Responses below:

- Wagners \$433,920

Recommended that Wagners be engaged

**Consultation:** (internal/External)

Project Managers, Jim Sullivan and Brian Shephard PDM

**Legal Implications:**

Nil

**Policy Implications:**

Complies with Procurement policy

**Financial and Resource Implications:**

Works funded from DTMR Contract CN 16068

**InfoXpert Document ID:**

115307





Infoxpert ID: 115298

SAT Civil Constructions Pty Ltd  
503 Sandy Creek Road, Josephville QLD 4285

PO Box 946, Ashmore City QLD 4214  
AUSTRALIA

Ph: (07) 5541 0057 / 0087

Fax: (07) 5541 0078

www.satcivil.com.au

McKinlay Shire Council  
9 Coyne Street  
Julia Creek QLD 4823

Att.: Cameron Scott

Email: cameron.scott@mckinlay.qld.gov.au  
Ph.: 07 47464213

8 April 2021

Dear Mr Scott

**RE: CN- 16068 STABILISATION AND ADDITIVE SPREADING SERVICES**

Thank you for inviting SAT Civil a Division of Hiway Stabilizers Australia Pty Ltd to quote on the supply of a stabiliser, a spreader truck, binders and operators to carry out the works on the above project.

We have provided you with a daily rate for the stabiliser and the spreader truck including the operators, fuel, meals and accommodation to incorporate lime at 3% and GB cement to 200mm depth and have provided you with a per tonne rate for the supply of the hydrated lime, quicklime and GB cement.

Given the opportunity, SAT Civil will engage with the client in a very open and transparent way to achieve the most cost-effective outcome and develop a mutual beneficial working relationship.

We at SAT Civil pride ourselves on our large and modern fleet of Wirtgen stabilisers and spreader trucks that is well maintained and represents the pinnacle of stabilizing equipment available to date.

Thank you for giving SAT Civil this opportunity, we look forward to hearing from you.

Yours truly

A handwritten signature in blue ink, appearing to read 'Jan Weinert', is written over a white background.

JAN WEINERT  
General Manager

SAT Civil

HIWAY GROUP



The equipment we will supply for this project will be a Wirtgen Stabiliser WR 2400 and a Spreader Truck on loadcells with a capacity of 25 tonne.

## ESTIMATED COSTS FOR INSITU STABILISATION

Daily rate for stabiliser, spreader, operators, fuel, accommodation and meals: (rate includes 2 operator and a supervisor and a work vehicle)	\$6520.00
Stand Down charge (per weekday): (no stand down will be charged on weekends)	\$1700.00
Supply of Hydrated lime (per tonne):	\$626.36
Supply of Quicklime (per tonne):	\$469.28
Supply of GB cement (per tonne):	\$340.40
Establishment/ Disestablishment per visit (each way):	\$4350.00



## TERMS AND CONDITIONS

### PLEASE NOTE THE FOLLOWING:

Water cart and water supply, compaction, trimming, survey, testing and traffic control are not supplied, nor included in the rates provided.

Our operator rates and site allowances are included in the rates provided.

Crew accommodation and meals are included in the rates provided.

Fuel for our machine and truck is included in the rate provided.

A work vehicle has been included in the rates provided.

A minimum of 24 hours notice are to be given by the client to cancel any binder deliveries.

Supply of cutting picks and tool holders are included in the daily rate.  
However, we do not expect to encounter excessively hard or rocky areas.

If there are any internal sites moves required, where the machine cannot be walked, they are to be organised and paid for by the Client.

Any days set aside for inductions, medicals or the like, will be charged at the same rate as a Stand Down day.

Any special equipment or modifications needed, for our equipment to comply with the Client's specific requirements, will be charged back to the Client.

Prices given for equipment hire etc. will be kept firm for a period of 12 months from date of quotation. Prices will be reconfirmed after this time.

No retention monies will be withheld from SAT Civil.

All prices are exclusive of GST and at the time of invoicing, a 10% GST component will be charged.

Payment terms will be strictly 30 days from date of invoice.



**STABILISED  
PAVEMENTS  
OF AUSTRALIA**  
PTY LTD  
STRENGTH • FLEXIBILITY

## QUOTATION SUBMISSION

▶ **McKinlay Shire Council**

---

**Lime and Cement Stabilisation  
Wills Dev Road (CN-16068)  
Part Service**

---

SPA Ref: T4244

Date: 09/04/21



Email: cameron.scott@mckinlay.qld.gov.au  
 Phone: 0427 470 009  
 Attention: Cameron Scott

RE: CN – 16068 Stabilisation and Additive Spreading Services (VP236501)

We are pleased to quote for the proposed stabilisation. Unless specified otherwise, this quote and any subsequent work arising from it is subject to our attached terms, conditions and general notes. This quote is valid for 90 days.

### **Mobilisation**

Establish/Disestablish a stabiliser/reclaimer with 2.4m wide mixing drum and a spreader including 2 x operators and leading hand to site approx. 6km west of Julia Creek

Establishment **\$7,150.00 / each**

Disestablishment **\$6,600.00 / each**

### **Stabilisation**

Spread binder (Hydrated Lime – 3% and GB cement – 2% by mass) and mix at depths of up to 200mm per pass in a minimum two pass mixing process while incorporating moisture as directed on the final full depth pass

Stabiliser & Spreader incl 2 operators and foreman **\$5,800.00 / day**

### **Binder Supply**

Supply of stabilising agents in bulk tankers to pump directly into spreader truck and site storage

GB Cement (min 21 tonne loads) **\$369.50 / tonne**

Hydrated Lime (min 19 tonne loads) **\$610.00 / tonne**

Quicklime (min 23 tonne loads) **\$460.00 / tonne**

Site storage (tanker and blower/compressor) **\$550.00 / week**

Establish site storage **\$850.00 / visit**

Disestablish site storage **\$3800.00 / visit**

### **Miscellaneous**

Stand down **\$2,900.00 / day**

Stabilisation GET

GET – Teeth (after 20 free per day) **\$9.00 / each**

GET – Blocks (after 2 free per day) **\$75.00 / each**

All rates exclude GST

- This quotation is provided under the following contract considerations
- Client to supply: all preparation works (earthworks, etc); traffic management; service locations; trimming & compaction, water cart(s) & construction water and compliance testing.
  - Included in rates: Accommodation incl meals, fuel & servicing;
  - Stand down to apply on non-working weekdays when plant is required to remain on site.
  - Pricing of Binder is subject to rise and fall of both material and transport costs.
  - Binder waiting time (if applicable) will be charged after 1.5 hours at \$195 per hour for delays out of the control of Stabilised Pavements of Australia or due to the works method process.
  - SPA request 2 weeks notification of works commencing but will look to work with client timeframes.
  - SPA will not be held liable for customer's costs if additive supply is not available. If binder is supplied by the Client with coordination of deliveries by SPA personnel, there is a charge of \$5.00 / tonne coordination
  - Programming of stabilisation plant for during the contract period at the discretion of SPA.
  - SPA General Terms and Conditions apply.

Thank you for the opportunity of quoting for this work and we look forward to being of service to you.

Yours faithfully,



**Matt Devine**  
 Engineering Manager, North Queensland  
 Stabilised Pavements of Australia  
 mdevine@stabilis.com.au

Accepted by client/contractor:

Name: \_\_\_\_\_

Position: \_\_\_\_\_

Signature: \_\_\_\_\_

Date: \_\_\_\_\_

**Contract**

The documents comprising this contract, in order of precedence, are:

1. SPA Quotation (including any Special Conditions);
2. SPA General Terms and Conditions;
3. Drawings (if applicable);
4. Technical Specifications;
5. Notice of Acceptance
6. Other documents expressly referred to in the Quotation.

**Extent of the Works and Pricing**

This quote is based upon information supplied to Stabilised Pavements of Australia Pty. Limited (SPA) by the Customer prior to submission of quotation. If any details change from the information supplied, SPA reserves the right to review our quotation or rates and invoice accordingly. Where work is to be paid for by a schedule of rates, the following limits of accuracy shall apply to the rates:

- (a) where indicated in the Schedule of Rates as either a  $\pm$  percentage of, or a  $\pm$  number of, the quantity, that percentage or number shall apply; or
- (b) where not indicated on the Schedule of Rates, the limit of accuracy shall be  $\pm$  10% of the quantity stated.
- (c) The limit of accuracy for provisional quantities and provisional sums is  $\pm$  20% of the quantity or sum stated.

Where limits of accuracy are exceeded, SPA reserves the right to ascertain if submission of revised rates and/or sums will apply.

**Validity**

This quotation is valid from a period of 90 days from the date of quotation and is subject to rise and fall of labour, materials and transport costs after this period. This quotation does not allow for any site allowances or job specific conditions outside the relevant SPA enterprise agreement. Any such allowances or conditions would be subject to additional charge under the variations clause of these terms and conditions. The Customers written order to commence work or otherwise the commencement of work by SPA constitutes acceptance of this offer in full.

**Hours of Work**

Unless specified otherwise, this quotation is based on the completion of works being undertaken during normal hours as defined under this clause. In the case whereby works are undertaken outside normal working hours, additional charges may apply under the terms of the variations clause of these terms and conditions. Normal working hours as defined by SPA and these conditions are from 7:00am until 4:30pm Monday to Friday and are exclusive of public holidays. In circumstances where project or site specific rosters are in place, these must be clearly communicated to SPA and agreed upon to ensure inclusion within our quotation.

**Variations**

SPA is not obliged to carry out any variations that are outside the scope of works as defined by the information provided by the Customer to SPA prior to the submission of this quotation. All variations should be issued in writing to SPA prior to commencement of works. Any variation carried out by SPA shall be in accordance with these conditions and at a rate agreed to between SPA and the Customer prior to commencement. In the absence of an agreed rate, any works carried out under the terms of variation shall be charged at a rate as determined by SPA.

**Specifications**

The works are to be carried out in accordance standard industry best practice unless otherwise advised in writing prior to submission of this quotation. In the case where any specifications, drawings or information otherwise is provided after submission of quotation, SPA reserves the right to review our quotation accordingly.

SPA takes no responsibility for the accuracy or suitability of any specifications, drawings or other documents provided by the Customer in relation to the works.

**Underground Services and Obstacles**

All underground services shall be clearly marked on the surface showing locations and depth and advised to the SPA representative before commencement of works. SPA shall not be liable to the Customer for any damage caused to underground services not marked in the above manner.

**Damage to plant and equipment due to unmarked obstacles or latent conditions is to be repaired at the cost of the Customer.**

**Postponement, Delays or Cancellation**

SPA reserves the right to charge a fee for costs incurred due to late changes or cancellations including (but not limited to) labour, machinery and materials costs. If not otherwise stated, a stand down charge may be levied for planned but non-production days during programs. Where re-establishment of labour or some machinery is required in these cases or in

cases for holiday periods or extended delays, some or the full establishment fee may still apply. In the event that a non-productive day or days is required for SPA to attend inductions or assist with machinery inspections, daily stand down charges will apply.

**Notices**

All notices must be given to the address shown on our quotation, or to such other address as may be designated in writing by either party to the other. This would be inclusive of electric means such as email.

**Quantity and Acceptance**

Customer acceptance of work to be agreed and signed for on a daily basis. In the event that there is no Customer representative on site then our recorded quantities shall be deemed to be correct whether signed by an authorised Customer representative or otherwise. Further progress of works without written direction otherwise prior to receipt of verification for final acceptance of the stabilised layer is at the Customer's risk.

**Payment Terms**

For existing account holders this quotation is based on full payment within 30 days from the date of the invoice. **Our invoice shall not be subject to any retention monies being held.** Where no account is held, payment terms will be negotiated prior to the commencement of works after credit references are received. Interest of 15% p.a. accruing daily will be charged on overdue accounts.

**Tax**

10% GST will be levied in addition to all quoted rates.

If there is a change in law or a new law relating to the imposition of a tax, duty, impost, levy or other charge (including any carbon type tax or similar) imposed by a government or government agency on, or incurred by, SPA which is attributable in any way to the Goods & services, SPA shall be entitled to increase the price of the Goods by an amount sufficient to offset such imposition.

**Warranty**

A warranty of defects liability period is not applicable unless otherwise written or agreed to in writing prior to acceptance of works. SPA shall not be liable for any failures that are as a result of any portion of the pavement or works that have not been completed by SPA. These may include subgrade, sub base, base course or wearing course dependent on the scope of the works.

**Liability and Indemnity**

Under the conditions of this offer, SPA shall not be liable in any circumstances including:

- i. For any damage to any property located in, or adjacent to the works site as a result of works carried out by SPA in accordance with conditions of this quotation
- ii. For any loss arising from delay during execution of the works including any stand down time incurred by the Customer due to SPA's plant/machinery breakdown or delay in delivery of materials
- iii. For any loss arising from non-conforming product that contains workmanship or materials being installed or placed by others
- iv. For any consequential loss

SPA's liability in all circumstances is limited to the value of the works that any claim may relate to.

**Extension of Time**

SPA may claim an extension of time to the Completion Date (where one is provided in writing) where:

- (a) the Works are delayed by any Excusable Delay and it will prevent SPA from achieving Completion by the Completion Date;
- (b) the Works are not concurrently delayed by a cause that is not an Excusable Delay; and
- (c) the delay was not contributed to by an act or omission of SPA or its Personnel.

**Governing Law and Jurisdiction**

- i. The law of the State or Territory of the Site governs this Contract (Governing Law).
- ii. Each party irrevocably submits to the exclusive jurisdiction of the courts of the Governing Law and courts competent to hear appeals from those courts.
- iii. Neither the Sale of Goods (Vienna Convention) Act 1986 (NSW) (or similar legislation in other Australian jurisdictions) nor any international conventions or recognised customs in relation to rules that may otherwise apply for or in respect to the international sale of goods, have any application to any matter in connection with the Contract.

**Non Legislated WHS Requirements**

Our offer includes provisions for compliance with legislated WHS requirements and associated controls however no allowance has been made for any site, project or contract specific WHS requirements other than those specified during the respective RFQ or Tender Documentation. Any such request beyond a legislated requirement and not communicated through an RFQ or tender documentation will be considered a variation in accordance with the 'Variations' clause of these terms and conditions.

#### Force Majeure

SPA shall not be deemed liable under any circumstance that results in loss or damage, consequential or otherwise, arising from any delay or failure by SPA in meeting its obligation in respect to the works that are outside the control of SPA. Without limiting the generality thereof including restrictions of government or other statutory authorities, wars, riots, civil unrest, fires, storm, flood, earthquake, failure of electrical power supply, road or rail closures, epidemics, accident, labour dispute or materials or labour shortage.

#### Other

- i. Unless otherwise expressly stated, the Customer must at its own expense apply and/or obtain all permits, approvals and licences as required for the works.
- ii. Where applicable, the copyright in all plans, designs, drawings, engineering information, data, reports, accounts and any other material given to the Customer by SPA remains the property of SPA and may only be used by the Customer for the purposes of this contract.
- iii. Where any provision of this contract is void, illegal or unenforceable, it may be severed without affecting the enforceability of the other provisions in this contract.

#### Exclusions

Unless expressly stated in the Special Conditions, work activities excluded from this Quotation are:

- i. Preparation of pavement prior to the execution of agreed scope of works;
- ii. Identification, location and marking/recording of underground services;
- iii. Supply of water and/or water carts;
- iv. Provision of level control and/or survey;
- v. Traffic control;
- vi. Internal float moves;
- vii. Any form of design;
- viii. Any form of testing;
- ix. Provision of wearing course;
- x. Third party VOC for operators;
- xi. Trials;
- xii. Trucks or any other equipment deemed necessary for loading and disposal of spoil;

#### Specific Services

Unless expressly stated in the quotation and /or Special Conditions, the following conditions are applicable for each of our core business activities:

##### Part Service Stabilisation

Compaction, trimming, curing and other item/s not expressly noted in the scope description provided in our quotation has not been allowed for.

Every effort is made to achieve the production rates expected by the Customer. However traffic/site conditions &/or Customer work schedule may be the controlling factors for production output per day. The invoiced amount for operations per day will be based on the higher value of either production achieved or minimum daily operation rate.

Unless otherwise stated, the price of additive (supply and/or transport) is based on the following minimum load sizes. Higher prices apply for smaller loads to account for dead freight costs. It is the responsibility of the Customer to inform SPA of any short loads required prior to quotation otherwise any short loads required will be charged as a variation.

- Cement or cementitious blends 25 tonnes
- Quicklime 24 tonnes
- Hydrated Lime 22 tonnes
- C170 Bitumen 22 tonnes

Delivery is subject to product availability. If applicable, waiting time for supply tankers will be charged at \$195.00 per hour (ex GST) after the first 1.5hrs. **Waiting time or cartage charges for additive deliveries will be applicable due to inclement weather or any other delays caused outside the control of SPA.**

Spreader trucks are custom designed and fitted with load cells to accurately measure the quantity of additive on board. Additive will be spread to achieve the required spread rate with +/- 10% tolerance for cement and/or

lime blends.

Australian Standards, NSW WorkCover and other organisations have advised ROPS may not be required for Reclaimer/Stabiliser mixing plant if a Risk Assessment is conducted. While many SPA stabilisers are fitted with ROPS, some are not. It is the responsibility of the Customer to advise SPA if a stabiliser fitted with ROPS is required for their site conditions. It may be necessary for SPA to charge higher establishment for a ROPS fitted stabiliser.

The material to be stabilised should be such that none has a dimension greater than 75mm and 95% would pass a 50mm sieve. Material outside this requirement may result in damage to the reclaimer/stabiliser with such costs to be incurred by the Customer.

SPA are to be informed if the bitumen seal or asphalt layer thickness to be incorporated exceeds 60 mm, if pavement has been previously cement treated or is a bound pavement of any nature. SPA recommends such pavements be pulverised with a milling machine prior to stabilisation works.

**Excessive teeth and block wear i.e. more than 20 teeth and 2 blocks per day will be charged to the customer at a rate of \$9 per tooth and \$75 per block (ex GST).** Excessive wear can be a result of oversize material, bound layers/asphalt, abrasive materials (e.g. sand) or other latent causes.

SPA provides pavement and mix design proposals for costing purposes. Where testing for mix designs is carried out it is done by NATA Registered Laboratories. The Customer should satisfy themselves that the final design is suitable for their requirements. Certified pavement designs by external engineers can be arranged at cost.

##### Profiling

Unless expressly stated in the quotation and /or Special Conditions, provision of clean up (bobcat and broom), provision of stockpile site/s for profiled materials and profiling of rock/concrete or any other similar hard material/s has not been allowed for.

There will be no charge for wet weather if notified with a minimum of 2 hours before commencement of work, otherwise the stand-down rate will apply.

##### Spray Sealing

Unless expressly stated in the quotation and /or Special Conditions, cleaning of fixed structures such as kerb and guttering, removal of loose aggregate from site and erection/maintenance of warning signs has not been allowed for.

##### Storage of Materials

- i. Where the works require SPA to supply aggregate, the Customer is to supply a suitable, clean, hard stockpile site at no cost to SPA.
- ii. Where the Works involve SPA loading, hauling or spreading aggregate, the Customer is to provide an aggregate stockpile site suitable for mechanical loading within 3 kilometres of the Site. If the aggregate stockpile site is more than 3 kilometres from the Site, the Customer is to pay any excess haulage costs incurred by SPA at SPA's ruling rate.

##### Excess Materials

- iii. Where the Works comprise the supply and delivery of materials only, the Customer is to pay for any returned materials at SPA's ruling rate. The Customer is to pay the costs of transporting any excess materials from the Site to SPA's depot at SPA's ruling rate.

##### Demurrage and Cancellation

- iv. Based on transportation distances for binder and aggregate transport, customers should be aware of the lead times required for orders and the potential impacts of cancellations or postponed works. Any costs associated with the cancellation or postponement of works that result in demurrage or delay costs will be managed in accordance with SPA Quotation Terms and Conditions with reference to clause 'Postponement and Cancellation'.





# QUOTE

Customer:
Cameron Scott Director Engineering & Regulatory Services McKinlay Shire Council

DATE	QUOTE #	CONTACT PERSON	JOB
09/04/2021	21.008	Peter Bell <a href="mailto:peter.bell@milray.com.au">peter.bell@milray.com.au</a>	CN-16068 Stabilisation & Additive Spreading

QTY	DESCRIPTION	UNIT PRICE EX GST	LINE TOTAL EX GST
	Mobilisation/Demobilisation of in-situ stabiliser, spreader truck, service truck & stabiliser hand	\$14,000.00	
	Daily hire of Stabiliser including teeth, blocks, fuel, operator, accommodation & travel	\$3,350.00/day	
	Hire of spreader truck including fuel, operator, accommodation & travel	\$2,025.00/day	
	Supply of stabiliser hand including accommodation & travel	\$975.00/day	
	Stand Down rate (where applicable) for entire crew	\$1,400.00/day	
	Supply and delivery of quick lime ex. Cement Australia	\$490.00/tonne	
	Supply and delivery of GB cement ex. Cement Australia	\$345.00/tonne	
	Weekly hire of site tanker	\$750.00/week	
		SUBTOTAL	
		GST	
		TOTAL	

Special Notes and Instructions:
Please confirm your acceptance of this quote by signing this document and return via fax, mail or email to the address given. Quote is valid for 30 days. Terms & Conditions: Payment 30 Days from date of Invoice.

Signature: \_\_\_\_\_ Print Name: \_\_\_\_\_ Date: \_\_\_\_\_

*Thank you for your business.  
Should you have any enquires concerning this quote please do not hesitate to contact us.*

**Head Office**

6 Elms Road **Wondecla Q 4887**

PO Box 271 **Herberton Q 4887**

**Local Offices/Depots**

133 Tompkins Road **Townsville Q 4818**

221 Kohmomum St **Kowanyama Q 4871**

9 April 2021

Dear Sir / Madam

**RE: CN-16068 Stabilisation and Additive Spreading Services  
McKinlay City Council**

Please find below quote for CN-16068 – Stabilisation and Additive Spreading Services.  
Please note this cover letter forms part of the documentation provided.

RCG is a Far North Queensland firm delivering local, rural and remote works for over 40 years. Key operational benefits provided by this organisation are;

- ✓ High quality works utilising the latest in technology
- ✓ Extensive technical and operational knowledge
- ✓ Effective determination and delivery of client requirements
- ✓ Highly skilled and experienced workforce
- ✓ Flexible working methodologies to meet client requirements
- ✓ Proven ability to deliver works on time and on budget

This firm holds Prequalification; AUSTRROAD's National Prequalification System for Civil (Road and Bridge) Construction Contracts to the following levels:

- ✓ Roadwork's Level R3
- ✓ Bridgeworks Level B2
- ✓ Financial Level F50
- ✓ Prequalification Status – FULL



And operates under a 3rd party certified (by SAI Global) Integrated Management System

- ✓ AS/NZS ISO 9001:2015 Quality Management System
- ✓ AS/NZS ISO 14001:2015 Environmental Management System
- ✓ AS/NZS ISO 4801:2001 Health and Safety Management System



With accreditation under the Australian Government Building and Construction WHS Accreditation Scheme.

RCG undertakes all works in a collaborative manner to achieve the best outcome for our clients. We work to problem solve, apply effective logistical approaches and develop works methodologies to best suit the requirements of the project being undertaken. We value our reputation - which is one of integrity and high standards; and we believe that this provides the customer with confidence that our focus is on quality works.

**Please see pricing over page: -**



**Head Office**

6 Elms Road **Wondecla Q 4887**

PO Box 271 **Herberton Q 4887**

**Local Offices/Depots**

133 Tompkins Road **Townsville Q 4818**

221 Kohmomum St **Kowanyama Q 4871**

9 April 2021

**Stabiliser and Spreader Truck**

**Wirtgen W240 or W2400**

**2.4m width x 300mm depth**

Daily Hire ( <i>Day Rate – Includes Operator</i> )	per day	\$ 3,400.00 + GST
Daily Stand Down Rate ( <i>Day Rate</i> )	per day	\$ 1,700.00 + GST
Mobilisation	each	\$ 3,735.00 + GST
Operator Establishment and travel	per hour	\$ 65.00 + GST

**Streumaster Spreader Truck**

**16m3 or 20m3**

Daily Hire ( <i>Day Rate – Includes Operator</i> )	per day	\$ 1,400.00 + GST
Daily Stand Down ( <i>Day Rate</i> )	per day	\$ 700.00 + GST
Mobilisation to and from Site	each	\$ 1,400.00 + GST
Operator Establishment and travel	per hour	\$ 65.00 + GST

**Supervisor & Ute**

Daily Rate	per day	\$ 1,000.00 + GST
------------	---------	-------------------

**2 ISO Containers and Compressor**

2 x ISO Hire	per week each	\$ 500.00 + GST
2 x ISO Mobilisation	each	\$ 3,750.00 + GST
Compressor Hire	for duration of project	\$ 2,600.00 + GST

**GB Cement**

GB Cement FAB	per tonne	\$ 305.55 + GST
---------------	-----------	-----------------

**Hydrated Lime**

Delivered to site	per tonne	\$ 516.98 + GST
-------------------	-----------	-----------------

**Accommodation/Meals**

Daily Rate (per person)	per day	\$ 135.00 + GST
-------------------------	---------	-----------------

**Please note**

- **Availability** - Availability is not confirmed until a firm booking is made with an accompanying Purchase Order or written direction. Receipt of same will constitute acceptance of Terms and Conditions of hire provided below.
- **GET's**- Ground Engaging Tools (GET's) will be supplied as 15 picks and 1 adaptor per day without pro-rata. All additional GET's charged separately at \$8.00 per pick & \$60.00 per adaptor. Usage is site specific depending on density and the abrasiveness of pavement.
- All Pricing is **excluding GST**.



Infoxpert ID: 115301

**Robinson Civil Group**

P: +617 4096 2399

F: +617 4096 2752

***Head Office***

6 Elms Road **Wondecla Q 4887**

PO Box 271 **Herberton Q 4887**

***Local Offices/Depots***

133 Tompkins Road **Townsville Q 4818**

221 Kohmomum St **Kowanyama Q 4871**

9 April 2021

**CURRENT REGISTRATIONS**

Due to TMR constraints any renewed registration certificates that fall due during the tendering period will be provided at time of engagement.

**OPERATOR COMPETENCIES**

RCG will provide copies of operator's licences and competencies at the time of engagement. Employee qualifications and competencies relevant to the tender are supplied in attached Skills Matrix.

Should there be anything further you wish to clarify regarding the offer made by this firm please do not hesitate to contact myself at the office on 07 4096 2399.

Yours sincerely

Caytlyn Mead

CEO

Lime Stabilisation						
	Ave Daily Usage	Plant Cost			Accommodation / Food	ISO & Compressor
		Stabiliser	Spreader	Supervisor & Ute	3 Staff	
	MOB	\$3,735.00	\$1,400.00	\$1,135.00	\$925.00	\$3,750.00
Week 1	Monday	\$3,400.00	\$1,400.00	\$1,000.00	\$405.00	
	Tuesday	\$3,400.00	\$1,400.00	\$1,000.00	\$405.00	
	Wednesday	\$3,400.00	\$1,400.00	\$1,000.00	\$405.00	
	Travel OUT	\$1,700.00	\$700.00		\$1,560.00	
	Friday	\$1,700.00	\$700.00			\$500.00
	Monday	\$1,700.00	\$700.00			
	Travel IN	\$1,700.00	\$700.00		\$1,965.00	
Week 2	Wednesday	\$3,400.00	\$1,400.00	\$1,000.00	\$405.00	
	Thursday	\$3,400.00	\$1,400.00	\$1,000.00	\$405.00	
	Travel OUT	\$1,700.00	\$700.00		\$1,560.00	\$500.00
	Monday	\$1,700.00	\$700.00			
	Travel IN	\$1,700.00	\$700.00		\$1,965.00	
Week 3	Wednesday	\$3,400.00	\$1,400.00	\$1,000.00	\$405.00	
	Thursday	\$3,400.00	\$1,400.00	\$1,000.00	\$405.00	
	Friday	\$3,400.00	\$1,400.00	\$1,000.00	\$405.00	\$500.00
	Travel OUT				\$1,560.00	
	Monday	\$1,700.00	\$700.00			
	Tuesday	\$1,700.00	\$700.00			
	Travel IN	\$1,700.00	\$700.00		\$1,965.00	
Week 4	Thursday	\$3,400.00	\$1,400.00	\$1,000.00	\$405.00	
	Friday	\$3,400.00	\$1,400.00	\$1,000.00	\$405.00	\$500.00
	Travel OUT				\$1,560.00	

Program Costing Overview

\*\*Estimation based on details provided only. Refer to itemised pricing for reference.

GB Stabilisation						
	Ave Daily Usage	Plant Cost			Accommodation / Food	ISO & Compressor
		Stabiliser	Spreader			
					3 Staff	
Week 5		\$8,500.00	\$3,500.00			\$500.00
	Travel IN				\$1,965.00	
Week 6	Monday	\$3,400.00	\$1,400.00	\$1,000.00	\$405.00	
	Tuesday	\$3,400.00	\$1,400.00	\$1,000.00	\$405.00	
	Wednesday	\$3,400.00	\$1,400.00	\$1,000.00	\$405.00	
	Travel OUT	\$1,700.00	\$700.00		\$1,560.00	
	Friday	\$1,700.00	\$700.00			\$500.00
	Monday	\$1,700.00	\$700.00			
	Tuesday	\$1,700.00	\$700.00			
Week 7	Travel IN	\$1,700.00	\$700.00		\$1,965.00	
	Thursday	\$3,400.00	\$1,400.00	\$1,000.00	\$405.00	
	Friday	\$3,400.00	\$1,400.00	\$1,000.00	\$405.00	\$500.00
	Travel OUT				\$1,560.00	
	Travel IN				\$1,965.00	
	Monday	\$3,400.00	\$1,400.00	\$1,000.00	\$405.00	
Week 8	Travel Out	\$1,700.00	\$700.00		\$1,560.00	
	Wednesday	\$1,700.00	\$700.00			
	Thursday	\$1,700.00	\$700.00			
	Friday	\$1,700.00	\$700.00			\$500.00
	Travel IN	\$1,700.00	\$700.00		\$1,965.00	
	Tuesday	\$3,400.00	\$1,400.00	\$1,000.00	\$405.00	
	Wednesday	\$3,400.00	\$1,400.00	\$1,000.00	\$405.00	
Week 9	Travel OUT	\$1,700.00	\$700.00		\$1,560.00	
	Friday	\$1,700.00	\$700.00			\$500.00
	Monday	\$1,700.00	\$700.00			
	Travel IN	\$1,700.00	\$700.00		\$1,965.00	
Week 10	Wednesday	\$3,400.00	\$1,400.00	\$1,000.00	\$405.00	
	Thursday	\$3,400.00	\$1,400.00	\$1,000.00	\$405.00	\$2,600.00
	De-Mob	\$3,735.00	\$1,400.00	\$1,000.00	\$520.00	\$4,250.00

Program Costing Overview

\*\*Estimation based on details provided only. Refer to itemised pricing for reference.

## ETM Submission

### MCKINLAY SHIRE COUNCIL: Wills Development Rd Project (Julia Creek)

Please note this tender is based on Evolution's standing price schedule with LGP as advised by McKinlay Shire Council.

#### Standard Estimate

Estimate based on the tender documents "worst case scenario" where the project could potentially have three (3) active sites operating concurrently.

#### Categorised Full Project Pricing Total

TRAFFIC MANAGEMENT	\$ 371,302.40
PROJECTS AND PLANNING	\$ 1,355.00
ACCOMMODATION (AWAY WORKS)	\$ 85,2600.00
TRAVEL (AWAY WORKS)	\$ 36,368.64
ADDITIONAL EQUIPMENT (ITEMS ONLY)	\$ 163,008.00

<b>Total</b>	<b>\$ 657,294.04 (ex. GST)</b>
--------------	--------------------------------

Complete costs breakdown available on page 5.

#### Stage Split Estimate

Based on discussions between McKinlay Shire Council and our planning team, we have also provided an estimate based on a potential split of the stages (1/2 and 3/4) to show the variance in price if one crew (2x TC and 1x Ute) could be demobilised early. This split in days required for each stage assumes the duration of stage 1 and 2 (operating 3 sites) would be longer than the duration of stages 3 and 4 (operating only 2 sites at once). These estimates can be modified if requested to reflect an accurate timeline for the duration within each stage.

#### Categorised Stage Separation Project Pricing Total

TRAFFIC MANAGEMENT (STAGE 1 & 2)	\$ 208,857.60
TRAFFIC MANAGEMENT (STAGE 3 & 4)	\$ 123,058.60
PROJECTS AND PLANNING	\$ 1,355.00
ACCOMMODATION (AWAY WORKS)	\$ 85,2600.00
TRAVEL (AWAY WORKS)	\$ 36,368.64
ADDITIONAL EQUIPMENT (ITEMS ONLY)	\$ 163,008.00

<b>Total</b>	<b>\$ 617,907.84 (ex. GST)</b>
--------------	--------------------------------

Complete costs breakdown available on page 6.

## Summary of Requirements Overall

Based on information from our planning team, we estimate the requirements of the project are:<sup>1</sup>

### **Traffic Management:**

4x traffic control crews (2x TCs and 1x Ute per crew)

Overnight Signage (approximately 32 signs)<sup>2</sup>

On Site Allowances

- Daily fare allowance (standard every shift per person)
- Meal allowance (for continuous shifts 9.5hrs or longer per person)

### **Accommodation:**

Hotel accommodation charges (cost + 10%)

Living away meal allowance (daily per person for any away works)

### **Additional Travel for Away Works:**

7hrs travel required from our Townsville depot to Julia Creek

### **Equipment (sought through external suppliers): does not include delivery or pickup**

3 x sets of trailer mounted traffic lights

6 x lighting towers

552 x bollards (additional outside our vehicles' capacity)

18 x delineators (not charged, included in our vehicle rate)

## Additional Factors to Note

### **Emergency Night Callout:**

Please note that should an emergency callout require the traffic controllers onsite outside of their standard shift hours additional costs may be incurred. If the TC goes onsite at night after working a full shift that day, the hourly rate will be charged at "Callout Overtime T2.5" (2.5 x the standard rate).

In this instance the TCs will then also be required to be stood down for 10hrs following the completion of the emergency callout. This may result in one of the project sites pausing in work until the TCs can safely management the site (under fatigue management procedures)<sup>3</sup>.

Alternatively, Evolution can provide an additional crew on top of the provided estimates to allow for potential occurrences, i.e. emergency callouts, sick leave, etc.

**Video Run:** if required by DTMR, our traffic controllers are available to do weekend video runs. These will be charged at the relevant hourly rate (4 hour minimum charge) per run.

<sup>1</sup> Please note, Evolution cannot guarantee that the requirements will not vary. All traffic management will be billed hourly based on the on-site requirements (all potential changes will be communicated to the client).

<sup>2</sup> Does not include any costs associated with the purchase, installation or removal of permanent requirements (i.e. star pickets)

<sup>3</sup> Evolution will not be liable for delays to the client's project work due to external factors including, but not limited to, emergency callouts, fatigue management protocols, wet weather, etc.



## Methodology Overview

After discussions with our planning team where the sites have been evaluated as per the TMPs/TGSs they are currently completing, your site will require a minimum of four (4) crews (8x TCS and 2x Utes). There will be one crew per site, and the fourth crew will operate the rest and relief portion required as per DTMR standards.

**Reference Point 1:** For the project overall, our Townsville depot will supply McKinlay Shire Council with the traffic controllers in “away portions” where the TCs will stay in the accommodation for their full duration and complete a “full roster rotation” between each duration. Away portion durations are:

- Away Portion 1: weeks 1-3
- Away Portion 2: weeks 4-6
- Away Portion 3: weeks 7-9
- Away Portion 4: weeks 10-12
- Away Portion 5: weeks 13-16 (only 4 week portion)

The complete estimate allows for four (4) roster rotations throughout the project however this can change based on the requirements on site, client preference and staff/depot availability.

**Reference Point 2:** Evolution has had to outsource the supply of additional equipment for this project. The total of this supply has been provided in the complete estimate, with a cost breakdown provided below:

Point 2: Equipment Cost Breakdown				
QTY	WEEKS	DESCRIPTION	UNIT PRICE	AMOUNT
6	16	Portable Traffic Lights (per week)	\$ 550.00	\$ 52,800.00
6	16	Lighting Tower (per week)	\$ 550.00	\$ 52,800.00
552	16	Additional Bollards (per week)	\$ 6.50	\$ 57,408.00
SUBTOTAL (excl. GST)				\$ 163,008.00

The delivery and pickup costs range depending on supplier and therefore, the above breakdown and the full estimate do not include these costs. See below an example of two prices we have received that may need to be applied considering the equipment is coming from Townsville.

- **Supplier #1:** \$22,728 per trip (includes traffic lights, lighting towers and bollards)
- **Supplier #2:** \$6,000 per trip (includes **only** traffic lights and lighting towers, bollards would be additional) – *these options would be investigated whilst in communication with council if we are the successful supplier.*

If council has a preferred supplier in the area that is cheaper, we imagine this would be the council’s preference.

<b>Standard Estimate (80 Day Straight)</b>					
<b>MCKINLAY SHIRE COUNCIL</b>	<b>PROJECT NAME:</b>	<b>TENDER</b> Wills Development Road, Julia Creek			<b>9/04/2021</b>
QTY	DAYS / WKS	HRS	DESCRIPTION	UNIT PRICE	AMOUNT
<b>TRAFFIC MANAGEMENT ON SITE</b> (6.30am - 5.00pm "allow for site steep outside of scheduled working hours")					
8	80	0.5	Monday – Friday (Night Rate - First 8 hours)	\$ 52.52	\$ 16,806.40
8	80	7.5	Monday – Friday (Day Rate - First 8 hours)	\$ 35.86	\$ 172,128.00
8	80	2	Overtime T1.5	\$ 43.43	\$ 55,590.40
8	80	0.5	Overtime T2.0	\$ 58.58	\$ 18,745.60
4	80	10.5	Traffic Control Ute (Per Hour)	\$ 19.20	\$ 64,512.00
8	80		Daily Fare Allowance (Up to 1 hour each way)	\$ 30.30	\$ 19,392.00
8	80		Meal Allowance (After 9.5 hours)	\$ 20.20	\$ 12,928.00
1	112		Overnight Signage (per site)	\$ 100.00	\$ 11,200.00
<b>PROJECTS AND PLANNING</b> (plans and drawings)					
1			Traffic Management Plans	\$ 305.00	\$ 305.00
10			Traffic Guidance Scheme - Standard	\$ 105.00	\$ 1,050.00
<b>ACCOMMODATION FOR AWAY WORKS</b>					
8	16		Accommodation (per week)	\$ 660.00	\$ 84,480.00
8	80		Living Away Meals (if not provided by client)	\$ 97.50	\$ 780.00
<b>TRAVEL FOR AWAY WORKS</b> (8hrs travel start of project, 4 full rotations, 8hrs travel home end of project)					
Full rotation \$ referenced in methodology "Point 1"					
8	1	7	Monday – Friday (Day Rate - First 8 hours)	\$ 35.86	\$ 2,008.16
4	1	7	Traffic Control Ute (Per Hour)	\$ 19.20	\$ 537.60
8	1		Daily Fare Allowance (Up to 1 hour each way)	\$ 30.30	\$ 242.40
4	1		Full Roster Rotation	\$ 7,698.08	\$ 30,792.32
8	1	7	Monday – Friday (Day Rate - First 8 hours)	\$ 35.86	\$ 2,008.16
4	1	7	Traffic Control Ute (Per Hour)	\$ 19.20	\$ 537.60
8	1		Daily Fare Allowance (Up to 1 hour each way)	\$ 30.30	\$ 242.40
<b>ADDITIONAL EQUIPMENT</b>					
Full equipment \$ breakdown referenced in methodology "Point 2"					
1			Additional Equipment On-Charge	\$ 163,008.00	\$ 163,008.00
				<b>SUBTOTAL</b>	<b>\$657,294.04</b>
				<b>GST</b>	<b>\$65,729.40</b>
				<b>TOTAL including GST</b>	<b>\$723,023.44</b>

Stage Separation Estimate (Stage 1/2 & Stage 3/4)					
MCKINLAY SHIRE COUNCIL	PROJECT NAME:	TENDER Wills Development Road, Julia Creek			9/04/2021
QTY	DAYS / WKS	HRS	DESCRIPTION	UNIT PRICE	AMOUNT
<b>Stage 1 &amp; 2: TRAFFIC MANAGEMENT ON SITE (6.30am - 5.00pm)</b>					
8	45	0.5	Monday – Friday (Night Rate - First 8 hours)	\$ 52.52	\$ 9,453.60
8	45	7.5	Monday – Friday (Day Rate - First 8 hours)	\$ 35.86	\$ 96,822.00
8	45	2	Overtime T1.5	\$ 43.43	\$ 31,269.60
8	45	0.5	Overtime T2.0	\$ 58.58	\$ 10,544.40
4	45	10.5	Traffic Control Ute (Per Hour)	\$ 19.20	\$ 36,288.00
8	45		Daily Fare Allowance (Up to 1 hour each way)	\$ 30.30	\$ 10,908.00
8	45		Meal Allowance (After 9.5 hours)	\$ 20.20	\$ 7,272.00
1	63		Overnight Signage (per site)	\$ 100.00	\$ 6,300.00
<b>Stage 3 &amp; 4: TRAFFIC MANAGEMENT ON SITE (6.30am - 5.00pm)</b>					
6	35	0.5	Monday – Friday (Night Rate - First 8 hours)	\$ 52.52	\$ 5,514.60
6	35	7.5	Monday – Friday (Day Rate - First 8 hours)	\$ 35.86	\$ 56,479.50
6	35	2	Overtime T1.5	\$ 43.43	\$ 18,240.60
6	35	0.5	Overtime T2.0	\$ 58.58	\$ 6,150.90
3	35	10.5	Traffic Control Ute (Per Hour)	\$ 19.20	\$ 21,168.00
6	35		Daily Fare Allowance (Up to 1 hour each way)	\$ 30.30	\$ 6,363.00
6	35		Meal Allowance (After 9.5 hours)	\$ 20.20	\$ 4,242.00
1	49		Overnight Signage (per site)	\$ 100.00	\$ 4,900.00
<b>PROJECTS AND PLANNING (plans and drawings)</b>					
1			Traffic Management Plans	\$ 305.00	\$ 305.00
10			Traffic Guidance Scheme - Standard	\$ 105.00	\$ 1,050.00
<b>ACCOMMODATION FOR AWAY WORKS</b>					
8	16		Accommodation (per week)	\$ 660.00	\$ 84,480.00
8	80		Living Away Meals (if not provided by client)	\$ 97.50	\$ 780.00
<b>TRAVEL FOR AWAY WORKS (8hrs travel start of project, 4 full rotations, 8hrs travel home end of project)</b>					
Full rotation \$ referenced in methodology "Point 1"					
8	1	7	Monday – Friday (Day Rate - First 8 hours)	\$ 35.86	\$ 2,008.16
4	1	7	Traffic Control Ute (Per Hour)	\$ 19.20	\$ 537.60
8	1		Daily Fare Allowance (Up to 1 hour each way)	\$ 30.30	\$ 242.40
4	1		Full Roster Rotation	\$ 7,698.08	\$ 30,792.32
8	1	7	Monday – Friday (Day Rate - First 8 hours)	\$ 35.86	\$ 2,008.16
4	1	7	Traffic Control Ute (Per Hour)	\$ 19.20	\$ 537.60
8	1		Daily Fare Allowance (Up to 1 hour each way)	\$ 30.30	\$ 242.40
<b>ADDITIONAL EQUIPMENT</b>					
Full equipment \$ breakdown referenced in methodology "Point 2"					
1			Additional Equipment On-Charge	\$ 163,008.00	\$ 163,008.00
SUBTOTAL					\$617,907.84
GST					\$61,790.78
TOTAL including GST					\$679,698.62



<b>Cost Estimate For:</b> <b>McKinlay Shire Council</b>	<b>Estimate Number</b>	<b>1930</b>
	<b>Date</b>	<b>8/04/2021</b>

<b>Details</b>	Supply of Traffic Management for Will Development Rd Julia Creek. Estimate based on 1x full week. Estimate based on 3x Traffic Controllers + 3x Vehicles for 10 hrs per day Mon - Friday. Estimate based on Local Buy rates BUS-270				
<b>Item</b>	<b>Description</b>	<b>Unit</b>	<b>Unit \$</b>	<b>Qty</b>	<b>Subtotal</b>
1	Traffic Guidance Schemes	each	\$150.00	3	\$450.00
3	Travel Sunday - Weekend Rates	hr	\$62.00	7	\$1,302.00
1	Establishment	each	\$20.00	5	\$100.00
3	Travel Vehicle	hr	\$20.00	7.5	\$450.00
3	Traffic Control - 0-8 hrs	hr	\$36.00	40	\$4,320.00
3	Traffic Control 8-10 hrs	hr	\$52.00	7.5	\$1,170.00
3	Establishment	each	\$20.00	5	\$300.00
3	Vehicle	hr	\$20.00	50	\$3,000.00
3	LAFHA	each	\$80.00	7	\$1,680.00
3	Accommodation	each	\$125.00	7	\$2,625.00
3	Stand Down Weekend 4 hr per day - Includes weekend site checks	hr	\$62.00	8	\$1,488.00
3	Sets of Traffic Lights	week	\$550.00	1	\$1,650.00
6	temporay road lighting at each station	week	\$425.00	1	\$2,550.00
1	Mobilisation of Lighting - One way	each	\$2,950.00	1	\$2,950.00
<b>Total (exc GST)</b>					<b>\$24,035.00</b>

A2O Traffic Solutions thank you for the opportunity to produce this estimate of costs for your proposed works. If you have any questions, or require any clarity on th items listed above, please do not hesitate to contact our office.

'Never give safety a day off'

P: 4774 3369

F: 4774 3143

E: admin@a2otraffic.com.au

This cost estimate reflect the given quantities at the time of enquiry. If the quantities differ from the above noted quantities, the relevant Ratecard rates will apply on the individual unit charge rates. This estimate should not be considered as a set quotation or lump sum amount, but purely an estimate based on information available at the time of creation.

Please refer to the Full A2O Traffic Solutions Terms and Conditions for a full breakdown on our website, or available upon request.





## McKinlay Shire Council

### Request for :

---

#### **CN-16068 Supply of Base Aggregate**

VP reference Number : VP236447

Opens 31/Mar/21 : Closes 09/Apr/21 05:00 PM E. Australia Standard Time

Cut-off date for supplier queries : Friday 09/Apr/21 05:00 PM E. Australia Standard Time

This request is not finalized.

1 Supplier response as of the 13/Apr/21 12:45 PM

Request created by:

Cameron Scott (cameron.scott@mckinlay.qld.gov.au)

You have attached 4 documents to this request. You can find them in this zip file under '/RFXDocs/'

[McKinlay Shire Council](#)

## Details of the request

---

### CN-16068 Supply of Base Aggregate

<b>Estimated Value</b>	\$300,000 to 500,000 (hidden from suppliers)
<b>Budgeted Value</b>	Unknown

### Buyer Details

<b>Business:</b>	McKinlay Shire Council												
<b>Location:</b>	9 Coyne St Julia Creek 4823, Queensland, Australia												
<b>Web Site:</b>	<a href="https://www.mckinlay.qld.gov.au">https://www.mckinlay.qld.gov.au</a>												
<b>Business Overview:</b>	The Council exists to serve the interests of residents within the McKinlay Shire and is often the first point of call for those with a problem or query about local government services.  Our website provides a wealth of community information as well as information about McKinlay and details of town council activities. The site will continue to evolve as we make more information available. Please send us your comments via our contact page.												
<b>Contact:</b>	<table> <tr> <td><i>Contact Name:</i></td> <td>Cameron Scott</td> </tr> <tr> <td><i>Position:</i></td> <td>Director Engineering and Regulatory Services</td> </tr> <tr> <td><i>Main Phone:</i></td> <td>61747464213</td> </tr> <tr> <td><i>Mobile Phone:</i></td> <td>0427470009</td> </tr> <tr> <td><i>Email:</i></td> <td>cameron.scott@mckinlay.qld.gov.au</td> </tr> <tr> <td><i>Local Group:</i></td> <td>Engineering</td> </tr> </table>	<i>Contact Name:</i>	Cameron Scott	<i>Position:</i>	Director Engineering and Regulatory Services	<i>Main Phone:</i>	61747464213	<i>Mobile Phone:</i>	0427470009	<i>Email:</i>	cameron.scott@mckinlay.qld.gov.au	<i>Local Group:</i>	Engineering
<i>Contact Name:</i>	Cameron Scott												
<i>Position:</i>	Director Engineering and Regulatory Services												
<i>Main Phone:</i>	61747464213												
<i>Mobile Phone:</i>	0427470009												
<i>Email:</i>	cameron.scott@mckinlay.qld.gov.au												
<i>Local Group:</i>	Engineering												

### Dates:

<b>Can be responded between:</b>	31/Mar/21 and 09/Apr/21 05:00 PM E. Australia Standard Time
<b>Supplier query cut-off:</b>	Friday 09/Apr/21 05:00 PM (E. Australia Standard Time)
<b>Decision Date:</b>	23/Apr/21

## What's required

Dear Sir/ Madam,

Quotations are sought for the Supply Stabilisation and Additive Spreading Services for a Department of Transport and Main Roads (TMR) job to McKinlay Shire Council at Julia Creek.

The works are on the Wills Developmental Road (78A), (Ch. 0.74Km to Ch. 4.02Km) approximately 6 km west of Julia Creek and involve the Widening and Sealing of the road.

Works involve

- Shoulder widening with insitu Hydrated Lime Stabilisation of the subgrade.
- Gravel overlay of the existing road and shoulder widening, and cement stabilisation of this base layer (Half road at a time)
- Sealing of the base layer.
- Lot lengths are anticipated to be approximately 700 m long, and will be worked on in a "hit one, miss one, hit one " pattern.

Please consider the following when quoting

- Price is to include Delivery to site as per the schedule below.

- Material to be delivered into work area on site between 8:00 am and 3:00 pm on nominated days in quantities indicated below
- 40007.01 Type 3 Base, Subtype [2.2], Unbound pavement, [Full Width] – 3,220 m3 (Compacted)
- 40008.01 Type 3 Subbase, Subtype [2.2], Unbound pavement, [Widening] – 1,850 m3 (Compacted)

Indicative Delivery Program (To be Confirmed)

Week Day Shoulder Widening Quantity (m3 Compacted) Overlay Quantity (m3 Compacted)

Week 1 Friday 185 26/3/21

Week 2 Monday 185 29/3/21

Tuesday 185 30/3/21

Week 3 Monday 185 5/4/21

Tuesday 185 6/4/21

Week 4 Monday 185 12/4/21

Tuesday 185 13/4/21

Wednesday 185 14/4/21

Week 5 Monday 185 19/4/21

Tuesday 185 20/4/21

Wednesday 335 21/4/21

Thursday 335 22/4/21

Friday 335 23/4/21

Week 6 Monday 26/4/21

Tuesday 27/4/21

Wednesday 28/4/21

Thursday 29/4/21

Friday 30/4/21

Week 7 Monday 315 3/5/21

Tuesday 315 4/5/21

Wednesday 315 5/5/21

Thursday 6/5/21

Friday 7/5/21

Week 8 Monday 10/5/21

Tuesday 11/5/21

Wednesday 12/5/21

Thursday 13/5/21

Friday 330 14/5/21

Week 9 Monday 330 17/5/21

Tuesday 18/5/21

Wednesday 19/5/21

Thursday 20/5/21

Friday 21/5/21

Week 10 Monday 305 24/5/21

Tuesday 305 25/5/21

Technical specifications are contained in attachments

**The following supplier lists were selected**

1. Quarry Products, Geo, Landscaping (NQ) - LBR290 (Type: Pre-Qualified Suppliers, Contract Name/Number: LBR290)

**The following categories were selected**



**- Quarries**

1. Quarry Materials / Aggregates

**Suppliers notified of this request**

- 1 : BOLWARRA ENTERPRISES ta Wongabel Quarries Concrete via Quarry Products, Geo, Landscaping (NQ) - LBR290
- 2 : BORAL CONCRETE AND QUARRIES via Quarry Products, Geo, Landscaping (NQ) - LBR290
- 3 : CAMM QUARRIES PTY LTD via Quarry Products, Geo, Landscaping (NQ) - LBR290
- 4 : LD & LJ HILLERY PTY LIMITED via Quarry Products, Geo, Landscaping (NQ) - LBR290
- 5 : Qcrush Pty Ltd via Quarry Products, Geo, Landscaping (NQ) - LBR290
- 6 : Wagners Quarries Pty Ltd via Quarry Products, Geo, Landscaping (NQ) - LBR290 (has responded)

**Information requested by others**

None...

**Updates made to this request**

None...

## Response from:

---

Response ID: VPR418252

Created Date: Friday Fri/Apr/21 02:13 PM

Posted Date: Friday Fri/Apr/21 02:28 PM

Response reference: None provided

Response via: Quarry Products, Geo, Landscaping (NQ) - LBR290

---

**Business:** **Wagners Quarries Pty Ltd**  
**Validated Business Name:** WAGNERS QUARRIES PTY. LTD.  
**ABN** **80 092 751 669**  
**Location:** 339 Anzac Avenue  
Toowoomba  
4350, Queensland, Australia

**Contact:** *Contact Name:* Nicky Hansel  
*Position:* Tender Support  
*Main Phone:* 46377777  
*Mobile Phone:* None Provided  
*Email:* tenders@wagner.com.au

**Web Site:** <http://www.wagner.com.au>



**Description:**

Wagners is an Australian Company with a reputation for delivering high quality products and services internationally. Our focus is on cement, reinforcing steel, on site concrete supply, contract crushing and bulk transport, as well as lightweight composite fibre products. Wagners strives to find innovative, effective and economic solutions for our clients. Independently, each division of Wagners offers the quality assured specialised products and services required by national and international customers. These include on-site concrete batching plants, pre-cast concrete, contract crushing, quarry materials, reinforcing steel, bulk haulage transport, cement and flyash, composite products, civil works and project services.

Wagners expertise in remote and challenging site operations has led to the establishment of a large and successful project division. Over the past several years this division has completed contracts in the most remote parts of Australia as well as many countries around the world that have required well organised and detailed logistics to ensure satisfactory performance.

The company's Australian headquarters in Toowoomba, Queensland and Global Headquarters in Kuala Lumpur, Malaysia, provide an extensive network of Management, Operations, Financial, Legal and Administration staff to support Wagners operations worldwide.

Wagners Transport is committed to providing high level customer service and consistently reliable performance.

Wagners Transport has the capability to supply transportation solutions in all States of mainland Australia utilising modern vehicles and highly trained drivers.

Wagners have a modern fleet ranging from body trucks to triple trailer road trains which provide operational solutions for projects large and small.

Body trucks with varying payloads;

Single and multi-trailer combinations including body/dog, side tippers and flat top;

Heavy haulage capabilities using tri axle drop deck trailers, tri axle and quad floats and dolly combinations

Road Train configuration 48 - 62T capacity

Included in the fleet are quick release vehicles which can be utilised for concrete, quarrying and transport contracts in varying configurations dependent upon job type and client requirements.

Wagners Transport is NHVAS accredited and a member of the Mass Management and Maintenance Program.

All drivers are provided with ongoing training and are encouraged to develop and heighten their knowledge and awareness of the industry. The company's full time accredited Driver Trainers provide continual updates to drivers and ensure that they receive training in best practice operational processes and current legislative requirements.

**WORKSHOP AND SERVICES**

Wagners Head Office boasts a modern workshop facility which has the capacity to service the mechanical needs of the company's fleet. The workshop employs over 100 staff and operating a minimum of 16 hours per day.

The facility is made up of several sections including a heavy vehicle maintenance section which is used for maintenance and overhaul of the fleet of trucks and earthmoving equipment. Engineering and fabrication, provides us the ability to operate 24/7 if the need arises, to meet deadlines.

This is further enhanced by immediate access to heavy fabrication and surface finishing equipment. Our Industrial Blasting & Coating offers a large range of diverse protective coating to various specifications including automotive standards. We have a dedicated team for coating & blasting to ensure that we maintain our high quality in coating and blasting, and adhere to the delivery schedule.

Wagners workshop staff are skilled and experienced in a vast arrange of products and services. Our staff are able to adapt to different working environments from inside the workshop to a site on the other side of the country.

**Docs attached by the list admin to this supplier:**

None...

**Selection Status:**

Your decision                      Undecided

**Your personal notes:**

None added

**Your attachments to this response**

None provided

**Suppliers response:**

Good afternoon,

Thank you for the opportunity to price the supply of base aggregate requirements for the Department of Transport and Main Roads (TMR) job to McKinley Shire Council at Julia Creek.

Please find attached our rates for your consideration.

If you have any queries please do not hesitate to contact our office to discuss.

Thanks.

**Supplier provided pricing**

Price EXCLUDING Tax:	\$ 433,920.00 AUD
Tax component:	\$ 43,392.00 AUD
TOTAL PRICE:	\$ 477,312.00 AUD
These prices are:	Fixed
Comments:	Please see enclosed cover letter and rates for consideration.

**Invoicing Details**

If successful, the supplier will invoice with the following details

Business Name:	WAGNERS QUARRIES PTY. LTD.
Business Number:	80 092 751 669 (ABN)

**Additional Supplier Comments:**

Please refer to the attached cover letter.

**Suppliers Attachments**

The supplier has attached 1 document to this response. You can find it in this zip file under  
'/Responses/Wagners\_Quarries\_Pty/VPR418252/Response Docs/'



## McKinlay Shire Council

### Request for :

---

#### **CN -16068 Supply of Traffic Management Services**

VP reference Number : VP236506

Opens 31/Mar/21 : Closes 09/Apr/21 05:00 PM E. Australia Standard Time

Cut-off date for supplier queries : Friday 09/Apr/21 05:00 PM E. Australia Standard Time

This request is not finalized.

2 Supplier responses as of the 13/Apr/21 11:41 AM

Request created by:

Cameron Scott (cameron.scott@mckinlay.qld.gov.au)

You have attached 4 documents to this request. You can find them in this zip file under '/RFXDocs/'

[McKinlay Shire Council](#)

## Details of the request

---

### CN -16068 Supply of Traffic Management Services

<b>Estimated Value</b>	\$300,000 to 500,000 (hidden from suppliers)
<b>Budgeted Value</b>	Unknown

### Buyer Details

<b>Business:</b>	McKinlay Shire Council												
<b>Location:</b>	9 Coyne St Julia Creek 4823, Queensland, Australia												
<b>Web Site:</b>	<a href="https://www.mckinlay.qld.gov.au">https://www.mckinlay.qld.gov.au</a>												
<b>Business Overview:</b>	The Council exists to serve the interests of residents within the McKinlay Shire and is often the first point of call for those with a problem or query about local government services.  Our website provides a wealth of community information as well as information about McKinlay and details of town council activities. The site will continue to evolve as we make more information available. Please send us your comments via our contact page.												
<b>Contact:</b>	<table> <tr> <td><i>Contact Name:</i></td> <td>Cameron Scott</td> </tr> <tr> <td><i>Position:</i></td> <td>Director Engineering and Regulatory Services</td> </tr> <tr> <td><i>Main Phone:</i></td> <td>61747464213</td> </tr> <tr> <td><i>Mobile Phone:</i></td> <td>0427470009</td> </tr> <tr> <td><i>Email:</i></td> <td>cameron.scott@mckinlay.qld.gov.au</td> </tr> <tr> <td><i>Local Group:</i></td> <td>Engineering</td> </tr> </table>	<i>Contact Name:</i>	Cameron Scott	<i>Position:</i>	Director Engineering and Regulatory Services	<i>Main Phone:</i>	61747464213	<i>Mobile Phone:</i>	0427470009	<i>Email:</i>	cameron.scott@mckinlay.qld.gov.au	<i>Local Group:</i>	Engineering
<i>Contact Name:</i>	Cameron Scott												
<i>Position:</i>	Director Engineering and Regulatory Services												
<i>Main Phone:</i>	61747464213												
<i>Mobile Phone:</i>	0427470009												
<i>Email:</i>	cameron.scott@mckinlay.qld.gov.au												
<i>Local Group:</i>	Engineering												

### Dates:

<b>Can be responded between:</b>	31/Mar/21 and 09/Apr/21 05:00 PM E. Australia Standard Time
<b>Supplier query cut-off:</b>	Friday 09/Apr/21 05:00 PM (E. Australia Standard Time)
<b>Decision Date:</b>	23/Apr/21

## What's required

Dear Sir/ Madam,

Quotations are sought for the Supply of Traffic Management Services for a Department of Transport and Main Roads (TMR) job to McKinley Shire Council at Julia Creek.

The works are on the Wills Developmental Road (78A), (Ch. 0.74Km to Ch. 4.02Km) approximately 6 km west of Julia Creek and involve the Widening and Sealing of the road.

Works involve

- Shoulder widening with insitu Hydrated Lime Stabilisation of the subgrade.
- Gravel overlay of the existing road and shoulder widening, and cement stabilisation of this base layer (Half road at a time)
- Sealing of the base layer.
- Lot lengths are anticipated to be approximately 700 m long, and will be worked on in a "hit one, miss one, hit one " pattern.

Please quote the following requirements

- Supply of Traffic Management Plan (TMP), including Traffic Guidance Schemes (TGS) and risk assessments.

- Duration – Works are anticipated to take 80 calendar days to complete, please supply a daily rate inclusive of the following
  - o Accommodation – Quote is to include accommodation for all personnel
  - o Meals - Quote is to include all meals and allowances
  - o Travel – Quote is to include all travel to and from the worksite and location
- Hours of work are Monday to Friday 7:00 am to 5:00 pm – Traffic control is to be set up and removed outside of these hours
- Worksites – It is anticipated that there will be a maximum of three worksites on the job at any one time with traffic under single lane alternating flow
  - o During work hours
    - ? One will be under traffic lights
    - ? One or two will be under traffic controllers depending on the work cycle
  - o Outside of work hours
    - ? Between one to three sites under traffic lights
- Contractors are to conform with TMR, Australian Standards and relevant guidelines for traffic control particularly for
  - o Rest and relief of staff
  - o Recording and reporting
- Supply of vehicles, signage and delineation (witches hats, bollards etc to comply with TGS)
- Supply of three (3) sets of traffic Lights for overnight use, this also includes temporary street lighting to highlight the traffic signals.

**The following supplier lists were selected**

1. Road, Water, Sewerage & Civil Works - BUS270 (Type: Pre-Qualified Suppliers, Contract Name/Number: BUS270 (Local Buy))

**The following categories were selected**

- Road, Water, Sewerage, Civil Works - BUS270
  1. Traffic Management

**Suppliers notified of this request**

- 1 : A2O Traffic Solutions via Road, Water, Sewerage & Civil Works - BUS270 (has responded)
- 2 : CENTRAL WEST TRAFFIC CONTROL via Road, Water, Sewerage & Civil Works - BUS270
- 3 : Evolution Traffic Management Pty Ltd via Road, Water, Sewerage & Civil Works - BUS270 (has responded)

**Information requested by others**

None...

**Updates made to this request**

None...

## Response from:

---

Response ID: VPR417982

Created Date: Thursday Thu/Apr/21 02:36 PM

Posted Date: Thursday Thu/Apr/21 02:54 PM

Response reference: None provided

Response via: Road, Water, Sewerage & Civil Works - BUS270

---

**Business:** **A2O Traffic Solutions**  
**Validated Business Name:** ARID TO OASIS TRAFFIC SOLUTIONS PTY LTD  
**ABN** **48 133 998 740**  
**Location:** PO Box 747  
 Deeragun  
 4818, Queensland, Australia

**Contact:** *Contact Name:* James Bowe  
*Position:* Business Development Manager  
*Main Phone:* 0488 327 471  
*Mobile Phone:* 0488 627 471  
*Email:* j.bowe@a2otraffic.com.au



**Web Site:** <http://www.a2otraffic.com.au>  
**Description:** We are a North QLD owned and operated family business specializing in quality Traffic Management Solutions. We have a quality management team with head office in Townsville which support several regional depots throughout North QLD, currently Townsville, Cairns, Mackay and Cloncurry and soon to be Rockhampton, Bundaberg. We specialize in developing and Implementing quality Traffic Management Plans and Traffic Guidance schemes, major projects, Event Management and Traffic equipment Hire.

**Docs attached by the list admin to this supplier:** The following document(s) have been linked to this supplier by the Road, Water, Sewerage & Civil Works - BUS270 panel administrator.

- a2o traffic solutions bus270 pricing.xlsx (included)

Document(s) listed above that ARE INCLUDED in this zip file for this supplier can be found in the /Support Docs/ folder for this response.

---

### Selection Status:

Your decision Undecided

### Your personal notes:

None added

### Your attachments to this response

None provided



**Suppliers response:**

See attached Weekly cost estimate. Please note:

- \* 3x TGS's will not be a weekly cost
- \* Mobilisation of Lights are one way and wouldn't be a weekly cost however would be on the first and last week of job.
- \* 3x Traffic Control Vehicles have been allowed for to ensure enough signage is available to do 3x separate set ups at once.

**Supplier provided pricing**

Price EXCLUDING Tax:	\$ 19,333.00 AUD
Tax component:	\$ 193.30 AUD
TOTAL PRICE:	\$ 19,526.30 AUD
These prices are:	Estimated
Comments:	Estimate Based on a week, working hours only see rates and cost estimate attached. Excludes mobilisation of plant , TGS's Sunday Travel.

**Invoicing Details**

If successful, the supplier will invoice with the following details

Business Name:	ARID TO OASIS TRAFFIC SOLUTIONS PTY LTD
Business Number:	48 133 998 740 (ABN)

**Additional Supplier Comments:**

- \* Price Doesn't include sign posts , brackets and mounts
- \* Price does not include Bollards and bases if required
- \* Price is subject to availability of Traffic Lights and Temporary lighting at the time of booking.

**Suppliers Attachments**

The supplier has attached 2 documents to this response. You can find them in this zip file under '/Responses/A2O\_Traffic\_Solution/VPR417982/Response Docs/'

## Response from:

---

Response ID: VPR418383

Created Date: Friday Fri/Apr/21 03:59 PM

Posted Date: Friday Fri/Apr/21 04:04 PM

Response reference: None provided

Response via: Road, Water, Sewerage & Civil Works - BUS270

---

**Business:** Evolution Traffic Management Pty Ltd

**ABN** 82 638 495 691

**Location:** 572 Curtin Avenue East  
Eagle Farm  
4009, Queensland, Australia



**Contact:**

<i>Contact Name:</i>	Evolution Sales Team
<i>Position:</i>	Business Development
<i>Main Phone:</i>	07 3623 6422
<i>Mobile Phone:</i>	None Provided
<i>Email:</i>	sales@theevolutiongroup.com.au

**Web Site:** <http://www.theevolutiongroup.com.au>

**Description:** Evolution Traffic Management is part of the Evolution Road Maintenance Group, a public company with over 1,400 staff. The Group operates in the road corridor sector through four business units: 1) Traffic management services; 2) Specialist bridge maintenance and expansion joint maintenance through Evolution Civil Maintenance (formerly HMS Civils); 2) Fleet Management Services via Surefleet and 4) Training services in civil, traffic and safety training through our Registered Training Organisation, Evolution Training.

**Docs attached by the list admin to this supplier:** None...

**Compliance Details:**

*Type:* Product Liability Insurance  
*Policy/Doc #:* TC1911303  
*Coverage Value \$:* 50000000  
*Issued by :* Liberty Specialty Markets (Lloyds Syndicate 4472)  
*Expiry:* 31/Oct/21  
*Comments:* Not provided

*Type:* Public Liability Insurance  
*Policy/Doc #:* TC1911303  
*Coverage Value \$:* 50000000  
*Issued by :* Liberty Specialty Markets (Lloyds Syndicate 4472)  
*Expiry:* 31/Oct/21  
*Comments:* Not provided

*Type:* Workers Compensation Insurance  
*Policy/Doc #:* WSS200707727  
*Coverage Value \$:* 150000  
*Issued by :* WorkCover Queensland  
*Expiry:* 30/Sep/21  
*Comments:* Not provided

*Type:* Workplace Health & Safety (OHS/HSE) Policy  
*Policy/Doc #:* 0  
*Coverage Value \$:* 0  
*Issued by :* Evolution Group Holdings  
*Expiry:* Not applicable  
*Comments:* Not provided

**Selection Status:**

Your decision                      Undecided

**Your personal notes:**

None added

**Your attachments to this response**

None provided

**Suppliers response:**

Good Afternoon

Thank you for the opportunity to tender to McKinlay Shire Council for your upcoming project at Wills Development Rd,

Julia Creek on behalf of Evolution Traffic Management Pty Ltd.

Please find attached two estimated values with in our response reflecting both possible cost scenarios, as well as a detailed document containing information regarding methodology and overview notes.

Should you require any further information, please do not hesitate to contact me.

Kind Regards  
Chalyse Foster

0427 392 914 | 07 3623 6472 | chalyse.foster@theevolutiongroup.com.au

### Supplier provided pricing

Price EXCLUDING Tax:	\$ 617,907.84 AUD
Tax component:	\$ 61,790.78 AUD
TOTAL PRICE:	\$ 679,698.62 AUD
These prices are:	Estimated
Comments:	The above price is only estimated based on the information at our disposal. The submission also details an addition estimated total (the above references "Stage Separation Estimate").

### Invoicing Details

If successful, the supplier will invoice with the following details

Business Name:	EVOLUTION TRAFFIC MANAGEMENT PTY LTD
Business Number:	82 638 495 691 (ABN)

### Additional Supplier Comments:

Nil

### Suppliers Attachments

The supplier has attached 1 document to this response. You can find it in this zip file under '/Responses/Evolution\_Traffic\_Ma/VPR418383/Response Docs/'



## McKinlay Shire Council

### Request for :

---

#### **CN -16068 Supply of Sealing Services**

VP reference Number : VP236459

Opens 31/Mar/21 : Closes 09/Apr/21 05:00 PM E. Australia Standard Time

Cut-off date for supplier queries : Friday 09/Apr/21 05:00 PM E. Australia Standard Time

This request is not finalized.

2 Supplier responses as of the 13/Apr/21 12:20 PM

Request created by:

Cameron Scott (cameron.scott@mckinlay.qld.gov.au)

You have attached 7 documents to this request. You can find them in this zip file under '/RFXDocs/'

[McKinlay Shire Council](#)

## Details of the request

---

### CN -16068 Supply of Sealing Services

<b>Estimated Value</b>	\$300,000 to 500,000 (hidden from suppliers)
<b>Budgeted Value</b>	Unknown

### Buyer Details

<b>Business:</b>	McKinlay Shire Council												
<b>Location:</b>	9 Coyne St Julia Creek 4823, Queensland, Australia												
<b>Web Site:</b>	<a href="https://www.mckinlay.qld.gov.au">https://www.mckinlay.qld.gov.au</a>												
<b>Business Overview:</b>	The Council exists to serve the interests of residents within the McKinlay Shire and is often the first point of call for those with a problem or query about local government services.  Our website provides a wealth of community information as well as information about McKinlay and details of town council activities. The site will continue to evolve as we make more information available. Please send us your comments via our contact page.												
<b>Contact:</b>	<table> <tr> <td><i>Contact Name:</i></td> <td>Cameron Scott</td> </tr> <tr> <td><i>Position:</i></td> <td>Director Engineering and Regulatory Services</td> </tr> <tr> <td><i>Main Phone:</i></td> <td>61747464213</td> </tr> <tr> <td><i>Mobile Phone:</i></td> <td>0427470009</td> </tr> <tr> <td><i>Email:</i></td> <td>cameron.scott@mckinlay.qld.gov.au</td> </tr> <tr> <td><i>Local Group:</i></td> <td>Engineering</td> </tr> </table>	<i>Contact Name:</i>	Cameron Scott	<i>Position:</i>	Director Engineering and Regulatory Services	<i>Main Phone:</i>	61747464213	<i>Mobile Phone:</i>	0427470009	<i>Email:</i>	cameron.scott@mckinlay.qld.gov.au	<i>Local Group:</i>	Engineering
<i>Contact Name:</i>	Cameron Scott												
<i>Position:</i>	Director Engineering and Regulatory Services												
<i>Main Phone:</i>	61747464213												
<i>Mobile Phone:</i>	0427470009												
<i>Email:</i>	cameron.scott@mckinlay.qld.gov.au												
<i>Local Group:</i>	Engineering												

### Dates:

<b>Can be responded between:</b>	31/Mar/21 and 09/Apr/21 05:00 PM E. Australia Standard Time
<b>Supplier query cut-off:</b>	Friday 09/Apr/21 05:00 PM (E. Australia Standard Time)
<b>Decision Date:</b>	23/Apr/21

## What's required

Dear Sir/ Madam,

Quotations are sought for the Supply of Sealing Services for a Department of Transport and Main Roads (TMR) job to McKinley Shire Council at Julia Creek.

The works are on the Wills Developmental Road (78A), (Ch. 0.74Km to Ch. 4.02Km) approximately 6 km west of Julia Creek and involve the Widening and Sealing of the road.

Works involve

- Shoulder widening with insitu Hydrated Lime Stabilisation of the subgrade.
- Gravel overlay of the existing road and shoulder widening, and cement stabilisation of this base layer (Half road at a time)
- Sealing of the base layer.
- Lot lengths are anticipated to be approximately 700 m long, and will be worked on in a "hit one, miss one, hit one " pattern.

Please quote the following requirements

- Seven (7) Establishments to site, inclusive of accommodation and travel costs, full service including sweeping and rolling.

- Supply of cover aggregate [precoated], [10mm] nominal size – 219 m<sup>3</sup>
- Supply of cover aggregate [precoated], [14mm] nominal size – 392 m<sup>3</sup>
- Spraying bituminous material, treatment type [Seal], binder [C170], spray rate [1.5L/m<sup>2</sup>], including supply of binder, excluding supply of additives, (all sections) – 39,360 litres
- Spraying bituminous material, treatment type [Primerseal], binder [AMC7], spray rate [1.9L/m<sup>2</sup>], including supply of binder, excluding supply of additives,(all sections) – 66,000 litres
- Spreading cover aggregate [10mm], [120m<sup>2</sup>/m<sup>3</sup>], [excluding] supply of cover aggregate, [Seal] – 219 m<sup>3</sup>
- Spreading cover aggregate [14mm], [90m<sup>2</sup>/m<sup>3</sup>], [excluding] supply of cover aggregate, [Primerseal] – 392 m<sup>3</sup>
- Supply and addition of adhesion agent (Provisional Quantity) – 600 litres

Traffic Control and Water Cart will be provided on site.

Indicative Delivery (to be confirmed) program is

- 1 Week 1 Wednesday AMC7 – 9,450 L
- 2 Week 2 Wednesday AMC7 – 6,300 L
- 3 Week 6 Monday AMC7 – 15,050 L
- 4 Week 7 Friday AMC7 – 15,050 L
- 5 Week 9 Monday AMC7 – 10,033 L
- 6 Week 10 Monday AMC7 – 10,033 L
- 7 Week 12 Monday C170 – 39,360 L

### **The following supplier lists were selected**

1. Road, Water, Sewerage & Civil Works - BUS270 (Type: Pre-Qualified Suppliers, Contract Name/Number: BUS270 (Local Buy))

### **The following categories were selected**

#### **- Road, Water, Sewerage, Civil Works - BUS270**

1. Road Resurfacing

### **Suppliers notified of this request**

- 1 : Boral Resources (Qld) Pty Ltd via Road, Water, Sewerage & Civil Works - BUS270
- 2 : Fulton Hogan via Road, Water, Sewerage & Civil Works - BUS270
- 3 : Pioneer North Queensland Pty Ltd via Road, Water, Sewerage & Civil Works - BUS270
- 4 : RPQ Spray Seal Pty Ltd via Road, Water, Sewerage & Civil Works - BUS270 (has responded)
- 5 : Stabilised Pavements of Australia Pty Ltd via Road, Water, Sewerage & Civil Works - BUS270 (has responded)

### **Information requested by others**

None...

### **Updates made to this request**

None...

## Response from:

---

Response ID: VPR417767

Created Date: Wednesday Wed/Apr/21 05:12 PM

Posted Date: Wednesday Wed/Apr/21 05:14 PM

Response reference: None provided

Response via: Road, Water, Sewerage & Civil Works - BUS270

---

**Business:** **Stabilised Pavements of Australia Pty Ltd**  
**Validated Business Name:** STABILISED PAVEMENTS OF AUSTRALIA PTY. LIMITED  
**ABN** **90 002 900 736**  
**Location:** 17 Titanium Pl  
 Mount St John  
 4818, Queensland, Australia

**Contact:** *Contact Name:* Matthew Devine  
*Position:* Regional Engineer  
*Main Phone:* +61 7 4412 0100  
*Mobile Phone:* None Provided  
*Email:* mdevine@stabilis.com.au

**Web Site:** <http://www.stabilisedpavements.com.au/>  
**Description:** We specialise in in situ stabilisation, profiling, civil construction, bitumen sealing & concreting. We have internal design capabilities to help service client's needs

**Docs attached by the list admin to this supplier:** None...

---



### Selection Status:

Your decision Undecided

### Your personal notes:

None added

### Your attachments to this response

None provided

### Suppliers response:

SPA quote T4243

### Supplier provided pricing

Price EXCLUDING Tax:	\$ 356,195.87 AUD
Tax component:	\$ 35,619.59 AUD
<b>TOTAL PRICE:</b>	<b>\$ 391,815.46 AUD</b>



These prices are: Estimated  
Comments: Not provided.

## Invoicing Details

If successful, the supplier will invoice with the following details

Business Name: STABILISED PAVEMENTS OF AUSTRALIA PTY. LIMITED  
Business Number: 90 002 900 736 (ABN)

## Suppliers Attachments

The supplier has attached 1 document to this response. You can find it in this zip file under  
'Responses/Stabilised\_Pavements/VPR417767/Response Docs/'

## Response from:

---

Response ID: VPR418253

Created Date: Friday Fri/Apr/21 12:50 PM

Posted Date: Friday Fri/Apr/21 12:56 PM

Response reference: None provided

Response via: Road, Water, Sewerage & Civil Works - BUS270

---

**Business:** **RPQ Spray Seal Pty Ltd**

**Validated Business Name:** RPQ SPRAY SEAL PTY. LTD.

**ABN** **30 113 612 098**

**Location:** 181 Enterprise St  
Bohle  
4818, Queensland, Australia

**Contact:** *Contact Name:* Susan Meredith  
*Position:* Operations Coordinator  
*Main Phone:* +61 07 4774 4400  
*Mobile Phone:* 0418777152  
*Email:* susan.meredith@rpq.com.au

**Web Site:** <https://www.rpq.com.au>

**Description:** Bitumen & Asphalt Contractor

**Docs attached by the list admin to this supplier:** None...

**Compliance Details:**

<i>Type:</i>	Product Liability Insurance
<i>Policy/Doc #:</i>	1811089-14569
<i>Coverage Value \$:</i>	20,000,000
<i>Issued by :</i>	HDI Global SE, Australia & QBE UK Limited
<i>Expiry:</i>	31/Oct/21
<i>Comments:</i>	Not provided
<i>Type:</i>	Public Liability Insurance
<i>Policy/Doc #:</i>	1811089-14569
<i>Coverage Value \$:</i>	20,000,000
<i>Issued by :</i>	HDI Global SE, Australia & QBE UK Limited
<i>Expiry:</i>	31/Oct/21
<i>Comments:</i>	Not provided
<i>Type:</i>	Workers Compensation Insurance
<i>Policy/Doc #:</i>	WAD080294798
<i>Coverage Value \$:</i>	Not provided
<i>Issued by :</i>	WorkCover Queensland
<i>Expiry:</i>	30/Sep/21
<i>Comments:</i>	Not provided
<i>Type:</i>	Workplace Health & Safety (OHS/HSE) Policy
<i>Policy/Doc #:</i>	Not provided
<i>Coverage Value \$:</i>	Not provided
<i>Issued by :</i>	General Manager
<i>Expiry:</i>	Not applicable
<i>Comments:</i>	Not provided

---

**Selection Status:**

Your decision                      Undecided

**Your personal notes:**

None added

**Your attachments to this response**

None provided

**Suppliers response:**

RPQ Spray Seal Response attached. Please note as per TMR specification Bitumen is subject to Rise and Fall.

**Supplier provided pricing**

Price EXCLUDING Tax:	\$ 334,779.62 AUD
Tax component:	\$ 33,477.96 AUD
TOTAL PRICE:	\$ 368,257.58 AUD
These prices are:	Estimated
Comments:	Not provided.

**Invoicing Details**

If successful, the supplier will invoice with the following details

Business Name:	RPQ SPRAY SEAL PTY. LTD.
Business Number:	30 113 612 098 (ABN)

**Suppliers Attachments**

The supplier has attached 1 document to this response. You can find it in this zip file under  
'/Responses/RPQ\_Spray\_Seal\_Pty\_L/VPR418253/Response Docs/'



## McKinlay Shire Council

### Request for :

---

#### **CN - 16068 Stabilisation and Additive Spreading Services**

VP reference Number : VP236501

Opens 31/Mar/21 : Closes 09/Apr/21 05:00 PM E. Australia Standard Time

Cut-off date for supplier queries : Friday 09/Apr/21 05:00 PM E. Australia Standard Time

This request is not finalized.

4 Supplier responses as of the 13/Apr/21 11:58 AM

Request created by:

Cameron Scott (cameron.scott@mckinlay.qld.gov.au)

You have attached 4 documents to this request. You can find them in this zip file under '/RFXDocs/'

[McKinlay Shire Council](#)

## Details of the request

---

### CN - 16068 Stabilisation and Additive Spreading Services

<b>Estimated Value</b>	\$500,000 to 1M (hidden from suppliers)
<b>Budgeted Value</b>	Unknown

### Buyer Details

<b>Business:</b>	McKinlay Shire Council												
<b>Location:</b>	9 Coyne St Julia Creek 4823, Queensland, Australia												
<b>Web Site:</b>	<a href="https://www.mckinlay.qld.gov.au">https://www.mckinlay.qld.gov.au</a>												
<b>Business Overview:</b>	The Council exists to serve the interests of residents within the McKinlay Shire and is often the first point of call for those with a problem or query about local government services.  Our website provides a wealth of community information as well as information about McKinlay and details of town council activities. The site will continue to evolve as we make more information available. Please send us your comments via our contact page.												
<b>Contact:</b>	<table> <tr> <td><i>Contact Name:</i></td> <td>Cameron Scott</td> </tr> <tr> <td><i>Position:</i></td> <td>Director Engineering and Regulatory Services</td> </tr> <tr> <td><i>Main Phone:</i></td> <td>61747464213</td> </tr> <tr> <td><i>Mobile Phone:</i></td> <td>0427470009</td> </tr> <tr> <td><i>Email:</i></td> <td>cameron.scott@mckinlay.qld.gov.au</td> </tr> <tr> <td><i>Local Group:</i></td> <td>Engineering</td> </tr> </table>	<i>Contact Name:</i>	Cameron Scott	<i>Position:</i>	Director Engineering and Regulatory Services	<i>Main Phone:</i>	61747464213	<i>Mobile Phone:</i>	0427470009	<i>Email:</i>	cameron.scott@mckinlay.qld.gov.au	<i>Local Group:</i>	Engineering
<i>Contact Name:</i>	Cameron Scott												
<i>Position:</i>	Director Engineering and Regulatory Services												
<i>Main Phone:</i>	61747464213												
<i>Mobile Phone:</i>	0427470009												
<i>Email:</i>	cameron.scott@mckinlay.qld.gov.au												
<i>Local Group:</i>	Engineering												

### Dates:

<b>Can be responded between:</b>	31/Mar/21 and 09/Apr/21 05:00 PM E. Australia Standard Time
<b>Supplier query cut-off:</b>	Friday 09/Apr/21 05:00 PM (E. Australia Standard Time)
<b>Decision Date:</b>	23/Apr/21

## What's required

Dear Sir/ Madam,

Quotations are sought for the Supply Stabilisation and Additive Spreading Services for a Department of Transport and Main Roads (TMR) job to McKinlay Shire Council at Julia Creek.

The works are on the Wills Developmental Road (78A), (Ch. 0.74Km to Ch. 4.02Km) approximately 6 km west of Julia Creek and involve the Widening and Sealing of the road.

Works involve

- Shoulder widening with insitu Hydrated Lime Stabilisation of the subgrade.
- Gravel overlay of the existing road and shoulder widening, and cement stabilisation of this base layer (Half road at a time)
- Sealing of the base layer.
- Lot lengths are anticipated to be approximately 700 m long, and will be worked on in a "hit one, miss one, hit one " pattern.

Please consider the following when quoting

- Typical Activities

- o 40110.01 – In-situ stabilisation using Quicklime or Hydrated Lime (Widening) – 15,088 m<sup>2</sup>
  - o 40111.01 – Supply of stabilising agent (Widening, 200mm depth) (3%) – 172 tonnes
  - o 40209.01 – Pulverisation prior to insitu stabilisation [base] – 26,240 m<sup>2</sup>
  - o 40214.01 – Insitu stabilisation using cement or cementitious blends [2% GB cement,200mm Base] – 26,240 m<sup>2</sup>
  - o 40215.01 – Supply of stabilising agent [GB cement,200mm Base] – 220 tonnes
  - Consideration should be given for a Site Tanker to be provided on site for spreader truck
  - Maintenance of equipment is considered the subcontractors responsibility (Including changing teeth and blocks) and will not be paid for as a working day if performed on a standdown day.
  - Anticipated Work Cycles (to be confirmed)
- Week 1 Use of Stabiliser to box out shoulders & Lime Stabilisation Monday, Tuesday, Wednesday
- Week 2 Use of Stabiliser to box out shoulders & Lime Stabilisation Wednesday, Thursday
- Week 3 Use of Stabiliser to box out shoulders & Lime Stabilisation Wednesday, Thursday, Friday
- Week 4 Use of Stabiliser to box out shoulders & Lime Stabilisation Thursday, Friday
- Week 5
- Week 6 Cement Stabilise Base Layer Monday, Tuesday, Wednesday
- Week 7 Cement Stabilise Base Layer Thursday, Friday
- Week 8 Cement Stabilise Base Layer Monday
- Week 9 Cement Stabilise Base Layer Tuesday, Wednesday
- Week 10 Cement Stabilise Base Layer Wednesday, Thursday

Quote is to include

- Daily Working Rate (Approximately 20 days, or parts thereof), inclusive of
  - o Teeth and blocks (Machine is to start on site and leave site with new teeth and blocks)
  - o Supervisor and Operators
  - o Accommodation and Travel
  - o Establishment/ Disestablishment to/ from site
- Daily Stand Down Rate (approximately 29 days, that is a day where the machine is not required to be used on site), inclusive of all relevant costs
- 40111.01 – Supply of stabilising agent (Widening, 200mm depth) (3%) – 172 tonnes (includes site tanker), Provisional as this may be Principal supplied
- 40215.01 – Supply of stabilising agent [GB cement,200mm Base] – 220 tonnes (includes site tanker), Provisional as this may be Principal supplied

### **The following supplier lists were selected**

1. Road, Water, Sewerage & Civil Works - BUS270 (Type: Pre-Qualified Suppliers, Contract Name/Number: BUS270 (Local Buy))

### **The following categories were selected**

#### **- Road, Water, Sewerage, Civil Works - BUS270**

1. Road Construction & Maintenance

### **Suppliers notified of this request**

- 1 : Downer Road Services via Road, Water, Sewerage & Civil Works - BUS270
- 2 : Milray Contracting Pty Ltd via Road, Water, Sewerage & Civil Works - BUS270 (has responded)
- 3 : Robinson Civil Group (RCG) via Road, Water, Sewerage & Civil Works - BUS270 (has responded)
- 4 : SAT Civil a Division of Hiway Stabilizers via Road, Water, Sewerage & Civil Works - BUS270 (has responded)

5 : Stabilised Pavements of Australia Pty Ltd via Road, Water, Sewerage & Civil Works - BUS270 (has responded)

### **Information requested by others**

None...

### **Updates made to this request**

None...

## Response from:

---

Response ID: VPR418125  
 Created Date: Friday Fri/Apr/21 08:17 AM  
 Posted Date: Friday Fri/Apr/21 08:22 AM  
 Response reference: None provided  
 Response via: Road, Water, Sewerage & Civil Works - BUS270

---

**Business:** **SAT Civil a Division of Hiway Stabilizers**

**Validated Business Name:** HIWAY STABILIZERS AUSTRALIA PTY. LTD.

**ABN** **40 150 650 150**

**Location:** 503 Sandy Creek Road  
 Josephville  
 4285, Queensland, Australia

**Contact:** *Contact Name:* Jan Weinert  
*Position:* General Manager  
*Main Phone:* 07 55410057  
*Mobile Phone:* None Provided  
*Email:* jan@satcivil.com.au



**Web Site:** <http://www.satcivil.com.au>

**Description:** SAT Civil a Division of Hiway Stabilizers is a specialised task contractor concentrating on road recycling, in the areas of Hot In Place Asphalt Recycling (HIPAR), Cold In-situ Stabilisation of pavements and Dry Matting (rectification of Bleeding Seals).

**Docs attached by the list admin to this supplier:** None...

---

### Selection Status:

Your decision Undecided

### Your personal notes:

None added

### Your attachments to this response

None provided

### Suppliers response:

RE: CN- 16068 STABILISATION AND ADDITIVE SPREADING SERVICES

Thank you for inviting SAT Civil a Division of Hiway Stabilizers Australia Pty Ltd to quote on the supply of a stabiliser, a spreader truck, binders and operators to carry out the works on the above project.



## Supplier provided pricing

Price EXCLUDING Tax:	\$ 0.01 AUD
Tax component:	\$ 0.00 AUD
TOTAL PRICE:	\$ 0.01 AUD
These prices are:	Estimated
Comments:	Please refer to our quote attached

## Invoicing Details

If successful, the supplier will invoice with the following details

Business Name:	HIWAY STABILIZERS AUSTRALIA PTY. LTD.
Business Number:	40 150 650 150 (ABN)

## Suppliers Attachments

The supplier has attached 1 document to this response. You can find it in this zip file under  
'/Responses/SAT\_Civil\_a\_Division/VPR418125/Response Docs/'

## Response from:

---

Response ID: VPR418219

Created Date: Friday Fri/Apr/21 11:56 AM

Posted Date: Friday Fri/Apr/21 11:57 AM

Response reference: None provided

Response via: Road, Water, Sewerage & Civil Works - BUS270

---

**Business:** **Stabilised Pavements of Australia Pty Ltd**  
**Validated Business Name:** STABILISED PAVEMENTS OF AUSTRALIA PTY. LIMITED  
**ABN** **90 002 900 736**  
**Location:** 17 Titanium Pl  
 Mount St John  
 4818, Queensland, Australia

**Contact:** *Contact Name:* Matthew Devine  
*Position:* Regional Engineer  
*Main Phone:* +61 7 4412 0100  
*Mobile Phone:* None Provided  
*Email:* mdevine@stabilis.com.au

**Web Site:** <http://www.stabilisedpavements.com.au/>  
**Description:** We specialise in in situ stabilisation, profiling, civil construction, bitumen sealing & concreting. We have internal design capabilities to help service client's needs

**Docs attached by the list admin to this supplier:** None...

---



### Selection Status:

Your decision Undecided

### Your personal notes:

None added

### Your attachments to this response

None provided

### Suppliers response:

SPA quote T4244

### Supplier provided pricing

Price EXCLUDING Tax:	\$ 406,495.00 AUD
Tax component:	\$ 40,649.50 AUD
<b>TOTAL PRICE:</b>	<b>\$ 447,144.50 AUD</b>

These prices are: Estimated  
Comments: Not provided.

## Invoicing Details

If successful, the supplier will invoice with the following details

Business Name: STABILISED PAVEMENTS OF AUSTRALIA PTY. LIMITED  
Business Number: 90 002 900 736 (ABN)

## Suppliers Attachments

The supplier has attached 1 document to this response. You can find it in this zip file under  
'Responses/Stabilised\_Pavements/VPR418219/Response Docs/'

## Response from:

---

Response ID: VPR418372

Created Date: Friday Fri/Apr/21 03:45 PM

Posted Date: Friday Fri/Apr/21 04:25 PM

Response reference: None provided

Response via: Road, Water, Sewerage & Civil Works - BUS270

---

**Business:** **Milray Contracting Pty Ltd**

**ABN** **52 133 500 937**

**Location:** 64 Broughton Road  
Charters Towers City  
4820, Queensland, Australia

**Contact:**

<i>Contact Name:</i>	Jean Halstead
<i>Position:</i>	None Provided
<i>Main Phone:</i>	07 4787 8366
<i>Mobile Phone:</i>	None Provided
<i>Email:</i>	jean.halstead@milray.com.au

**Web Site:** None provided

**Description:** Milray Contracting has highly experienced staff with a wide range of civil, rail, water, sewerage, mining and port experience with capabilities including:

- Road construction
- Drainage and causeway construction
- Road maintenance
- Road and flood damage repairs
- Mining rehabilitation and Construction
- In-situ stabilisation
- Crushing and Screening
- Transportation of raw materials
- Maintenance, repairs and fabrication workshop and field crews
- Rural services including fencing & stockyard construction, grids, fire breaks, access roads
- Construction, servicing and rehabilitation of remote drill sites
- Power line corridor maintenance

**Docs attached by the list admin to this supplier:** None...

**Compliance Details:**

*Type:* Product Liability Insurance  
*Policy/Doc #:* 44190956  
*Coverage Value \$:* 20000000  
*Issued by :* NTI  
*Expiry:* 30/Oct/21  
*Comments:* Not provided

*Type:* Public Liability Insurance  
*Policy/Doc #:* 44190956  
*Coverage Value \$:* 20000000  
*Issued by :* NTI  
*Expiry:* 30/Oct/21  
*Comments:* Not provided

*Type:* Workers Compensation Insurance  
*Policy/Doc #:* WHA081000747  
*Coverage Value \$:* Not provided  
*Issued by :* WorkCover Queensland  
*Expiry:* 30/Sep/21  
*Comments:* Not provided

*Type:* Workplace Health & Safety (OHS/HSE) Policy  
*Policy/Doc #:* Not provided  
*Coverage Value \$:* Not provided  
*Issued by :* Milray Contracting  
*Expiry:* Not applicable  
*Comments:* Not provided

**Selection Status:**

Your decision Undecided

**Your personal notes:**

None added

**Your attachments to this response**

None provided

**Suppliers response:**

Please find attached the quotation for CN-16068 Stabilisation and Additive Spreading Services

**Supplier provided pricing**

Price EXCLUDING Tax: \$ 23,335.00 AUD  
 Tax component: \$ 2,333.50 AUD  
 TOTAL PRICE: \$ 25,668.50 AUD  
 These prices are: Estimated

Comments: Not provided.

## Invoicing Details

If successful, the supplier will invoice with the following details

Business Name: Milray Contracting Pty Ltd  
Business Number: 52 133 500 937 (ABN)

## Suppliers Attachments

The supplier has attached 1 document to this response. You can find it in this zip file under  
'Responses/Milray\_Contracting\_P/VPR418372/Response Docs/'

## Response from:

---

Response ID: VPR418379

Created Date: Friday Fri/Apr/21 03:56 PM

Posted Date: Friday Fri/Apr/21 03:58 PM

Response reference: None provided

Response via: Road, Water, Sewerage & Civil Works - BUS270

---

**Business:** **Robinson Civil Group (RCG)**  
**ABN** **79 120 596 581**  
**Location:** 6 Elms Rd  
 Wondecla  
 4887, Queensland, Australia

**Contact:** *Contact Name:* Robinson Civil  
*Position:* Operations Manager  
*Main Phone:* 0740962399  
*Mobile Phone:* 0448014980  
*Email:* admin@robinsoncivil.com.au



**Web Site:** <http://www.robinsoncivil.com.au>

**Description:** Robinson Civil Group is a Far North Queensland firm undertaking civil works for the preceding 36 years. Key operational benefits provided by this organisation are;

- ?High quality works utilising the latest in technology
- ?Extensive technical and operational knowledge
- ?Effective determination and delivery of client requirements
- ?Highly skilled and experienced work teams
- ?Flexible working methodologies and hours to meet client requirements
- ?Ability to undertake works within given time frames

Robinson Civil Group operates under a 3rd party certified (by SAI Global) Integrated Management System

**Docs attached by the list admin to this supplier:** None...

**Compliance Details:**

*Type:* Product Liability Insurance  
*Policy/Doc #:* Policy AP-107236-R  
*Coverage Value \$:* \$20,000,000  
*Issued by :* Mecon Insurance Pty Ltd  
*Expiry:* 30/Jun/21  
*Comments:* Not provided

*Type:* Public Liability Insurance  
*Policy/Doc #:* Policy AP-107236-R  
*Coverage Value \$:* \$20,000,000  
*Issued by :* Mecon Insurance Pty Ltd  
*Expiry:* 30/Jun/21  
*Comments:* Not provided

*Type:* Workers Compensation Insurance  
*Policy/Doc #:* WAA060952028  
*Coverage Value \$:* Not provided  
*Issued by :* WorkCover Queensland  
*Expiry:* 30/Sep/21  
*Comments:* Not provided

*Type:* Workplace Health & Safety (OHS/HSE) Policy  
*Policy/Doc #:* HSM40005  
*Coverage Value \$:* Not provided  
*Issued by :* SAI Global  
*Expiry:* 14/Sep/21  
*Comments:* Not provided

**Selection Status:**

Your decision Undecided

**Your personal notes:**

None added

**Your attachments to this response**

None provided

**Suppliers response:**

Please see attached quote as per your request

**Supplier provided pricing**



Price EXCLUDING Tax: \$ 1.00 AUD  
Tax component: \$ 0.00 AUD  
TOTAL PRICE: \$ 1.00 AUD  
These prices are: Estimated  
Comments: please refer to attached quote for pricing

## Invoicing Details

If successful, the supplier will invoice with the following details

Business Name: Robinson Civil Group (RCG)  
Business Number: 79 120 596 581 (ABN)

## Suppliers Attachments

The supplier has attached 1 document to this response. You can find it in this zip file under  
'/Responses/Robinson\_Civil\_Group/VPR418379/Response Docs/'



Special Meeting of Council Thursday 15<sup>th</sup> April 2021

**4.3 Subject:** Tender T2021004-Design and Construct Modular House Julia Creek  
**Attachments:** 4.3.1 Tender Evaluation Report -MAL Engineers (Infoxpert ID: 115320)  
**Author:** Director Engineering and Regulatory Services  
**Date:** 14<sup>th</sup> April 2021

---

**Executive Summary:**

Council tendered out the Design and Construct Modular House Julia Creek, with a view to placing a house on the recently purchased 71 Coyne St vacant lot. A conforming tender and a non-conforming tender were received from Asset Cabins and Homes.

**Recommendation:**

*That Council resolves to:*

- a. *Accept the non conforming tender from Asset Cabins and Homes for \$315,000 Excluding GST and;*
- b. *Delegates the Chief Executive Officer to negotiate or vary the contract as required.*

**Background:**

Council purchased 71 Coyne St with a view to increasing Council controlled housing stocks. A review of Council's Works 4Qld program revealed some savings and a redundant project. The funds were proposed as a variation to the program so as to allow the construction of a house on 71 Coyne St.

This variation has been approved. Council with the assistance of MAL Engineers has put out Tender T2021004 Design and Construct Modular House Julia Ck. Funding timelines make the project tight, works must be completed by 30<sup>th</sup> June 2021. This has been communicated in the tender documents.

Asset Cabins and Homes provided the following tenders:

- Conforming- \$336,000 Ex GST, Practical completion September 2021
- Non-Conforming- \$315,000 Ex GST, Practical completion June 2021

MAL Engineers tender evaluation report is attached. This report recommends accepting the non conforming tender.

**Consultation:** (internal/External)

Internal: Chief Executive Officer; Director Corporate and Community Services; External: Michael Lancini (MAL Engineers)

**Legal Implications:**

Nil



Special Meeting of Council Thursday 15<sup>th</sup> April 2021

**Policy Implications:**

Complies with Procurement policy

**Financial and Resource Implications:**

Works funded through Works4Qld Program (\$310,721). Noting also that sewer, water and power connections are required (estimated\$20,000). This could be funded in 2021/2022.

**InfoXpert Document ID:**

115321



Our Ref : Q21044-01

Contact: Michael Lancini

13<sup>th</sup> April 2021

McKinlay Shire Council  
PO Box 177  
Julia Creek

Attention: Cameron Scott

Dear Cameron

**MAL Engineers Pty Ltd**  
ABN 3063 6773 781

Unit 2/112 Mulgrave Road  
Cairns QLD 4870  
Australia

**Phone: 61 400748070**

Michael.lancini@malengineers.com.au

## **RECOMMENDATION FOR MCKINLAY SHIRE COUNCIL DESIGN AND CONSTRUCTION OF A MODULAR / KIT HOME PROJECT IN JULIA CREEK (CONTRACT NO: T2021004)**

### **1 Background**

The McKinlay Shire Council is wishing to engage a suitably qualified and professional organisation to design, supply and construct a new residence in Julia Creek. The residence is proposed to be either a modular or kit home.

MAL Engineers have been engaged by McKinlay Shire Council to Project Manage the Design and Construction of the new Modular/Kit home project. The project proposes the supply and construction/installation of a new residence in Julia Creek.

### **2 Project Location**

The home shall be located on 71 Coyne Street Julia Creek, Lot 43 on JC55713. The site locality is shown below.



**Figure 1: Project's Locality within Julia Creek, Queensland**

### **3 Project Budget**

McKinlay Shire Council has received funding to complete the above mentioned project. This funding is only available until 30<sup>th</sup> June 2021.



## 4 Project Scope

The Contract is a Design and Construct Contract and the Contractor will be responsible for the design, supply and construction/installation of a new residence in Julia Creek. The house is to be a kit or modular house and should be compliant with all relevant Australian Standards and the National Construction Code (NCC).

The scope of works for the project includes:

- Project management and administration
- Development of preliminary drawings
- Management of sub-contractor/s
- Supply of all Equipment and Plant required to complete the whole of works
- Site establishment and disestablishment
- Liaison with MAL Engineers and McKinlay Shire Council
- Design and construction of a new kit or modular house which complies with the requirements of the Performance Specification nominated in this Tender Document.
- Structural Certification for both the design (Form 15) and construction (Form 16)
- Obtaining both building approval and Council approval for the structure (note Council will fast-track approvals).
- Installation of all components to complete the whole of works
- Material testing as required
- Other minor works as required to complete the whole of works
- Quality Assurance testing and documentation

Out of scope

- The land is owned by Council, Council will provide power, water and sewer connections.

## 5 Project Program

The Practical Completion date specified in the project Annexure – Part A is 25<sup>th</sup> June 2021. It is understood the deadline for this project relates to funding that must be used by 30<sup>th</sup> June 2021. The tenders received had the following practical completion dates:

- Asset Homes and Cabins Pty Ltd Conforming (130m<sup>2</sup>): Practical Completion 14<sup>th</sup> September 2021
- Asset Homes and Cabins Pty Ltd Non-conforming (104m<sup>2</sup>): Practical Completion 16<sup>th</sup> June 2021

## 6 Tender Phase

A Request for Tender was uploaded on the Tenderlink Portal on 19<sup>th</sup> March 2021.

No Addenda were issued during the tender period.

## 7 Tender Evaluation Criteria

The evaluation criteria and their weighting is provided below:

1. Local Content (5%)
2. Capacity (10%)
3. Scheduling (10%)
4. Design Requirements (15%)
5. Price (60%)

## 8 Tender Submissions

The Tenders were due to be submitted to electronically on the 12<sup>th</sup> April by 5:00pm.

Only one (1) tenderer submitted for the project, with the tenderer being *Asset Cabins and Homes Pty Ltd*. Their response included both a conforming and non-conforming tender. The conforming tender (130m<sup>2</sup> total floor area) has a nominated practical completion date of 14<sup>th</sup> September 2021. The non-conforming tender includes



the provision of an already constructed ex-display home with a total floor area of 104m<sup>2</sup>. The non-conforming tender has a nominated practical completion date of 16<sup>th</sup> June 2021.

## 9 Tender Evaluation

Tender Evaluation was conducted on Tuesday 13<sup>th</sup> March 2021, with members of the Tender Evaluation comprising of Amanda Maddocks (MAL Engineers) and Michael Lancini (MAL Engineers).

Lump sum tender prices submitted by Asset Cabins and Homes Pty Ltd are as follows:

- Conforming (130m<sup>2</sup>): \$336,000 (GST Excl.)
- Non Conforming (104m<sup>2</sup>): \$315,000 (GST Excl.)

As there was only one Tenderer the evaluation was not possible as there was no comparison between tenderers to be made. The Tender received was checked for non-compliances.

Based on the timeframes and cost of each project, the non-conforming tender is the preferred option. This option is for the provision of an already constructed ex-display home, avoiding lengthy delays associated with the construction of a new modular home. Table 1 below provides a comparison of the two options provided by the Tenderer.

**Table 1: Comparison of Conforming and Non-conforming options**

Component	Proposed Product Details - Conforming (130m <sup>2</sup> , handover September 2021)	Proposed Product Details - Non Conforming (104m <sup>2</sup> , handover June 2021)
<b>Building size (m2)</b>	130	104
<b>Living Room Size (m2)</b>	24.4	20
<b>External Deck size (m2)</b>	39	34.56
<b>Bedroom 1 size (m2)</b>	15.4	12
<b>Bedroom 2 size (m2)</b>	13.86	10.35
<b>Bedroom 3 size (m2)</b>	12	7.5
<b>Internal Wall Lining</b>	Gyprock to all areas except bathrooms - Villaboard to bathrooms	Gyprock to all areas except bathrooms - Villaboard to Bathrooms
<b>External Wall cladding</b>	Weathertex Millwood Smooth Cladding - Painted	Weathertex Millwood Smooth Cladding - Painted
<b>Roof cladding</b>	Colorbond Customorb	Colorbond customorb
<b>Fascias and Gutters</b>	Colorbond	Colorbond
<b>Flooring</b>	Carpet to bedrooms - ceramic tiles to living, kitchen, dining and wet areas	Carpet to bedrooms - ceramic tiles to living, kitchen, dining and wet areas
<b>Structure Framing Type (timber, steel ,etc)</b>	Steel floor structure and treated pine wall frames	Steel floor structure and treated pine wall frames
<b>Subfloor structure</b>	Concrete footings and steel stumps	Concrete footings and steel stumps
<b>Tapware</b>	Flickmixer type - Modella brand	Flickmixer type - Mondella Brand
<b>Toilet</b>	Harmony Nardini	Harmony Nardini
<b>Showers</b>	Fully tiled - walk in type to ensuite - screened to bathroom	Full tiled - walk-in type to ensuite - screened to bathroom
<b>Door Schedule</b>	As per plan	As per plan
<b>Window Schedule</b>	As per plan	As per plan
<b>Joinery</b>	Gloss painted bevel skirting and architraves	Gloss painted bevel skirting and architraves
<b>Glazing</b>	Bradnam's standard range	Bradnam's standard range
<b>Lights</b>	LED Downlights throughout	LED Downlights throughout
<b>Fans</b>	As per variations	As per variations



Component	Proposed Product Details - Conforming (130m2, handover September 2021)	Proposed Product Details - Non Conforming (104m2, handover June 2021)
GPO's	As specified in Projecct Design Specification - Clipsal Brand	As specified in Project Design Specification - Clipsal Brand
Kitchen (Stove Top, Sinks, etc)	Ariton Brand - Italian Made	Ariton brand - Italian made
Any other items (Tenderer to List)	Plan and Project Design spec attached	Plan and Project Design Sepc attached

Refer to Appendix B for the conforming and non-conforming tender floor plans.

## 10 Exclusions

Both the non-conforming and conforming tenders had a number of exclusions. Items of note include the following:

- No fans included
- Only two air conditioners (one to living area, one to master bedroom) included rather than proposed four air conditioners (one to all bedrooms and the living room)
- Hydraulics drawings if required by council for plumbing application

A rate for the above exclusions (among others) has been provided by the Tenderer. A full list of exclusions is provided in Appendix C.

## 11 Post Tender Clarification

A Post-tender clarification email was sent to Asset Homes and Cabins Pty Ltd as preferred Tenderer. The clarification was used to:

- Confirm possibility of relocating the steps to the opposite site of veranda
- Confirm inclusion of the following items in Tenderers Lump Sum:
  - Payment of Building and Plumbing approval fees through a Building Certifier
  - Q-Leavy Levy Payment
  - Soil investigation and report

Refer to Appendix C for Post Tender Clarification correspondence.

## 12 Recommendation

MAL Engineers recommend Asset Homes and Cabins Pty Ltd' non conforming (104m<sup>2</sup> total floor area) tender for the *McKinlay Shire Council Design and Construction of a Modular/Kit Home Project at Julia Creek*. The Request for Tender was advertised on the Tender Portal website, only one contractor tendered on the project. The location of the project, short timeframe and capacity of other Contractors is understood to be the reason why only one Contractor submitted a Tender.

Yours faithfully

*Michael Lancini*  
Director  
for MAL Engineers Pty Ltd

Attached:

- Link to Asset Cabins and Homes Tender Submission
- Floor plans
- Exclusions
- Clarification Letter/Email



## **APPENDIX A: Asset Homes and Cabins Tender Submission**

<https://1drv.ms/u/s!AsR86gN8qvb8g-JpTNCxPooBijLS4w?e=nXxdSi>





## **Appendix B: Floor Plans (Conforming and Non – Conforming)**

# Flexible Designs for Professional Solutions



© Copyright reserved



## Proposed Residence for MCKINLAY SHIRE COUNCIL 6/04/2021

RENDERED IMAGES ARE FOR VISUALISATION GUIDE ONLY  
RENDERINGS ARE NOT TO BE TAKEN AS EXACT REPRESENTATION OF FINISHES & MAY NOT REFLECT FLOOR PLAN, INCLUSIONS OR COLOUR SELECTION.

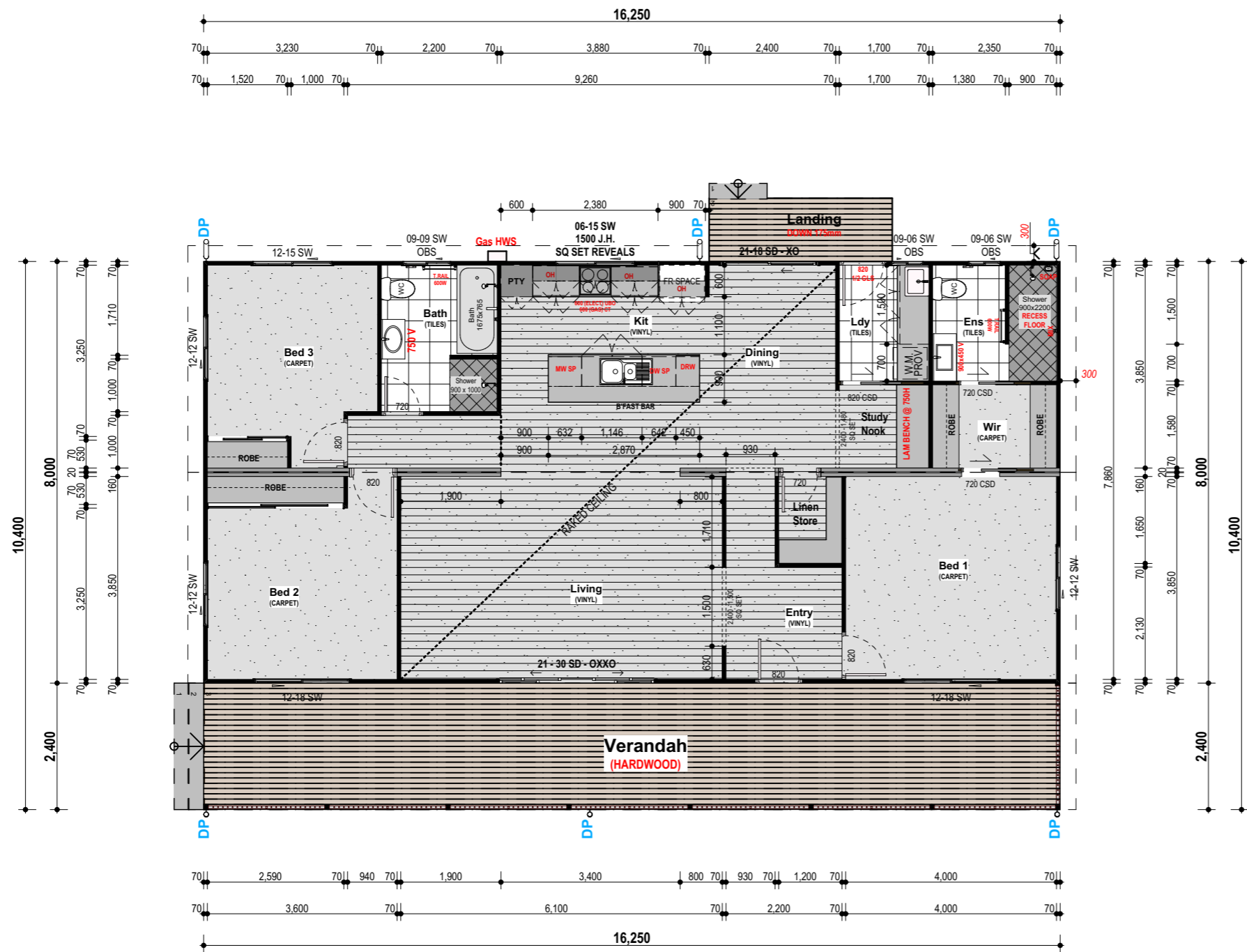

**FLOOR PLAN**

**1:100**



**KITCHEN VIEW**



**KITCHEN VIEW**

**2400 C.H.**  
**(OPTIONAL)**  
**SUB FLOOR SKIRTING SHOWN**

FLOOR AREAS	
NAME	AREA (m <sup>2</sup> )
MAIN BUILDING	130.00
VERANDAH	39.00
	<b>169.00 m<sup>2</sup></b>



**ELEVATION DIRECTION**

Client Signature: <i>(Plan Approval)</i>		
<b>Floor Plan</b>		
Project No: <b>A4978</b>	Cabin No: .	site classification: .
design by: Asset Cabins and Homes		Drawn: AJH
scale: 1:100, 1:1, 1:1000, 1:5 at A3		date: 6/04/2021
design: <b>WINDSOR (MOD)</b>	sheet no: <b>2</b>	revision: <b>A</b>

**asset** CABINS & HOMES

DESIGN | EXPERIENCE | SOLUTIONS

FREECALL 1800 225 224  
T 07 5483 7144 F 07 5483 7188  
E sales@assetcabins.com.au  
Cnr Langton Road and Ettie Jane Street Gympie Qld 4570  
www.assetcabins.com.au  
ACN 143 938 952

These drawings are protected by copyright and remain the property of Asset Cabins and Homes Pty Ltd. They may not be reproduced or copied without permission of Asset Cabins and Homes Pty Ltd.

All site dimensions are to be verified and confirmed by the client prior to the commencement of works.

Version Notes:

**CONCEPT**

6/04/2021

107

Client: **MCKINLAY SHIRE COUNCIL**

Project: **Proposed Residence**

**JULIA CREEK QLD 4823**

drawing status: CONCEPT

FLOOR AREAS	
NAME	AREA (m <sup>2</sup> )
MAIN BUILDING	103.68
OPTIONAL VERANDAH	34.56
	<b>138.24 m<sup>2</sup></b>

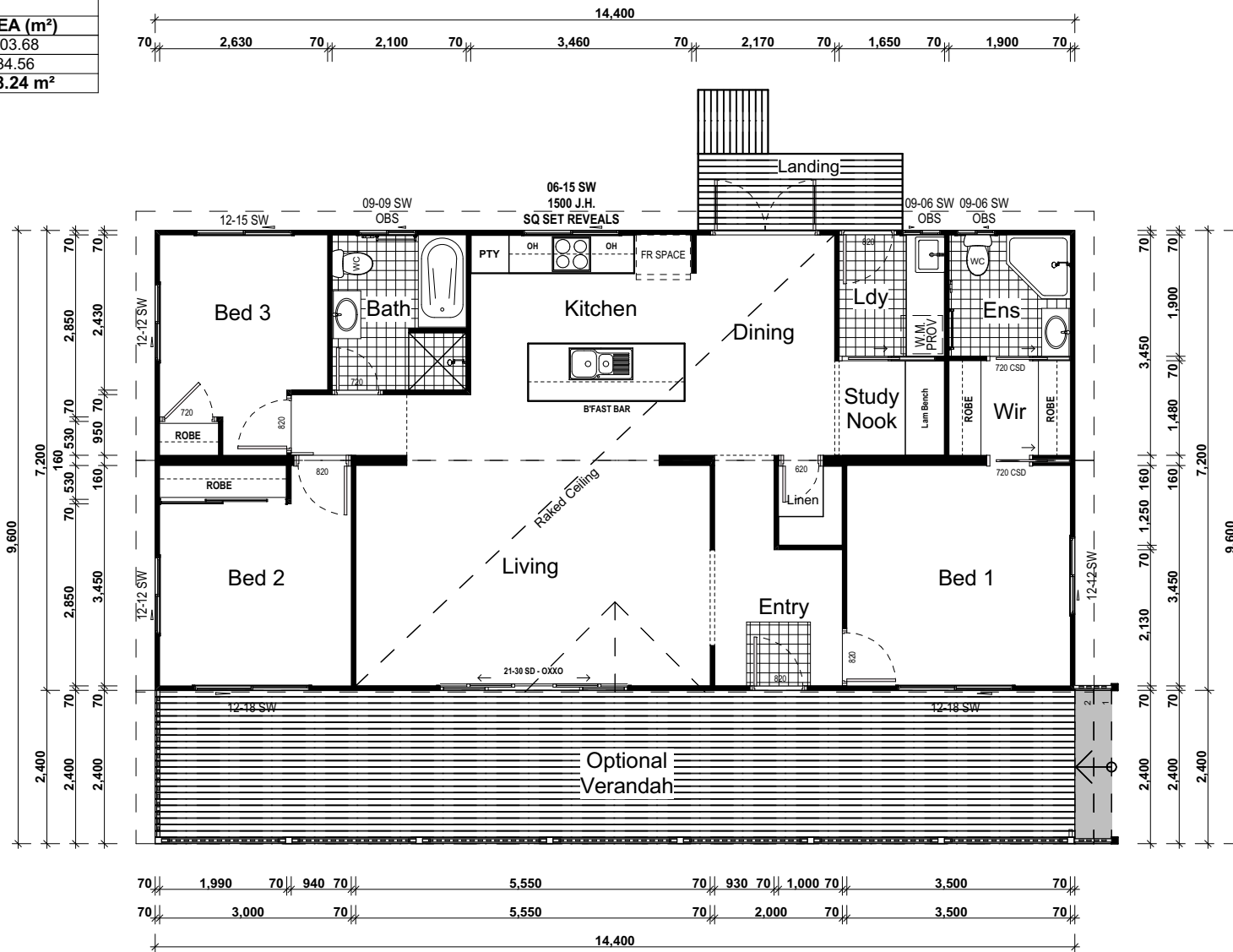

# Windsor (7.20m wide)

Total Area 138.24 sq.m

Revision date: 7/05/2020



**Freecall 1800 225 224**  
 Cnr. Langton Road & Ettie Jane Road,  
 Gympie Queensland 4570  
 Phone 07 5483 7144  
 Fax 07 5483 7188



## **Appendix C: Non-Conforming Tender Exclusions and MSC Responsibilities**



**Exclusions:**

- Air-conditioning to Bedroom 2 and 3
- Ceiling fans
- Awnings to windows
- Furniture and free-standing appliances
- Additional shelves under main shelf to robes
- Sub-floor skirting
- Disabled design features to all or part of home
- Rock excavation to footings
- Removal of footing hole spoil from site. Spoil to be spread out under building footprint or placed in one pile beside the building
- Landscaping/pathways/paved areas
- Hydraulics drawings if required by council for plumbing application
- Bushfire Attack Level (BAL) site classification and report if required
- Soil testing and design work for effluent disposal system if required
- Certifier/Council approval fees, PLSL Levy, Town Planning fees
- Connection to external electric, plumbing, gas and TV services
- Surveyor fees if required by certifier
- External water tanks if required (downpipes to floor level only)

**Your Responsibilities Include:**

- Payment of Building and Plumbing Approval Fees through a building Certifier
- Q-Leave levy payment
- Soil testing/design work for effluent disposal report if your site is not sewerred. See separate quote for your acceptance
- Connection of all external services i.e. plumbing, electrical, gas, air-conditioner compressor units, and TV aerial – these will need to be arranged for yourself and the relevant trades
- Arrange on site electrician to connect building modules together. There are J Boxes in the roof space close to the manhole and are labelled of your reference
- Liaison with your Electricity provider to arrange for meter supply and connection
- Supply of bracket for overhead power connection if required
- Advising Asset Cabins & Homes' installation team of underground services locations. If this is not possible, an additional amount for vacuum excavation will be incurred, or you accept responsibility for repairs for any damage to underground services caused by conventional excavation.



## **Appendix D: Post Tender Clarifications**



Q21044-01  
13 April 2021

10



**From:** Amanda Maddocks <amanda.maddocks@malengineers.com.au>  
**Sent:** Tuesday, 13 April 2021 1:56 PM  
**To:** 'Simon Menzies' <simon@assetcabins.com.au>  
**Cc:** 'Michael Lancini' <michael.lancini@malengineers.com.au>  
**Subject:** MSC Julia Creek Modular Home - Post Tender Clarification

Hi Simon

Can you please confirm relocation of the external stairs (as per the attached) on the non-conforming tender is possible. If so, please advise of any additional costs.

I also note in your lump sum schedule you have not allocated a cost to the following line items:

- Soil investigation and report
- Council approvals

Please confirm these are included in your lump sum price of \$315,000 (non-conforming tender).

I note in the preliminaries section of the non-conforming tender it states:

- Payment of Building and Plumbing approval Fees through a building certifier
- Soil testing for building classification
- Q-Leave levy Payment

However in the "Your Responsibilities" section it states:

- Payment of Building and Plumbing Approval Fees through a Building Certifier
- Q-Leave levy payment

Kind regards,

**Amanda Maddocks**  
ENGINEER  
MAL ENGINEERS



Phone +81 400141407

Email: [amanda.maddocks@malengineers.com.au](mailto:amanda.maddocks@malengineers.com.au)

Address: Unit 2/112 Mulgrave Road, Cairns, QLD, 4870



Simon Menzies <simon@assetcabins.com.au>

To: Amanda Maddocks

Cc: 'Michael Lancini'

Click here to download pictures. To help protect your privacy, Outlook prevented automatic download of some pictures in this message.

Reply Reply All Forward ...  
Tue 13/04/2021 2:12 PM

Hello Amanda,

My apologies for the confusion.

As per your email below.

1. Steps can be relocated as required on the non-conforming tender at no additional cost.
2. Costs for Soil investigation and report for site classification and council approvals are included in the lump sum amount of \$315000 + GST – I do note that the council said they would allow for "Fast track" of approvals, however I have not allowed for any additional fast track fees that may normally be imposed.
3. Please delete from "Your responsibilities include" section
  - Payment of Building and Plumbing Approval Fees through a Building Certifier
  - Q-Leave levy payment
 This is normally an exclusion and I omitted deleting it when preparing your paperwork.

Sorry, I have been away for the past week on annual leave and completed the tender submission in between travelling so was a bit difficult to get my head in the right space 😊.

Have a great day!

Kind Regards,

**Simon Menzies** Sales Manager

Freecall 1800 225 224 T: 07 5483 7144 ACN: 143 938 952  
 A: 11 Langton Road, Gympie Qld 4570 W: [www.assetcabins.com.au](http://www.assetcabins.com.au)



This email message and any attachments contain information that is CONFIDENTIAL and may be LEGALLY PRIVILEGED. If you are not the intended recipient, any use, disclosure or copying of this message or attachments is strictly prohibited. If you have received this email message in error please notify us immediately and erase all copies of the message and attachments.





Special Meeting of Council Tuesday, 15<sup>th</sup> April 2021

## 5. CLOSE